

Amendment 9

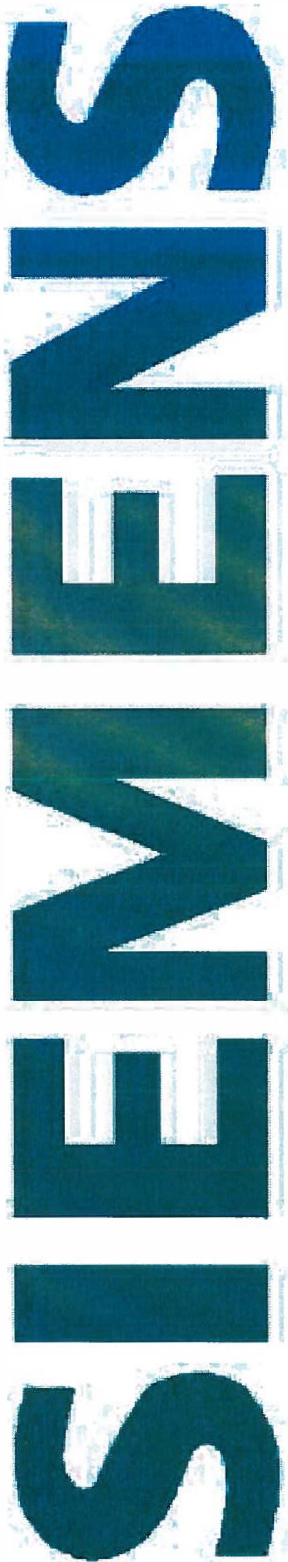

Snohomish County

South District Court Security Expansion

**System Type(s):
- Access Control -**

**Siemens Industry, Inc.
Building Technologies Security Division**
15900 SE Eastgate Way, Ste.200
Bellevue, WA 98008

Presented by:
Paul Pritchard
Paul.pritchard@siemens.com
425-281-9968

Siemens Industry, Inc.

Date: 10 OCT 2019

To: Lolly Huggins – Snohomish County

RE: South District Court (SDC) - SiPass Access Control Expansion

Siemens Industry, Inc. is pleased to provide the following quotation for the above referenced project. This quote is based on Site Surveys completed by Paul Pritchard (Siemens), Lolly Huggins and Lonnie Enyeart (Snohomish County) All Snohomish County standard and specifications have been acknowledged.

FINANCIAL SUMMARY

Base Project - Card Reader Addition (Door #1)	\$ 7,300.00
OPTION Card Reader Addition (Door #2)	<u>\$ 5,700.00</u>
Total Investment:	\$13,000.00

SITUATION

Snohomish County has requested Siemens to assist with an expansion of the SiPass Access Control system at the South District Court. This expansion will add up-to two (2) additional card readers to the current system. Each new card reader door will receive a card reader and electrified locking hardware. Door position switches and Request-to-Exit devices are excluded from this project; However, Siemens will include necessary cabling for future use of these devices. Siemens will utilize existing spare card reader inputs and licensing on the existing SiPass access panels. New card readers will connect to the spare reader inputs on the existing SiPass Access control panels.

SCOPE OF WORK

- Provide labor and materials for an expansion of existing SiPass card access system at the South District Court building.
- Install one (1) new card reader and electric strike to Department 4 Judge Chamber door. Access door peripherals include: Cabling, card reader, and electric strike.
- Include one (1) *optional* new card reader and electric strike to Department 1 Judge Chamber door. Access door peripherals include: Cabling, card reader, and electric strike.
- Modify existing SDC security drawings to include new access door(s) information.
- Setup and commission system to communicate with existing Snohomish County SiPass system.

**Snohomish County SDC Building
Siemens Security / Snohomish County**

Siemens Industry, Inc.

BILL OF MATERIALS

- Door #1 - Department 4 Judge Chamber
 - (1) HID MultiClass Card Reader *Black*
 - (1) Hess Electric Strike 24VDC
 - (re-use) Existing Spare SiPass card reader input
- Door #2 - Department 1 Judge Chamber
 - (1) HID MultiClass Card Reader *Black*
 - (1) Hess Electric Strike 24VDC
 - (re-use) Existing Spare SiPass card reader input
- SiPass Equipment
 - Provide (2) Card Reader license expansion
 - (re-use) Existing Spare SiPass card reader input
- Panduit/Cabling
 - All security cabling to be plenum and concealed with exception to locations that must be surface mounted due to concrete/brick structure. Panduit will only be used as needed, with respect to the building cosmetic requirements.

CLARIFICATIONS

1. Turnkey Installation = System components, system design, engineering services, field technician startup, system testing and commissioning.
2. ACAD drawings: Siemens will update original engineered project drawing set as applicable for this project. It is assumed Siemens will continue drawings from last known revision. Drawings will follow current drawing format as specified by Snohomish County.
3. Siemens has planned to use spare card reader inputs available on the existing SiPass access control panels. Snohomish was unable to gain access to security panels during site survey to confirm spare input availability. If spare card reader inputs are not available during installation, Siemens will work with Snohomish County to resolve and additional cost will apply.
4. All Siemens proposed SiPass panels will be wired specifically to Snohomish County standards. Including individual cable labeling and specific wire termination connectors.
5. Weekly progress meetings are included in project pricing.
6. Pricing includes project management for the duration of the tentative project schedule.
7. Pricing includes one (1) year warranty
8. *Day Shift* Work is assumed to be completed during normal business hours Monday – Friday (6am-5pm). *Night Shift* work is assumed to be completed during off business hours Monday – Friday (6pm-2am). If night shift is required, additional cost will apply.
9. Prevailing wage rates are included in proposal price.
10. Siemens to provide electrical permit and coordinate inspection with AHJ.

**Snohomish County SDC Building
Siemens Security / Snohomish County**

Siemens Industry, Inc.

EXCLUSIONS

1. Door Closers for new access control doors. If required, Siemens will assist to provide the solutions and additional cost will apply.
2. Cutting, painting and patching.
3. Asbestos abatement or containment
4. Fire Alarm system interface, if required.
5. Provide by others = Network connectivity and identification of appropriate 120VAC circuit(s).
6. Performance or Payment bonds.
7. Costs associated with schedule acceleration, project meetings, multiple trips onsite due to incompleteness of others, or multiple unplanned phases.
8. Washington State Sales Tax.

This proposal is based on the Siemens Industry, Inc. Standard Terms and Conditions and the "Scope of work" and is to be considered part of this proposal. Proposal is valid for thirty (30) days from the delivery date. Payment is due within 30 days of invoice date.

Payment Terms: 5% mobilization in advance, progress payments, NET30

Please contact me immediately if you have any questions or concerns regarding this proposal. If this proposal is acceptable, please return a signed copy to our office via mail or fax. **This will serve as our notice to proceed with the work described herein.**

Proposal accepted by:

Name: Ken Klein
Company: Snohomish County
Title: Executive Director



Signature **Date** 05/01/2020

Proposal submitted by:

Paul Pritchard
Sales Executive
Siemens Industry, Inc.



Signature **Date** 10/10/2019

Snohomish County SDC Building
Siemens Security / Snohomish County

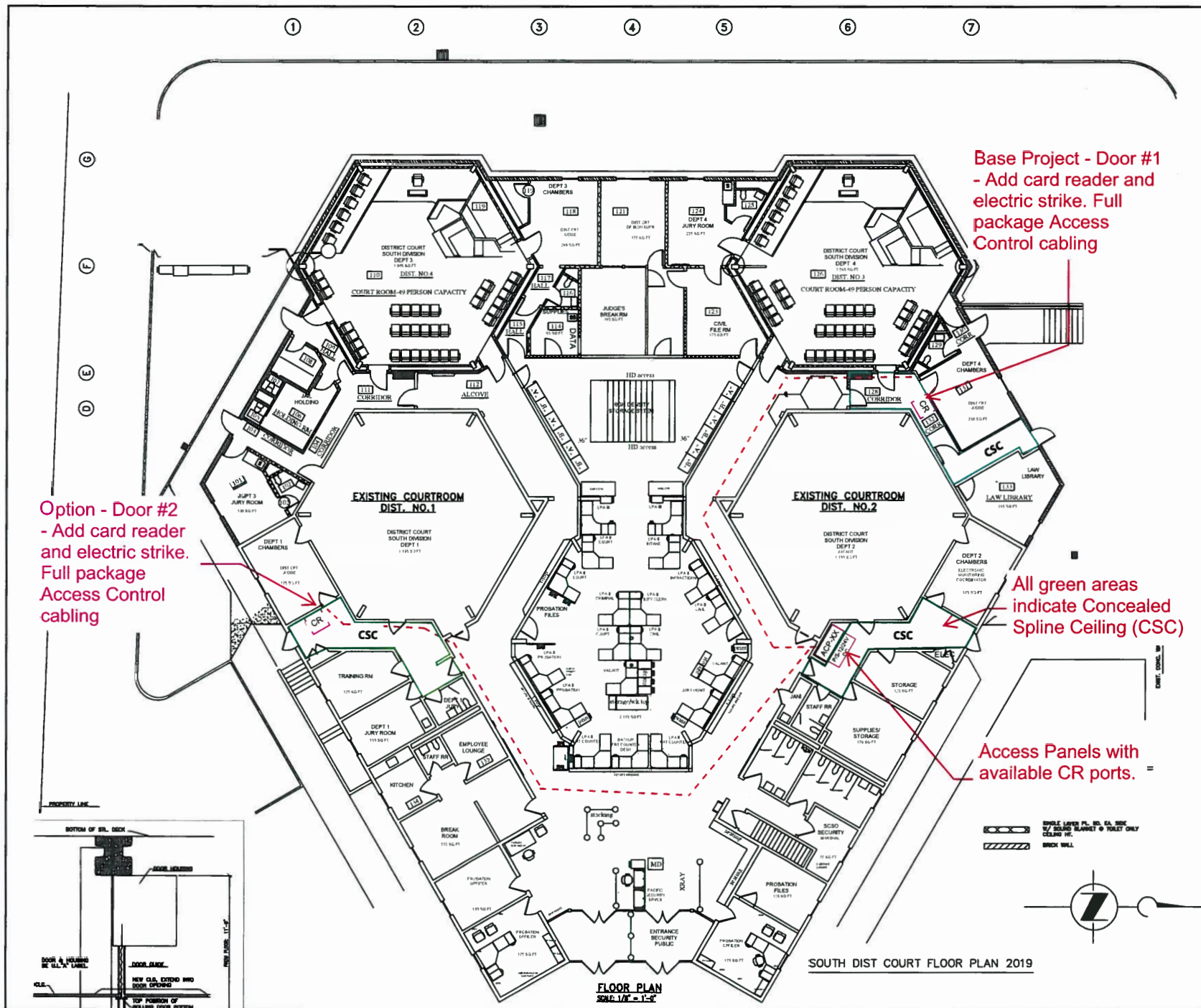

Siemens Industry, Inc.

Date: 05 MAR 2020

To: Lolly Huggins – Snohomish County

RE: Snohomish District Court – CASCADE DIVISION
SiPass Access Control Expansion

Siemens Industry, Inc. is pleased to provide the following quotation for the above referenced project. This quote is based on Site Surveys completed by Paul Pritchard (Siemens), Lolly Huggins and Lonnie Enyeart (Snohomish County) All Snohomish County standard and specifications have been acknowledged.

FINANCIAL SUMMARY

Total Investment: \$14,580.00

SITUATION

Snohomish County has requested Siemens to assist with an expansion of the SiPass Access Control system at the CASCADE District Court, located in Arlington. This expansion will add three (3) additional card readers to the current system. Each new card reader door will receive a card reader, Request-to-Exit Sensor, Door Sensor, and electrified locking hardware. Siemens will supply applicable access control expansion boards and licensing to expand the existing SiPass access panels.

SCOPE OF WORK

- Provide labor and materials for an expansion of existing SiPass card access system at the Cascade Division District Court
- Install one (1) new card reader to Judge Chamber #1 door leading to courtroom. Access door peripherals include: Cabling, card reader, REX, Door Sensor and electric strike.
- Install one (1) new card reader to Judge Chamber #2 door leading to the courtroom. Access door peripherals include: Cabling, card reader, REX, Door Sensor and electric strike.
- Install one (1) new card reader to Jury Room #1 door leading to the courtroom. Access door peripherals include: Cabling, card reader, REX, Door Sensor and electric strike.
- Expand existing access control panels to accommodate three (3) additional card readers.
- Modify existing SDC security drawings to include new access door(s) information.
- Setup and commission system to communicate with existing Snohomish County SiPass system.

Confidential

**Snohomish County District Court
Siemens Security / Snohomish County**

Siemens Industry, Inc.

BILL OF MATERIALS

Chambers 1

- Door #1 - Judge Chamber #1 (to Courtroom) **\$4,860.00**
 - (1) HID MultiClass Card Reader *Black Mullion Mount*
 - (1) Detection Systems Request-to-Exit Sensor
 - (1) Door Sensor *Brown Surface Mount*
 - (1) Electric Strike 24VDC
 - (1) SiPass card reader Expansion Board & Licensing
 - (lot) Cable/Wire, connectors
- Door #2 – Jury Room #1 (to Courtroom) **\$4,860.00**
 - (1) HID MultiClass Card Reader *Black Mullion Mount*
 - (1) Detection Systems Request-to-Exit Sensor
 - (1) Door Sensor *Brown Surface Mount*
 - (1) Electric Strike 24VDC
 - (1) SiPass card reader Expansion Board & Licensing
 - (lot) Cable/Wire, connectors
- Panduit/Cabling (both doors)
 - All security cabling to be concealed with exception to locations that must be surface mounted due to concrete/brick structure. Panduit will only be used as needed, with respect to the building cosmetic requirements.

Chambers 2

- Door #1 - Judge Chamber #2 (to Courtroom) **\$4,860.00**
 - (1) HID MultiClass Card Reader *Black Mullion Mount*
 - (1) Detection Systems Request-to-Exit Sensor
 - (1) Door Sensor *Brown Surface Mount*
 - (1) Electric Strike 24VDC
 - (1) SiPass card reader Expansion Board & Licensing
 - (lot) Cable/Wire, connectors
- Panduit/Cabling
 - All security cabling to be concealed with exception to locations that must be surface mounted due to concrete/brick structure. Panduit will only be used as needed, with respect to the building cosmetic requirements.

Confidential

**Snohomish County District Court
Siemens Security / Snohomish County**

Siemens Industry, Inc.

CLARIFICATIONS

1. Turnkey Installation = System components, system design, engineering services, field technician startup, system testing and commissioning.
2. ACAD drawings: Siemens will update original engineered project drawing set as applicable for this project. It is assumed Siemens will continue drawings from last known revision. Drawings will follow current drawing format as specified by Snohomish County.
3. All Siemens proposed SiPass panels will be wired specifically to Snohomish County standards. Including individual cable labeling and specific wire termination connectors.
4. Weekly progress meetings are included in project pricing.
5. Pricing includes project management for the duration of the tentative project schedule.
6. Pricing includes one (1) year warranty
7. *Day Shift* Work is assumed to be completed during normal business hours Monday – Friday (6am-5pm). *Night Shift* work is assumed to be completed during off business hours Monday – Friday (6pm-2am). If night shift is required, additional cost will apply.
8. Prevailing wage rates are included.
9. Siemens to provide electrical permit and coordinate inspection with AHJ.

EXCLUSIONS

1. Door Hardware and Door Closers for new access control doors. If required, Siemens will assist to provide the solutions and additional cost will apply.
2. Cutting, painting and patching.
3. Asbestos abatement or containment
4. Fire Alarm system interface, if required.
5. Performance or Payment bonds.
6. Costs associated with schedule acceleration, project meetings, multiple trips onsite due to incompletion of others, or multiple unplanned phases.
7. Washington State Sales Tax.

This proposal is based on the Siemens Industry, Inc. Standard Terms and Conditions and the "Scope of work" and is to be considered part of this proposal. Proposal is valid for thirty (30) days from the delivery date. Payment is due within 30 days of invoice date.

Payment Terms: 5% mobilization in advance, progress payments, NET30

Please contact me immediately if you have any questions or concerns regarding this proposal. If this proposal is acceptable, please return a signed copy to our office via mail or fax. **This will serve as our notice to proceed with the work described herein.**

Proposal accepted by:

Name: Ken Klein
Company: Snohomish County
Title: Executive Director



05/01/2020

Signature

Date

Proposal submitted by:

Paul Pritchard
Sales Executive
Siemens Industry, Inc.

Paul Pritchard 3/5/2020

Signature

Date

Confidential

**Snohomish County District Court
Siemens Security / Snohomish County**

Snohomish District Court – CASCADE DIVISION (ARLINGTON)

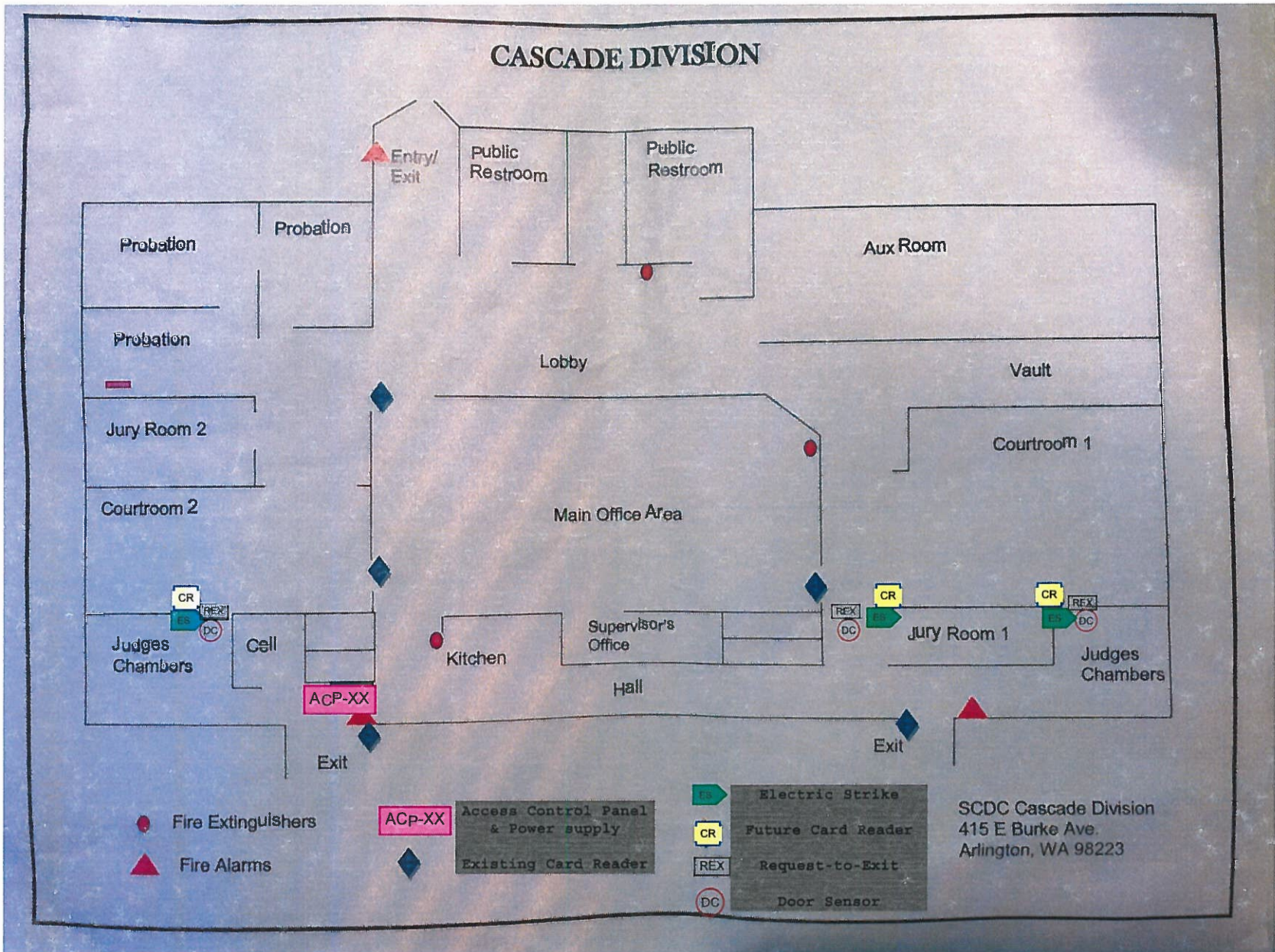

Confidential

Siemens Industry, Inc.

Date: 04 MAR 2020

To: Lolly Huggins – Snohomish County

**RE: Snohomish District Court – EVERGREEN DIVISION
SiPass Access Control Expansion**

Siemens Industry, Inc. is pleased to provide the following quotation for the above referenced project. This quote is based on **Site Surveys** completed by **Paul Pritchard (Siemens), Lolly Huggins and Lonnie Enyeart (Snohomish County)** All Snohomish County standard and specifications have been acknowledged.

FINANCIAL SUMMARY

Total Investment: \$14,580.00

SITUATION

Snohomish County has requested Siemens to assist with an expansion of the SiPass Access Control system at the EVERGREEN District Court, located in Monroe. This expansion will add three (3) additional card readers to the current system. Each new card reader door will receive a card reader, Request-to-Exit Sensor, Door Sensor, and electrified locking hardware. Siemens will supply applicable access control expansion boards and licensing to expand the existing SiPass access panels.

SCOPE OF WORK

- Provide labor and materials for an expansion of existing SiPass card access system at the EVERGREEN Division District Court
- Install one (1) new card reader to Judge Chamber #1 door leading to courtroom. Access door peripherals include: Cabling, card reader, REX, Door Sensor and electric strike.
- Install one (1) new card reader to Judge Chamber #2 door leading to the courtroom. Access door peripherals include: Cabling, card reader, REX, Door Sensor and electric strike.
- Install one (1) new card reader to Jury Room #1 door leading to the courtroom. Access door peripherals include: Cabling, card reader, REX, Door Sensor and electric strike.
- Expand existing access control panels to accommodate three (3) additional card readers.
- Modify existing SDC security drawings to include new access door(s) information.
- Setup and commission system to communicate with existing Snohomish County SiPass system.

Confidential

**Snohomish County District Court
Siemens Security / Snohomish County**

Siemens Industry, Inc.

BILL OF MATERIALS

Chambers 1

- Door #1 - Judge Chamber #1 (to Courtroom) **\$4,860.00**
 - (1) HID MultiClass Card Reader *Black Mullion Mount*
 - (1) Detection Systems Request-to-Exit Sensor
 - (1) Door Sensor *Brown Surface Mount*
 - (1) Electric Strike 24VDC
 - (1) SiPass card reader Expansion Board & Licensing
 - (lot) Cable/Wire, connectors
- Door #2 – Jury Room #1 (to Courtroom) **\$4,860.00**
 - (1) HID MultiClass Card Reader *Black Mullion Mount*
 - (1) Detection Systems Request-to-Exit Sensor
 - (1) Door Sensor *Brown Surface Mount*
 - (1) Electric Strike 24VDC
 - (1) SiPass card reader Expansion Board & Licensing
 - (lot) Cable/Wire, connectors
- Panduit/Cabling (both doors)
 - All security cabling to be concealed with exception to locations that must be surface mounted due to concrete/brick structure. Panduit will only be used as needed, with respect to the building cosmetic requirements.

Chambers 2

- Door #1 - Judge Chamber #2 (to Courtroom) **\$4,860.00**
 - (1) HID MultiClass Card Reader *Black Mullion Mount*
 - (1) Detection Systems Request-to-Exit Sensor
 - (1) Door Sensor *Brown Surface Mount*
 - (1) Electric Strike 24VDC
 - (1) SiPass card reader Expansion Board & Licensing
 - (lot) Cable/Wire, connectors
- Panduit/Cabling
 - All security cabling to be concealed with exception to locations that must be surface mounted due to concrete/brick structure. Panduit will only be used as needed, with respect to the building cosmetic requirements.

Confidential

**Snohomish County District Court
Siemens Security / Snohomish County**

Siemens Industry, Inc.

CLARIFICATIONS

1. Turnkey Installation = System components, system design, engineering services, field technician startup, system testing and commissioning.
2. ACAD drawings: Siemens will update original engineered project drawing set as applicable for this project. It is assumed Siemens will continue drawings from last known revision. Drawings will follow current drawing format as specified by Snohomish County.
3. All Siemens proposed SiPass panels will be wired specifically to Snohomish County standards. Including individual cable labeling and specific wire termination connectors.
4. Weekly progress meetings are included in project pricing.
5. Pricing includes project management for the duration of the tentative project schedule.
6. Pricing includes one (1) year warranty
7. *Day Shift* Work is assumed to be completed during normal business hours Monday – Friday (6am-5pm). *Night Shift* work is assumed to be completed during off business hours Monday – Friday (6pm-2am). If night shift is required, additional cost will apply.
8. Prevailing wage rates are included.
9. Siemens to provide electrical permit and coordinate inspection with AHJ.

EXCLUSIONS

1. Door Hardware and Door Closers for new access control doors. If required, Siemens will assist to provide the solutions and additional cost will apply.
2. Cutting, painting and patching.
3. Asbestos abatement or containment
4. Fire Alarm system interface, if required.
5. Performance or Payment bonds.
6. Costs associated with schedule acceleration, project meetings, multiple trips onsite due to incompletion of others, or multiple unplanned phases.
7. Washington State Sales Tax.

This proposal is based on the Siemens Industry, Inc. Standard Terms and Conditions and the "Scope of work" and is to be considered part of this proposal. Proposal is valid for thirty (30) days from the delivery date. Payment is due within 30 days of invoice date.

Payment Terms: 5% mobilization in advance, progress payments, NET30

Please contact me immediately if you have any questions or concerns regarding this proposal. If this proposal is acceptable, please return a signed copy to our office via mail or fax. **This will serve as our notice to proceed with the work described herein.**

Proposal accepted by:

Name: Ken Klein

Company: Snohomish County

Title: Executive Director



5/1/2020

Signature

Date

Proposal submitted by:

Paul Pritchard

Sales Executive

Siemens Industry, Inc.



3/4/2020

Signature

Date

Confidential

**Snohomish County District Court
Siemens Security / Snohomish County**

Snohomish District Court – EVERGREEN DIVISION

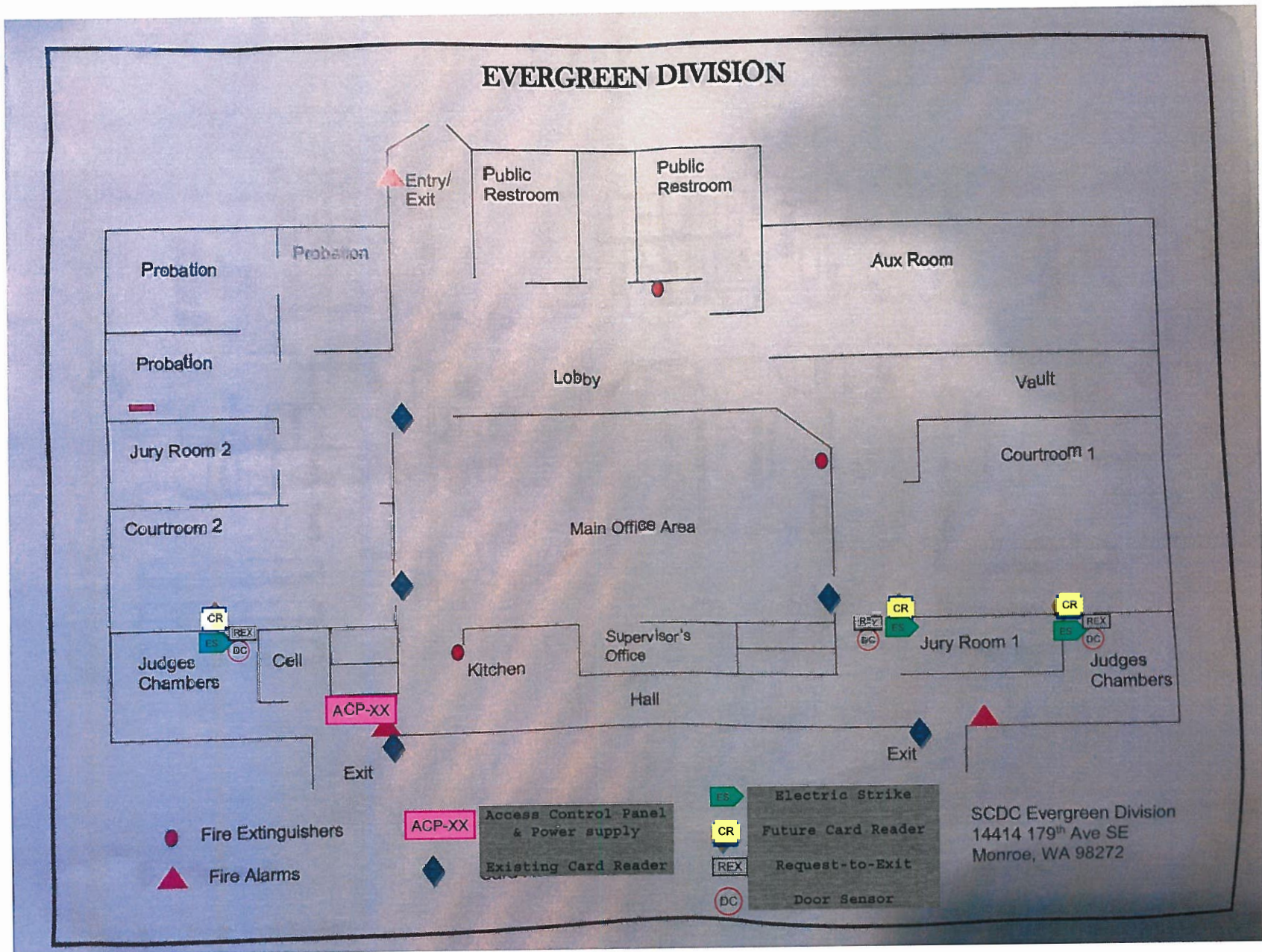

Confidential

Siemens Industry, Inc.

Date: 05 MAR 2020

To: Lolly Huggins – Snohomish County

RE: Snohomish District Court – EVERETT DIVISION
SiPass Access Control Expansion

Siemens Industry, Inc. is pleased to provide the following quotation for the above referenced project. This quote is based on Site Surveys completed by Paul Pritchard (Siemens), Lolly Huggins and Lonnie Enyeart (Snohomish County) All Snohomish County standard and specifications have been acknowledged.

FINANCIAL SUMMARY

Total Investment: \$31,380.00

SITUATION

Snohomish County has requested Siemens to assist with an expansion of the SiPass Access Control system at the EVERETT District Court, located in the Everett Courthouse. This expansion will add four (4) additional card readers to the current system. Each new card reader door will receive a card reader, Request-to-Exit Sensor, Door Sensor, and electrified locking hardware. Siemens will supply applicable access control expansion boards and licensing to expand the existing SiPass access panels.

SCOPE OF WORK

- Provide labor and materials for an expansion of existing SiPass card access system at the EVERETT Division District Court
- Install one (1) new card reader to Judge Chamber #1 door leading to courtroom. Access door peripherals include: Cabling, card reader, REX, Door Sensor and electric strike.
- Install one (1) new card reader to Jury Room #1 door leading to the courtroom. Access door peripherals include: Cabling, card reader, REX, Door Sensor and electric strike.
- Install one (1) new card reader to Judge Chamber #2 door leading to the courtroom. Access door peripherals include: Cabling, card reader, REX, Door Sensor and electric strike.
- Install one (1) new card reader to Jury Room #2 door leading to the courtroom. Access door peripherals include: Cabling, card reader, REX, Door Sensor and electric strike.
- Add access control expansion panel and power supply to accommodate four (4) additional card readers.
- Modify existing SDC security drawings to include new access door(s) information.
- Setup and commission system to communicate with existing Snohomish County SiPass system.

Confidential

**Snohomish County District Court
Siemens Security / Snohomish County**

Siemens Industry, Inc.

BILL OF MATERIALS

Panel Expansion \$ 14,000.00

- SiPass Expansion Panel (Locating in DATA/AV room)
 - (1) SiPass 19" enclosure
 - (1) SiPass 8-door reader interface
 - (1) SiPass 8-door expansion license
 - (1) LifeSafety Dual 12/24 Power supply (120VAC included)
 - (lot) Cable/Wire, connectors

Courtroom #1 \$8,690.00

- Door #1 - Judge Chamber #1 (to Courtroom)
 - (1) HID MultiClass Card Reader *Black*
 - (1) Detection Systems Request-to-Exit Sensor
 - (1) Door Sensor *Grey Surface Mount*
 - (1) Electric Strike 24VDC
 - (lot) Cable/Wire, Wiremold, connectors
- Door #2 – Jury Room #1 (to Courtroom)
 - (1) HID MultiClass Card Reader *Black*
 - (1) Detection Systems Request-to-Exit Sensor
 - (1) Door Sensor *Grey Surface Mount*
 - (1) Electric Strike 24VDC
 - (lot) Cable/Wire, connectors
- Panduit/Cabling (both doors)
 - All security cabling to be concealed with exception to locations that must be surface mounted due to non-accessible spline ceiling concrete/brick structure. Panduit will only be used as needed, with respect to the building cosmetic requirements.

Siemens Industry, Inc.

Courtroom #2 **\$8,690.00**

- Door #1 - Judge Chamber #2 (to Courtroom)
 - (1) HID MultiClass Card Reader *Black*
 - (1) Detection Systems Request-to-Exit Sensor
 - (1) Door Sensor *Grey Surface Mount*
 - (1) Electric Strike 24VDC
 - (lot) Cable/Wire, Wiremold, connectors

- Door #2 – Jury Room #2 (to Courtroom)
 - (1) HID MultiClass Card Reader *Black*
 - (1) Detection Systems Request-to-Exit Sensor
 - (1) Door Sensor *Grey Surface Mount*
 - (1) Electric Strike 24VDC
 - (lot) Cable/Wire, connectors

- Panduit/Cabling (both doors)
 - All security cabling to be concealed with exception to locations that must be surface mounted due to non-accessible spline ceiling concrete/brick structure. Panduit will only be used as needed, with respect to the building cosmetic requirements.

CLARIFICATIONS

1. Turnkey Installation = System components, system design, engineering services, field technician startup, system testing and commissioning.
2. ACAD drawings: Siemens will update original engineered project drawing set as applicable for this project. It is assumed Siemens will continue drawings from last known revision. Drawings will follow current drawing format as specified by Snohomish County.
3. All Siemens proposed SiPass panels will be wired specifically to Snohomish County standards. Including individual cable labeling and specific wire termination connectors.
4. Weekly progress meetings are included in project pricing.
5. Pricing includes project management for the duration of the tentative project schedule.
6. Pricing includes one (1) year warranty
7. *Day Shift* Work is assumed to be completed during normal business hours Monday – Friday (6am-5pm). *Night Shift* work is assumed to be completed during off business hours Monday – Friday (6pm-2am). If night shift is required, additional cost will apply.
8. Prevailing wage rates are included.
9. Siemens to provide electrical permit and coordinate inspection with AHJ.

Confidential

**Snohomish County District Court
Siemens Security / Snohomish County**

Siemens Industry, Inc.

EXCLUSIONS

1. Door Hardware and Door Closers for new access control doors. If required, Siemens will assist to provide the solutions and additional cost will apply.
2. Cutting, painting and patching.
3. Asbestos abatement or containment
4. Fire Alarm system interface, if required.
5. Performance or Payment bonds.
6. Costs associated with schedule acceleration, project meetings, multiple trips onsite due to incompleteness of others, or multiple unplanned phases.
7. Washington State Sales Tax.

This proposal is based on the Siemens Industry, Inc. Standard Terms and Conditions and the "Scope of work" and is to be considered part of this proposal. Proposal is valid for thirty (30) days from the delivery date. Payment is due within 30 days of invoice date.

Payment Terms: 5% mobilization in advance, progress payments, NET30

Please contact me immediately if you have any questions or concerns regarding this proposal. If this proposal is acceptable, please return a signed copy to our office via mail or fax. **This will serve as our notice to proceed with the work described herein.**

Proposal accepted by:

Name: Ken Klein

Company: Snohomish County

Title: Executive Director



05/01/2020

Signature

Date

Proposal submitted by:

Paul Pritchard

Sales Executive

Siemens Industry, Inc.



3/5/2020

Signature

Date

Confidential

**Snohomish County District Court
Siemens Security / Snohomish County**

Snohomish District Court – EVERETT DIVISION

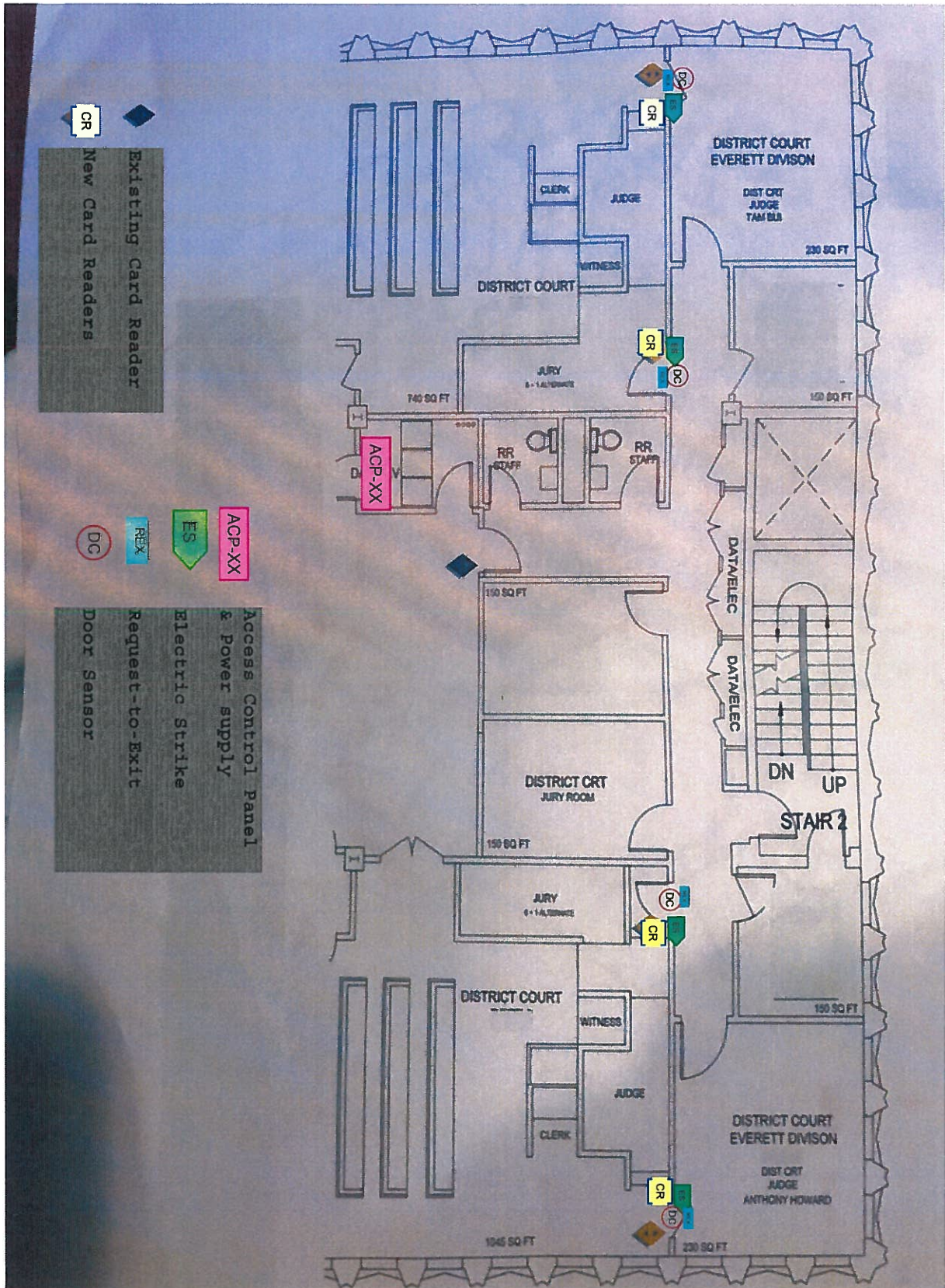

Confidential