

Return Address: Snohomish County
Parks and Recreation Division
6705 PUGET PARK DRIVE
SNOHOMISH, WA 98296

CRITICAL AREA SITE PLAN

Project #:	21118694-LDA
Applicant:	Snohomish County
Site Address:	15711 Marine Dr, Stanwood, WA 98292
Tax Acct. #:	310325-004-001-00
REFERENCE NUMBER(S) OF RELATED DOCUMENTS: 310336-001-001-00 1 of <u>2</u>	
GRANTOR(S) (OWNERS OF PROPERTY):	
<u>Snohomish County</u>	
LAST NAME	FIRST NAME MI
GRANTEE(S): SAME AS ABOVE:	

Legal Description:

Section 25 Township 31 Range 03 Quarter SE - S 18AC GOVT LOT 4 & 2ND CLASS TDLNS ADJ THRTO EXC CO RD R/W & ANY PART OF PLAT OF C. D. HILLMAN'S BIRMINGHAM WF ADD TO COE AT PORT SUSAN ON PUGET SOUND DIV 2 & EXC BAAP ON S SEC LN 368.78FT OF FRAC COR TH N 360FT TO PT DESIG AS "A" TH N 40FT TPB TH E 69.90FT TH SW TO PT 39.40FT E OF PT "A" TH W 39.40FT TO PT "A" TH TO PTN N02*12 00W 360FT FR PT ONSEC LN 370.20FT E OF FRAC COR TH W PLT S SEC LN 120FT M/L TO SHR PORT SUSAN BAY TH N THON TO PT W OF TPB TH E TO TPB & 2ND CLASS TDLNS ADJ THRTO TO SNO CO - N SALTWATER REGIONAL PK 1972 \$10.00 V651P399 REGIONAL PK



Additional legal description is on page ____ of document

In consideration of Snohomish County Code requirements, except as otherwise provided herein, the CAPA (Critical Area Protection Area) shall be left permanently undisturbed in a substantially natural state.
Exceptions: The following are allowed in CAPAs: Existing legally established uses and structures (see site plan); Non-ground disturbing interior or exterior building improvements; routine landscape maintenance of established, ornamental landscaping; non ground disturbing normal maintenance or repair; removal of noxious weeds conducted in accordance with chapter 16-750 WAC; maintenance or replacement that does not expand the affected area of the following existing facilities: (a) septic tanks and drainfields; (b) wells; (c) individual utility service connections; data collection by non-mechanical means, and non-mechanical survey and monument placement.

Applicant: Snohomish County
 Project #: 21118694-LDA
 Tax Acct. #: 310325-004-001-00

SITE PLAN:

2 OF 2

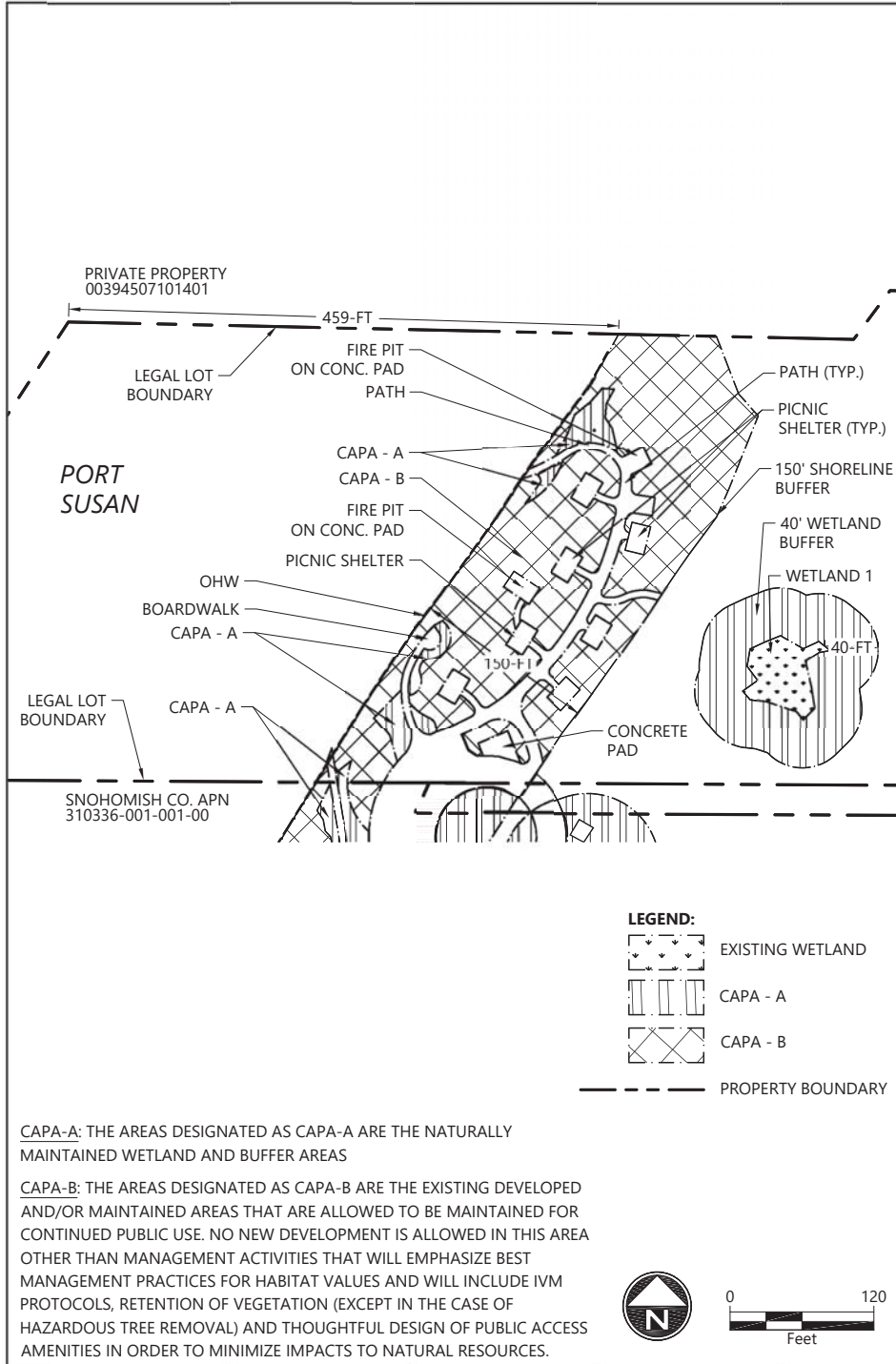

Representation on this site plan may be approximations only and should not be used for purposes other than for determining general locations of critical areas and buffers.

Erin Harker 07/05/2022 Lacey Harper Digitally signed by Lacey Harper
 APPROVED SNOCO PDS DATE OWNER(S) Date: 2022.08.18 09:07:08 -07'00' DATE