

SNOHOMISH COUNTY COUNCIL  
Snohomish County, Washington

MOTION NO. 25-539

APPROVING AND AUTHORIZING THE COUNTY EXECUTIVE  
TO EXECUTE CRITICAL AREA SITE PLANS

WHEREAS, in the 2025 CIP the Snohomish County Council approved construction of the Heybrook Ridge Erinswood Trail; and

WHEREAS, in order to construct the project, a Critical Area Report (June 2023) was prepared identifying critical areas, buffers and mitigation related to the project to comply with SCC Chapter 30.62A; and

WHEREAS, SCC Chapter 30.62A requires permanent identification and protection of Critical Area Protection Areas to be left permanently undisturbed in a substantially natural state; and

WHEREAS, a portion of the project property was chosen for habitat protection adjacent to the trailhead and trail development; and

WHEREAS, in order to permanently protect the property, Critical Area Site Plans are required to be approved by the Snohomish County Council and recorded with the Snohomish County Auditor;

NOW, THEREFORE, ON MOTION, the Snohomish County Council approves and authorizes the Snohomish County Executive to sign and execute the Critical Area Site Plans as attached hereto and incorporate by reference herein.

PASSED this 17<sup>th</sup> day of December, 2025.

SNOHOMISH COUNTY COUNCIL  
Snohomish County, Washington

  
\_\_\_\_\_  
Council Chair

ATTEST:

  
\_\_\_\_\_  
Deputy Clerk of the Council

Return Address:

CRITICAL AREA SITE PLAN

Project #: 25-106659 SHOR Applicant: Snohomish County, Parks & Recreation Division Site Address: 50606 Index-Galena Rd, Index, WA 98256 Tax Acct. #: 27102000200100		
REFERENCE NUMBER(S) OF RELATED DOCUMENTS:		1 of 2
GRANTOR(S) (OWNERS OF PROPERTY):		
Tom		
Teigen		
LAST NAME	FIRST NAME	MI
GRANTEE(S): SAME AS ABOVE:		

**Legal Description:**

SEC 20 TWP 27 RGE 10RT-7A-11A) THAT PTN GOVT LOT 2 LY SELY OLD PUGET SOUND - SKYKOMISH & EASTERN R/W

☐ Additional legal description is on page \_\_\_\_ of document

In consideration of Snohomish County Code requirements, except as otherwise provided herein, the CAPA (Critical Area Protection Area) shall be left permanently undisturbed in a substantially natural state.

**Exceptions:** The following are allowed in CAPAs: Existing legally established uses and structures (see site plan); Non-ground disturbing interior or exterior building improvements; routine landscape maintenance of established, ornamental landscaping; non ground disturbing normal maintenance or repair; removal of noxious weeds conducted in accordance with chapter 16-750 WAC; maintenance or replacement that does not expand the affected area of the following existing facilities: (a) septic tanks and drainfields; (b) wells; (c) individual utility service connections; data collection by non-mechanical means, and non-mechanical survey and monument placement.

Applicant: Snohomish County, Parks & Recreation Division  
Project #: 25-106659 SHOR  
Tax Acct. #: 27102000200100

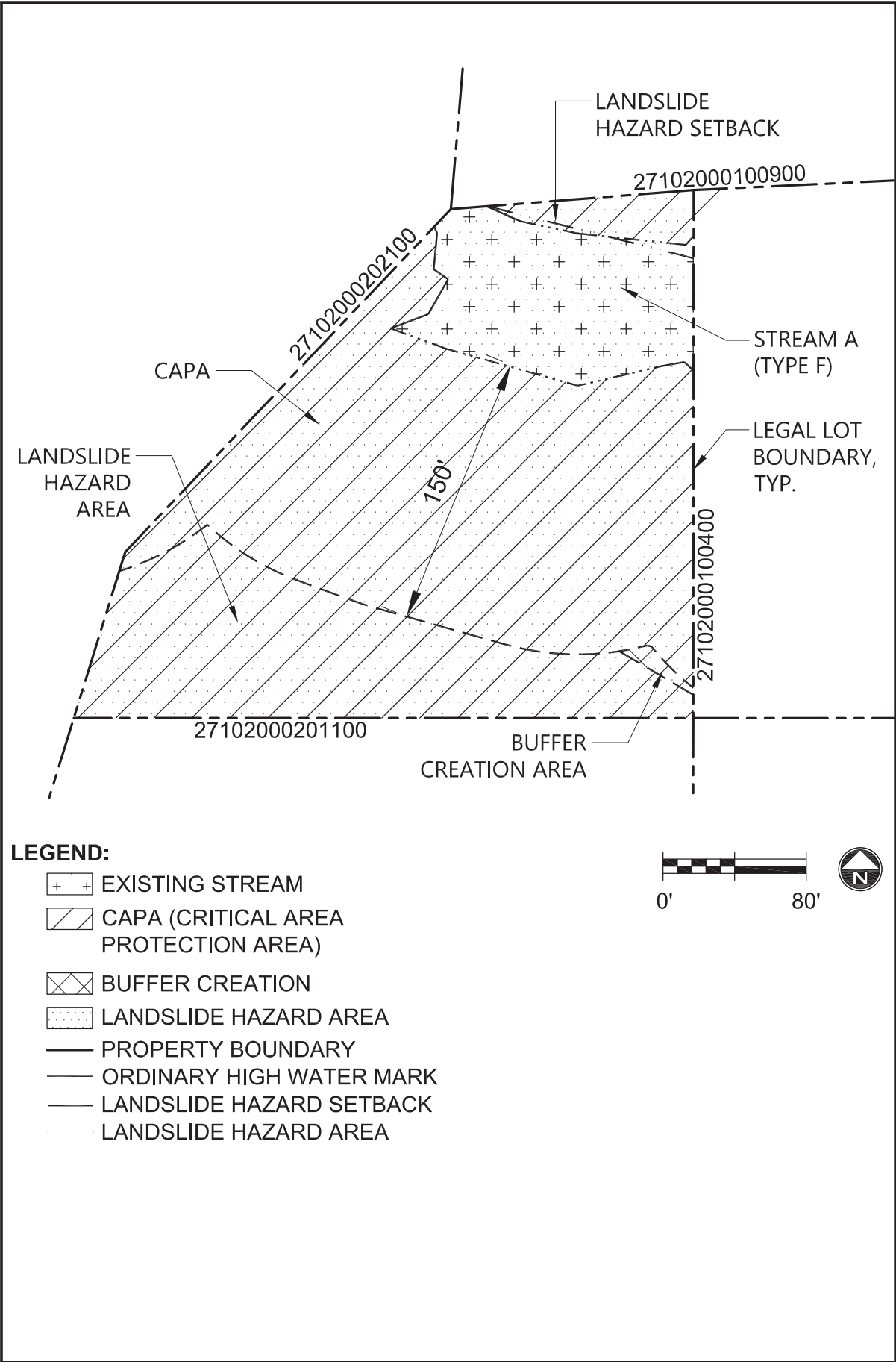

Representation on this site plan may be approximations only and should not be used for purposes other than for determining general locations of critical areas and buffers.

<u>Erin Harker</u>	<u>10/30/2025</u>	<u>Fong, Michael</u>	<u>Digitally signed by Fong, Michael Date: 2026.01.05 13:29:46 -08'00'</u>
APPROVED SNO CO PDS	DATE	OWNER(S)	DATE

Return Address:

CRITICAL AREA SITE PLAN

Project #: 25-106659 SHOR Applicant: Snohomish County, Parks & Recreation Division Site Address: 50606 Index-Galena Rd, Index, WA 98256 Tax Acct. #: 27102000202100		
REFERENCE NUMBER(S) OF RELATED DOCUMENTS:		1 of 2
GRANTOR(S) (OWNERS OF PROPERTY):		
Tom		
Teigen		
LAST NAME	FIRST NAME	MI
GRANTEE(S): SAME AS ABOVE:		

**Legal Description:**

Section 20 Township 27 Range 10 Quarter NW A PTN OF GOVT LOT 2 & SE1/4 NW1/4 20-27-10 LY WHN FDT - COM AT NE COR OF LOT 1 OF SD SEC 20 TH S00\*17 00W ALG E-N OF SD LOT FOR 310FT M/L TO S R/W MGN OF INDEX-GALENA CO RD TH S87\*04 27W 265.09FT TH S00\*17 00W 625.34FT TH S87\*15 00W 1060FT M/L TO INT OF N-S LN 1/4 SEC LN OF SD SEC 20 TH S85\*30 00W 136FT TPB TH S43\*33 00W 264.4FT TH S17\*11 00W193.6FT TH S28\*15 00W 164FT TH N59\*34 00W 100FT M/L TO INT OF ELY MGN LN OF R/W OF GN R/W CO TH NLY ALG SD ELY MGN LN OF R/W GN R/W CO TO INT WITH SLY R/W MGN OF INDEX-GALENA CO RD TH NELY ALG SD R/W MGN OF SD RD 375FT M/L TO PT BEAR N04\*47 56E FR TPB TH S04\*47 56W 426FT M/L TPB EXC NLY 10FT CO RD (AKA LOT 4 OF SP293(8-80) REC UND AF NO 8012180264) LESS R/W TO SNO CO PER REC AFN 9703180250

☐ Additional legal description is on page \_\_\_\_ of document

In consideration of Snohomish County Code requirements, except as otherwise provided herein, the CAPA (Critical Area Protection Area) shall be left permanently undisturbed in a substantially natural state.

**Exceptions:** The following are allowed in CAPAs: Existing legally established uses and structures (see site plan); Non-ground disturbing interior or exterior building improvements; routine landscape maintenance of established, ornamental landscaping; non ground disturbing normal maintenance or repair; removal of noxious weeds conducted in accordance with chapter 16-750 WAC; maintenance or replacement that does not expand the affected area of the following existing facilities: (a) septic tanks and drainfields; (b) wells; (c) individual utility service connections; data collection by non-mechanical means, and non-mechanical survey and monument placement.

Applicant: Snohomish County, Parks & Recreation Division  
Project #: 25-106659 SHOR  
Tax Acct. #: 27102000202100

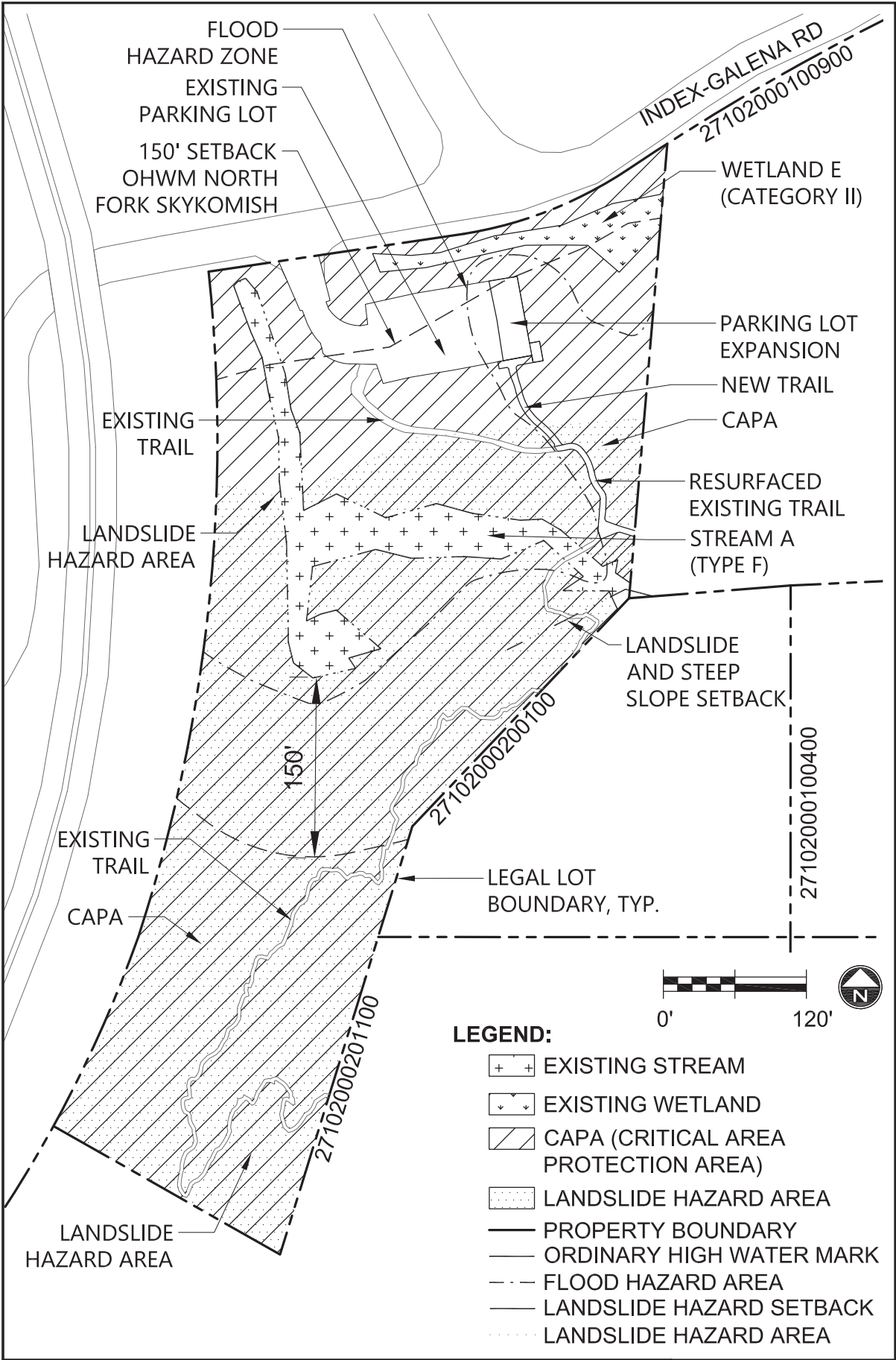

Representation on this site plan may be approximations only and should not be used for purposes other than for determining general locations of critical areas and buffers.

<u>Erin Harker</u>	10/30/2025	<u>Fong, Michael</u>	Digitally signed by Fong, Michael Date: 2026.01.05 13:30:55 -08'00'
APPROVED SNO CO PDS	DATE	OWNER(S)	DATE

Return Address:

CRITICAL AREA SITE PLAN

Project #: 25-106659 SHOR Applicant: Snohomish County, Parks & Recreation Division Site Address: 50606 Index-Galena Rd, Index, WA 98256 Tax Acct. #: 27102000100400		
REFERENCE NUMBER(S) OF RELATED DOCUMENTS:		1 of 2
GRANTOR(S) (OWNERS OF PROPERTY):		
Tom		
Teigen		
LAST NAME	FIRST NAME	MI
GRANTEE(S): SAME AS ABOVE:		

**Legal Description:**

SEC 20 TWP 27 RGE 10 RT-4) LOT 1 LY S OF FDL BEG NE COR LOT 1 SD  
SEC TH S00\*17 00W ALG E LN SD LOT 1 937FT TPB SD LN TH S87\*15 00W  
1325FT M/L TO INT N & S CTR LN SD SEC 20 & TERM OF LN

☐ Additional legal description is on page \_\_\_\_ of document

In consideration of Snohomish County Code requirements, except as otherwise provided herein, the CAPA (Critical Area Protection Area) shall be left permanently undisturbed in a substantially natural state.

**Exceptions:** The following are allowed in CAPAs: Existing legally established uses and structures (see site plan); Non-ground disturbing interior or exterior building improvements; routine landscape maintenance of established, ornamental landscaping; non ground disturbing normal maintenance or repair; removal of noxious weeds conducted in accordance with chapter 16-750 WAC; maintenance or replacement that does not expand the affected area of the following existing facilities: (a) septic tanks and drainfields; (b) wells; (c) individual utility service connections; data collection by non-mechanical means, and non-mechanical survey and monument placement.

Applicant: Snohomish County, Parks & Recreation Division  
Project #: 25-106659 SHOR  
Tax Acct. #: 27102000100400

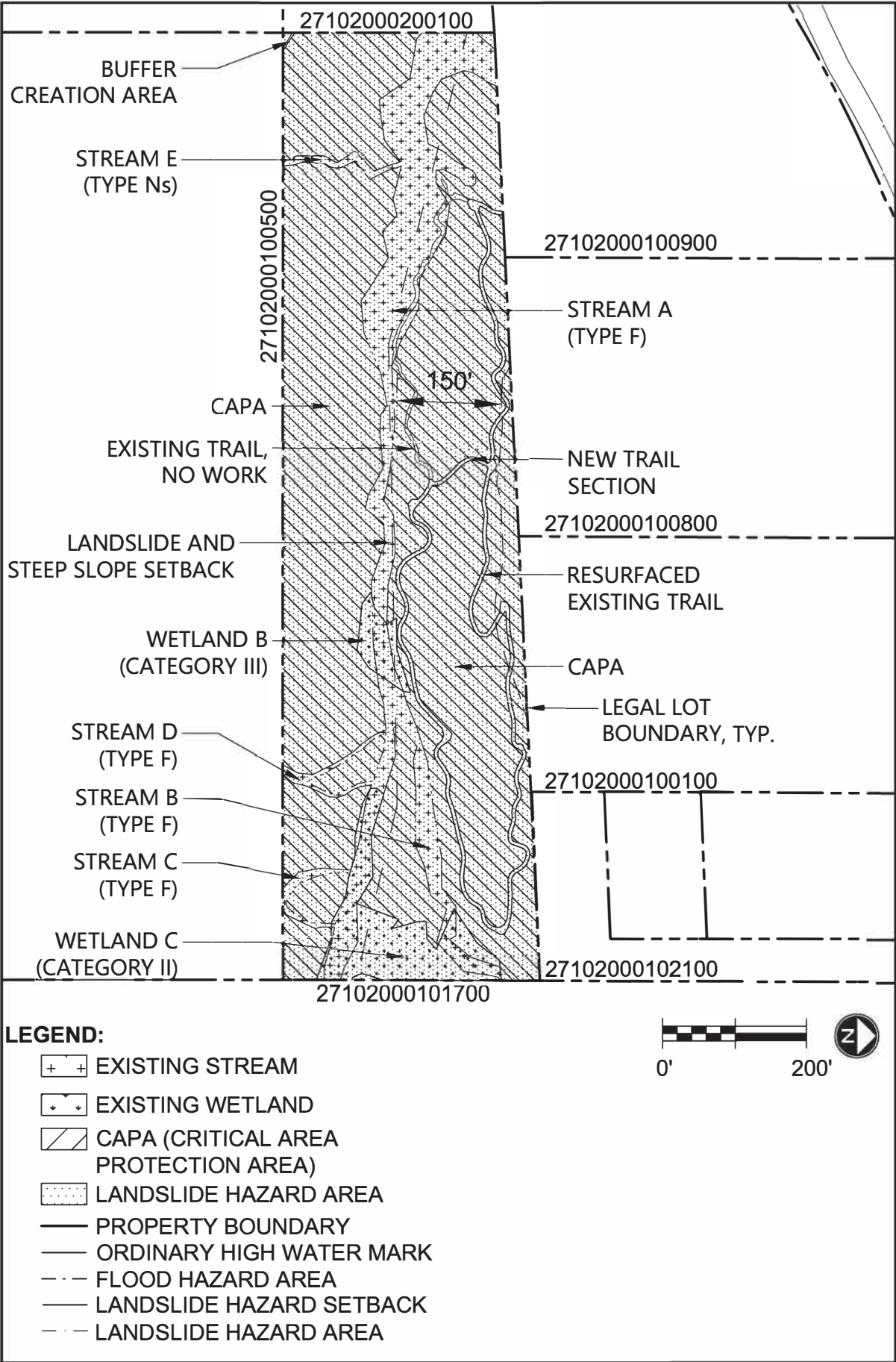

Representation on this site plan may be approximations only and should not be used for purposes other than for determining general locations of critical areas and buffers.

<u>Erin Harker</u>	10/30/2025	Fong, Michael	Digitally signed by Fong, Michael Date: 2026.01.05 13:31:28 -08'00'
APPROVED SNO CO PDS	DATE	OWNER(S)	DATE



Return Address:

CRITICAL AREA SITE PLAN

Project #: 25-106659 SHOR Applicant: Snohomish County, Parks & Recreation Division Site Address: 50606 Index-Galena Rd, Index, WA 98256 Tax Acct. #: 27102000100900		
REFERENCE NUMBER(S) OF RELATED DOCUMENTS:		1 of 2
GRANTOR(S) (OWNERS OF PROPERTY):		
Tom		
Teigen		
LAST NAME	FIRST NAME	MI
GRANTEE(S): SAME AS ABOVE:		

**Legal Description:**

SEC 20 TWP 27 RGE 10 PTN GOVT LOTS 1 & 2 & SE1/4 NW1/4 LY WH FDT COM AT NE COR SD LOT 1 TH S00\*17 00W ALG E LN SD LOT 1 310FT M/L TO S RW MGN INDEX-GALENA CO RD TH S87\*04 27W 265.09FT TO TPB TH S00\*1700W 625.34FT TH S87\*15 00W 1060FT M/L TO AN INT WITH N & S1/4 SEC LN TH S85\*30 00W 136FT TH S43\*33 00W 264FT TH S17\*11 00W 193.60FT TH S28\*15 00W 164FT TH N59\*34 00W 100FT ELY MGN LN R/W GNRR R/WTH NLY ALG SD R/W TH NLY ALG SD ELY MGN LN SD R/W TO AN INT WITH SLY R/W LN INDEX-GALENA RD TH NLY & ELY ALG SLY R/W MGN SD CO RD 1580FT M/L TO TPB EXC E 746FT AS MEAS ALG S LN THOF ALSO EXC PTN DAFCOM AT NE COR SD LOT 1 TH S00\*17 00W ALG E LN SD LOT 310FT M/L TO SR/W MGN INDEX- GALENA RD TH S87\*04 27W 265.09FT TH S00\*17 00W 625.34FT TH S87\*15 00W 1060FTM/L TO INT N-S1/4 SEC LN SEC 20 TH S85\*3000W 136FT TO TPB TH S43\*33 00W 264FT TH S17\*11 00W 193.6FT TH S28\*15 00W 164FT TH N59\*34 00W 100FT M/L TO INT ELY MGN LN OF R/W GNRR R/W TH NLY ALG ELY MGN RR R/W TO INT WITH SLY LN INDEX-GALENA CORD TH NELY ALG SD R/W MGN SD RD 375FT M/L TAP WH BEARS N04\*47 56E FR TPB TH S04\*47 56W 426FT M/L TO TPB AKA LOT 3 OF SP 293 (8-80) AF NO 8012180264. LESS R/W TO SNO CO PER SWD REC AFN 9610310276.

☐ Additional legal description is on page \_\_\_\_ of document

In consideration of Snohomish County Code requirements, except as otherwise provided herein, the CAPA (Critical Area Protection Area) shall be left permanently undisturbed in a substantially natural state.

**Exceptions:** The following are allowed in CAPAs: Existing legally established uses and structures (see site plan); Non-ground disturbing interior or exterior building improvements; routine landscape maintenance of established, ornamental landscaping; non ground disturbing normal maintenance or repair; removal of noxious weeds conducted in accordance with chapter 16-750 WAC; maintenance or replacement that does not expand the affected area of the following existing facilities: (a) septic tanks and drainfields; (b) wells; (c) individual utility service connections; data collection by non-mechanical means, and non-mechanical survey and monument placement.



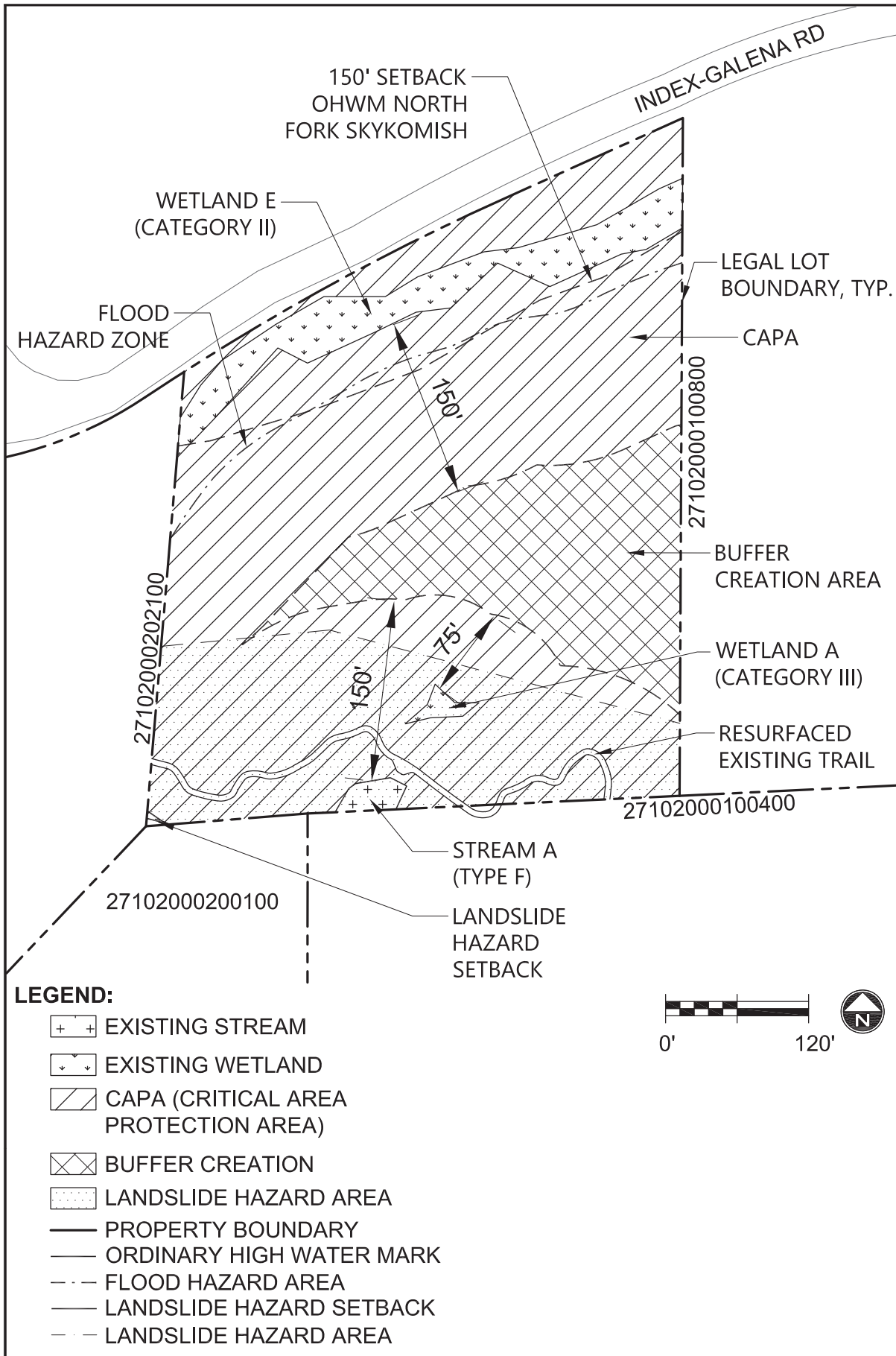

Representation on this site plan may be approximations only and should not be used for purposes other than for determining general locations of critical areas and buffers.

Erin Harker  
APPROVED SNO CO PDS

10/30/2025  
DATE

**Fong, Michael** Digitally signed by Fong, Michael  
Date: 2026.01.05 13:31:59 -08'00'

---

**OWNER(S)** **DATE**