

Exhibit A-1

Supplemental Scope of Work

Ash Way: 18th Avenue W to Admiralty Way
60% Roadway Design
RC-1638, UPI#11-0011

INTRODUCTION

This amendment includes supplemental professional surveying and mapping services along the project corridor.

GENERAL SCOPE OF SERVICES

SCOPE OF SERVICES DEFINED

Task 2 – Survey and Basemapping Coordination

Topographic survey basemaps and digital terrain model prepared by the COUNTY for use during 30% design will be provided to the CONSULTANT in AutoCAD Civil3D format to support the 60% survey and design efforts by the CONSULTANT.

The CONSULTANT will provide supplemental 60% design level survey mapping and digital terrain model of project improvement areas beyond/outside the limits of COUNTY-provided survey.

Survey PM, Admin, QA/QC: This task includes the survey project management, administrative duties, and quality control required for a project of this complexity and magnitude. Depending on the project requirements, SUBCONSULTANT will assign a Survey Project Manager, Assistant Project Manager, and Survey Quality Leader for this project.

Survey Control: Survey horizontal and vertical datums will be based on the provided Snohomish County survey control.

Field Surveying and Mapping: Topographic mapping will be sufficient enough to generate 1' contours for the project areas as shown on Attachment A, Surveying Limits, attached to this amendment. Planimetric mapping will include all features as described on the sheets shown on Attachment A, Surveying Limits, attached to this amendment.

Swamp Creek Mapping: This task includes the field mapping of Swamp Creek to facilitate the design of a fish passable culvert and channel.

Topographic Mapping: The topographic mapping will extend 350' upstream and 350' downstream of the culvert crossing at Gibson Rd/Admiralty Way and 15' beyond the top of bank of each side of the creek. Cross-sections will be run at 25' intervals for the length of the mapping area. Other features that will be located within the mapping area include top and toe of bank, thalweg, water surface (at the time of survey), pools, outcrops, and steps.

Agreement Number: CCF02-18

Office Processing: This task includes the office processing of the collected survey data, data extraction, field book note reductions, CADD drafting, and other duties required for the generation of the supplemental survey and base mapping.

Assumptions:

- Safety will be considered more important than project delivery. Any unsafe conditions or situations will be reported to the COUNTY for consideration of a solution. The CONSULTANT will make an estimate if any safety issues possible affect the timing, schedule, or completeness of the surveying services.
- The COUNTY will provide existing horizontal and vertical control.
- Rights-of-Entry, if required, will be organized, granted and confirmed by the COUNTY.
- Survey of wetland delineation/flags is not a part of these services.
- Right-of-Way and parcel resolution are not a part of these services.
- A Record of Survey/setting of property corners is not part of these services.
- Locating geotechnical boreholes and utility potholes are not a part of these services.
- Trees greater than 6" DBH will be located as part of these tasks. Driplines will not be collected.
- Underground conductible utilities are not a part of these services.
- Utility locates is not a part of these services.
- COUNTY will provide existing basemap files in Civil3D with field survey data, DTM surfaces, and support files suitable for external referencing into design files upon notice to proceed.
- The survey control plan will be prepared by the COUNTY for the contract documents with assistance by the CONSULTANT.
- The CONSULTANT will rely on the accuracy of the base maps provided by the COUNTY.

Deliverables:

- Civil 3D drawing file containing only the supplemental survey base map at 1"= 20' with 1-foot contours (electronic copy) in Snohomish County Standards.
- Civil 3D drawing file integrating the Snohomish County collected mapping into a separate stand along drawing for the use of the design team.
- A merged DTM of both the supplemental survey and the Snohomish County survey.

Agreement Number: CCF02-18



**1 ALLIANCE
GEOMATICS
SURVEYING & MAPPING**

Drawing A, Surveying Limits

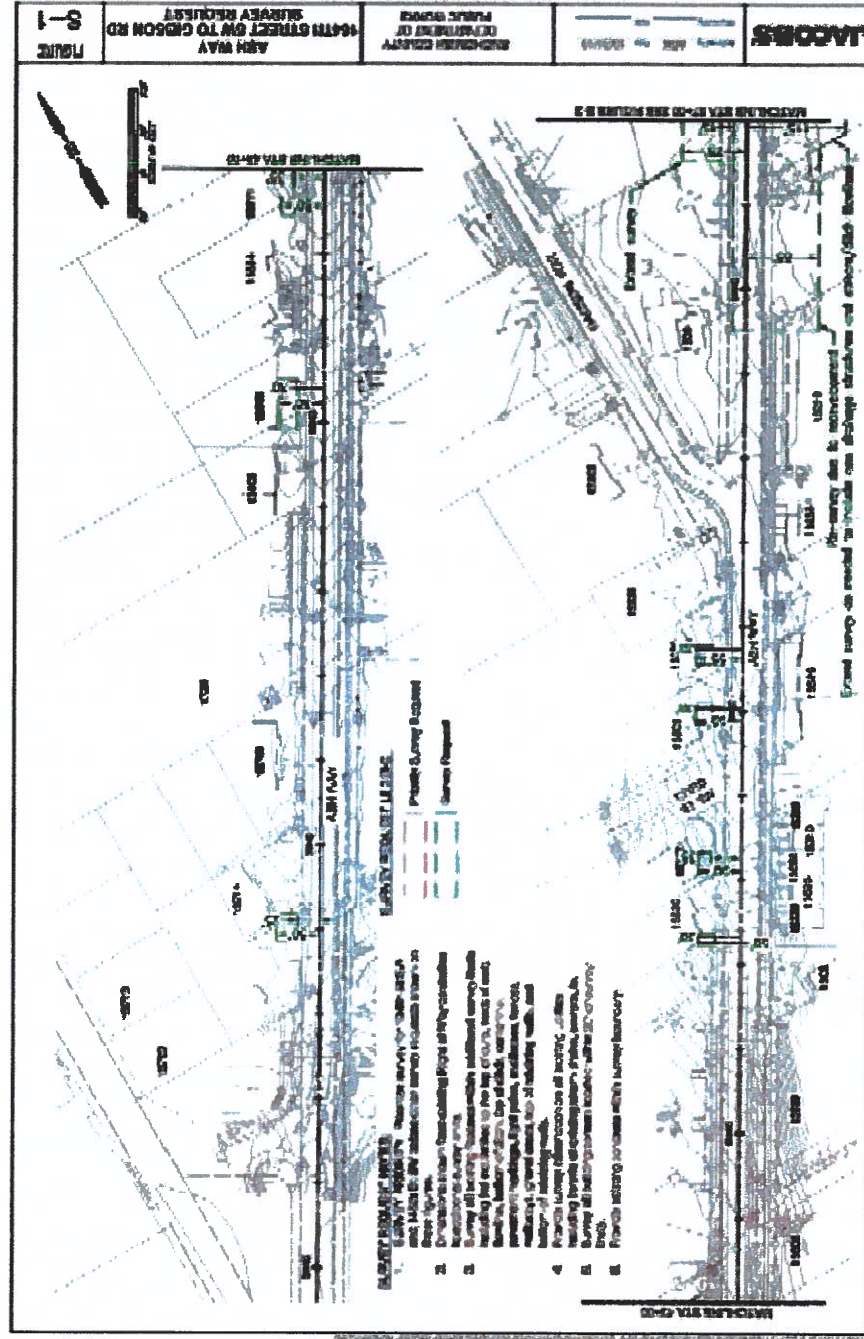

1 Alliance Geomatics
 Bellevue | Everett | Tacoma | Portland
 Main 425.598.2200 | Fax 425.502.8067
 1261A 120th Ave NE, Bellevue, WA 98005

Agreement Number: CCF02-18



**1 ALLIANCE
GEOMATICS
SURVEYING & MAPPING**

Drawing A, Surveying Limits (cont.)

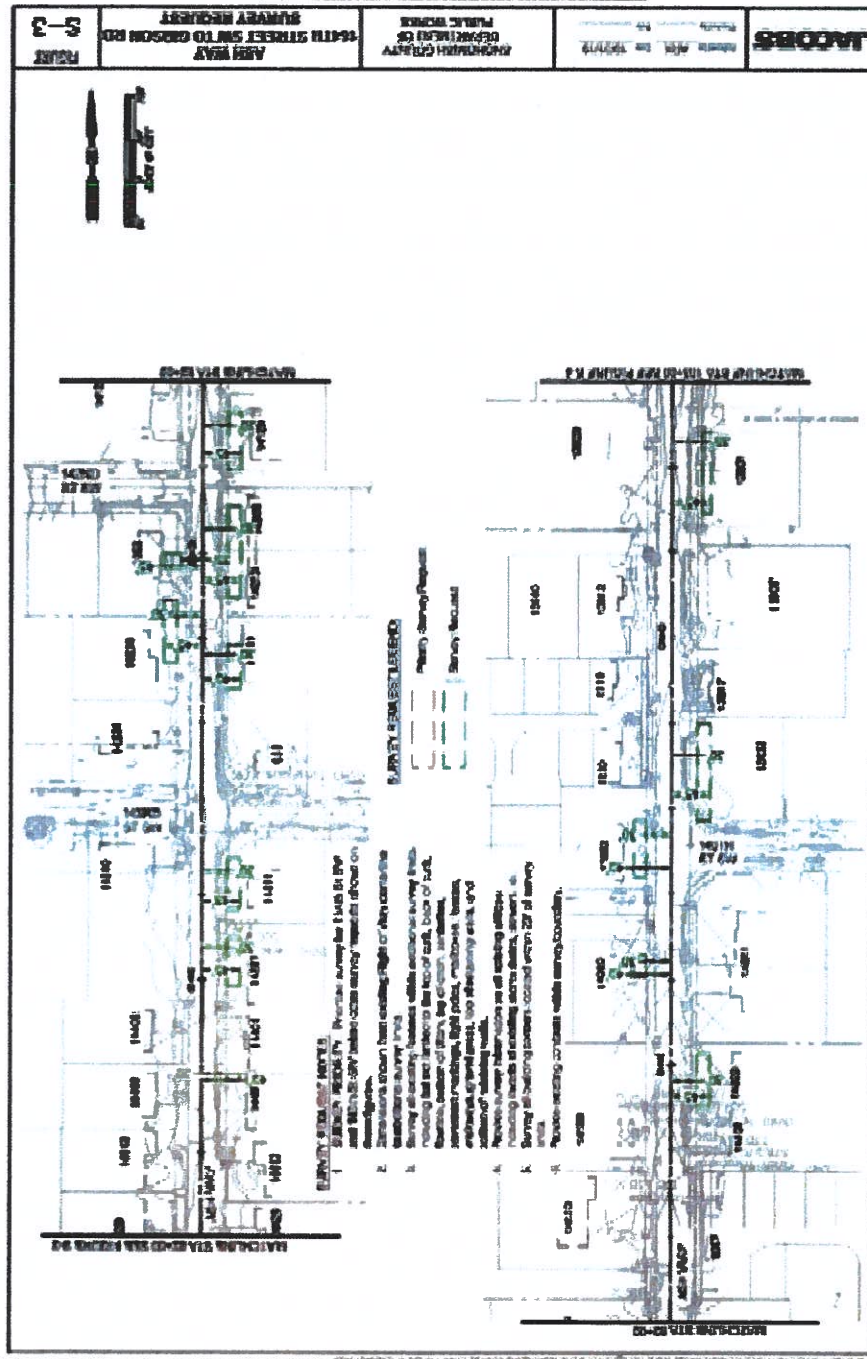

1 Alliance Geomatics
 Bellevue | Everett | Tacoma | Portland
 Main 425.598.2200 | Fax 425.502.8067
 1261A 120th Ave NE, Bellevue, WA 98005

Agreement Number: CCF02-18



**1 ALLIANCE
GEOMATICS**
SURVEYING & MAPPING

Drawing A, Surveying Limits (cont.)

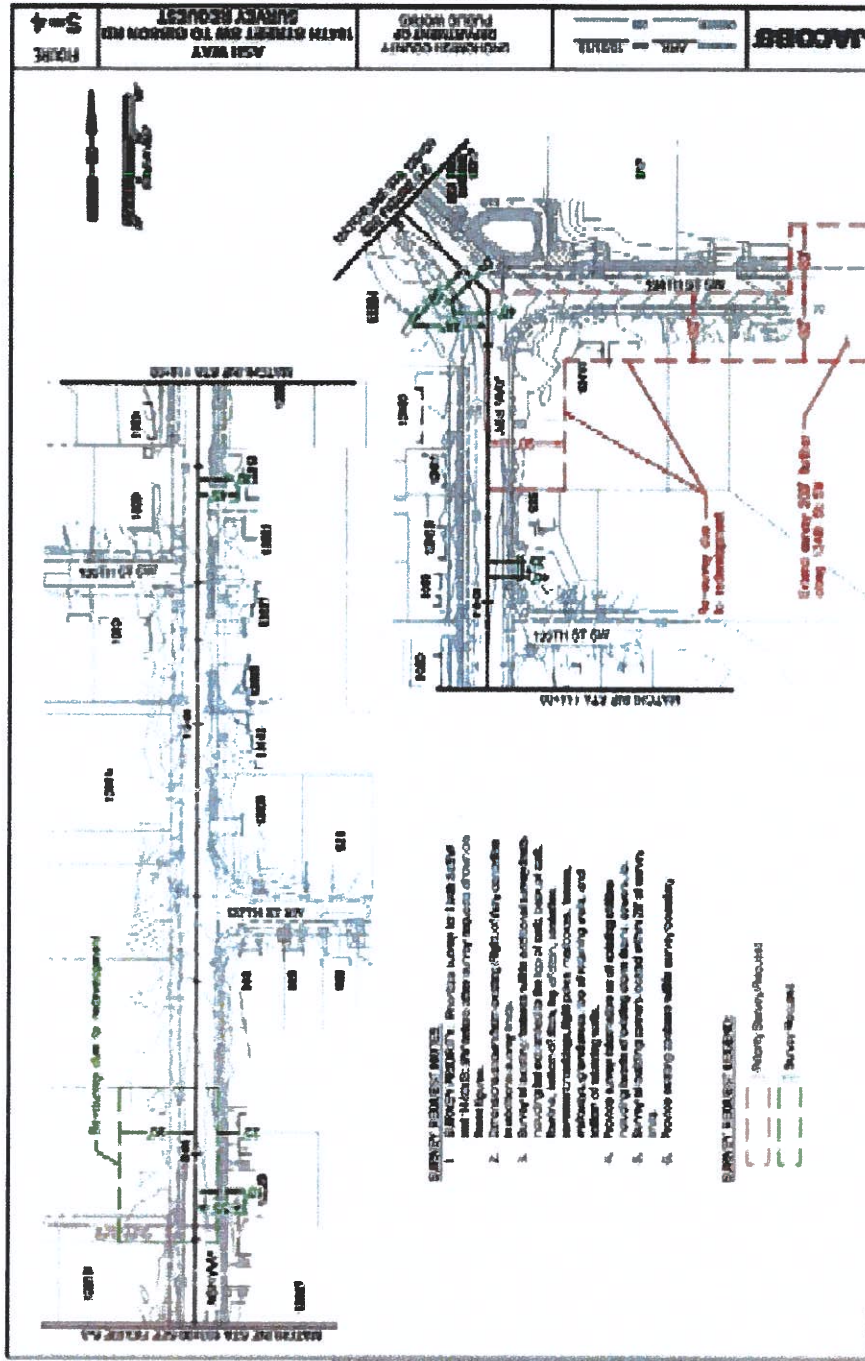

1 Alliance Geomatics
Bellevue | Everett | Tacoma | Portland
Main 425.598.2200 | Fax 425.502.8067
1261A 120th Ave NE, Bellevue, WA 98005

Agreement Number: CCF02-18



1 ALLIANCE GEOMATICS SURVEYING & MAPPING

Drawing A, Surveying Limits (cont.)

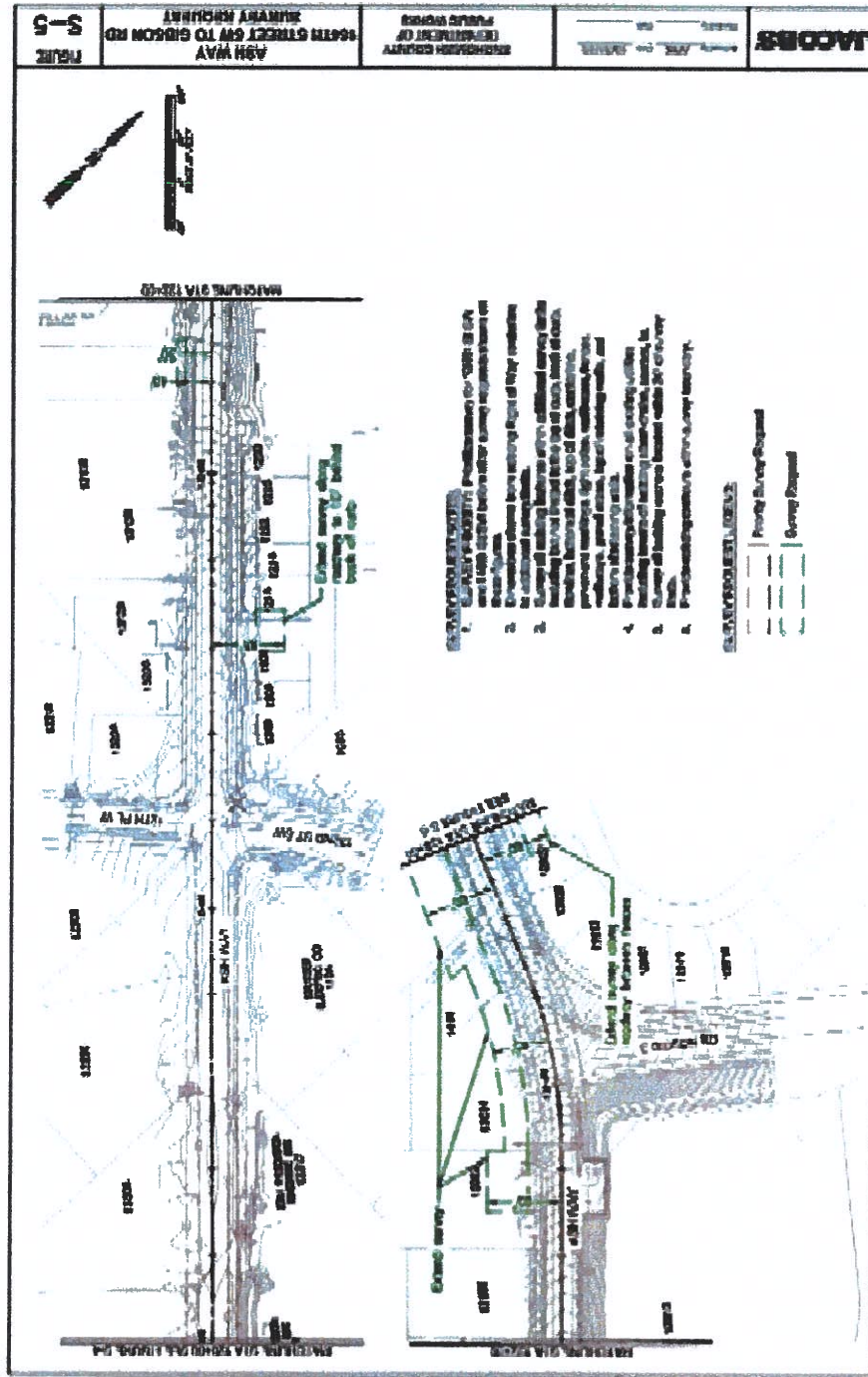

1 Alliance Geomatics
 Bellevue | Everett | Tacoma | Portland
 Main 425.598.2200 | Fax 425.502.8067
 1261A 120th Ave NE, Bellevue, WA 98005

Agreement Number: CCF02-18



**1 ALLIANCE
GEOMATICS
SURVEYING & MAPPING**

Drawing A, Surveying Limits (cont.)

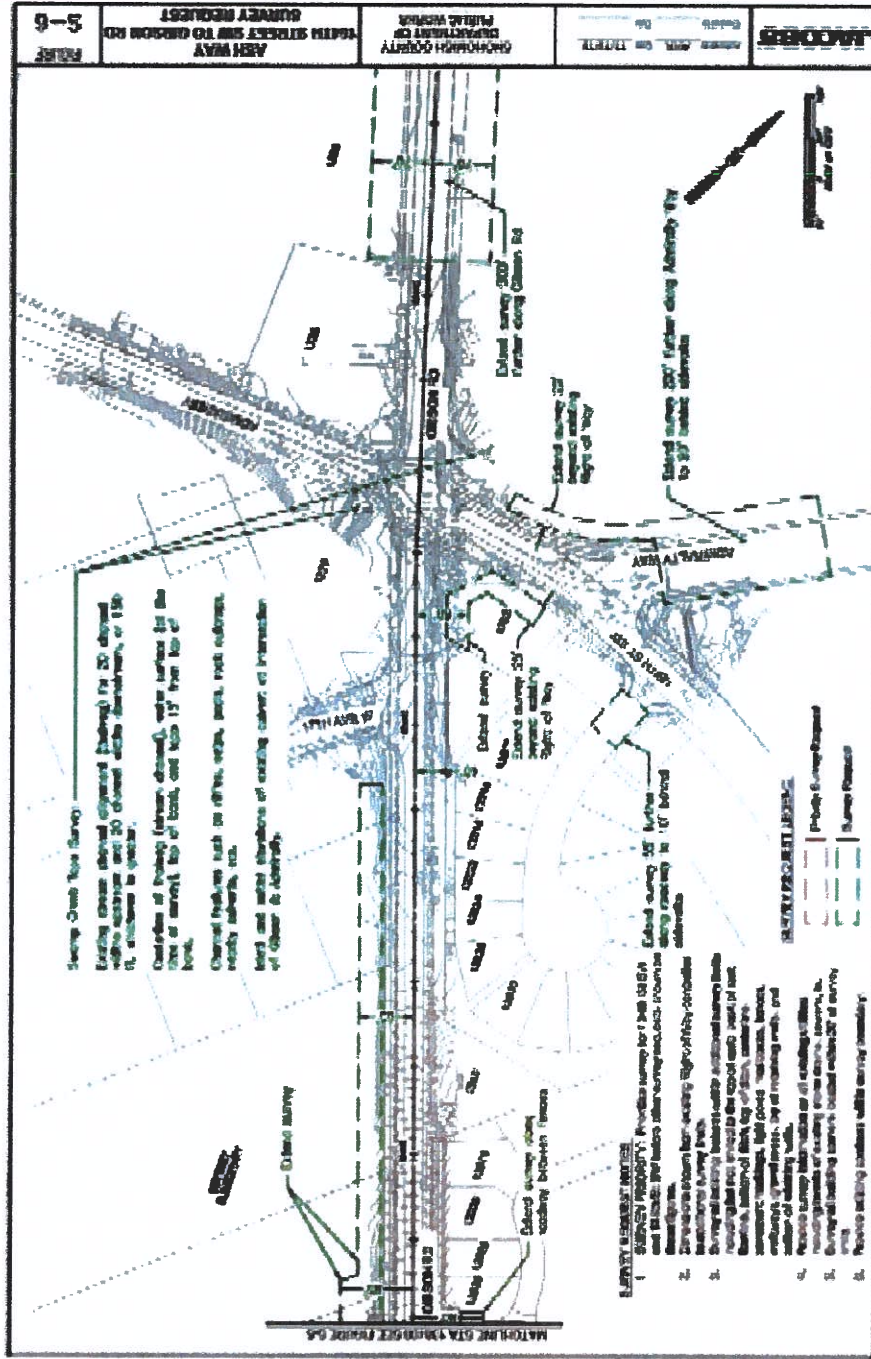

1 Alliance Geomatics
 Bellevue | Everett | Tacoma | Portland
 Main 425.598.2200 | Fax 425.502.8067
 1261A 120th Ave NE, Bellevue, WA 98005

Agreement Number: CCF02-18

Exhibit D
Prime Consultant Cost Computations

Ash Way
Supplement No. 2 Design Fee

Classification - Jacobs	Hours	x	Rate	=	Cost
Civil Engr 4	16		\$ 156.53		\$ 2,504
Civil Engr 2	16		\$ 97.07		\$ 1,553
CADD Design 4	16		\$ 125.16		\$ 2,003
Subtotal	48				\$ 6,060

Direct Non-Salary Costs					Cost
Mileage	120	Miles @	\$ 0.545		\$ 65.40
Misc(courier, postage, phone, etc.)		@			-
Parking	2	@	\$ 15.00		\$ 30.00
Direct Non-Salary Costs Total					\$ 95

Subconsultant			Cost
1 Alliance			\$ 93,660
Subconsultant Costs Total			\$ 93,660

Jacobs Engineering Group Inc. TOTAL	\$ 99,816
--	------------------

Agreement Number: CCF02-18

Fee Schedule

Consultant: Jacobs Engineering Group

Position Classification	Direct Salary Rate	ICR @109.77%	Profit @27.40%	Max Rate Per Hour
Project Manager 4, Kevin Kim	\$106.13	\$116.50	\$29.08	\$251.72
Project Manager 4	\$78.00	\$85.62	\$21.37	\$185.00
Project Manager 3	\$78.00	\$85.62	\$21.37	\$185.00
Project Manager 2, Jeanette DeLay	\$81.66	\$89.64	\$22.38	\$193.68
Project Manager 2	\$74.21	\$81.46	\$20.33	\$176.00
Project Manager 1	\$74.37	\$81.64	\$20.38	\$176.39
Civil Engineer 4	\$66.00	\$72.45	\$18.08	\$156.53
Civil Engineer 3	\$58.00	\$63.67	\$15.89	\$137.56
Civil Engineer 2	\$51.00	\$55.98	\$13.97	\$120.96
Civil Engineer 1	\$45.00	\$49.40	\$12.33	\$106.73
Structural Engineer 6	\$79.90	\$87.71	\$21.89	\$189.50
Structural Engineer 5	\$75.00	\$82.33	\$20.55	\$177.88
Structural Engineer 4	\$66.00	\$72.45	\$18.08	\$156.53
Structural Engineer 3	\$58.00	\$63.67	\$15.89	\$137.56
Structural Engineer 2	\$51.00	\$55.98	\$13.97	\$120.96
Structural Engineer 1	\$45.00	\$49.40	\$12.33	\$106.73
CADD Design 5	\$59.03	\$64.80	\$16.17	\$140.00
CADD Design 4, Elizabeth Goller	\$52.77	\$57.93	\$14.46	\$125.16
CADD Design 4	\$48.49	\$53.23	\$13.29	\$115.00
Contract Administration	\$49.12	\$53.92	\$13.46	\$116.50
Senior Project Administrative Assistant	\$44.85	\$49.23	\$12.29	\$106.37
Project Administrative Assistant	\$35.48	\$38.95	\$9.72	\$84.15
Intern - Engineering	\$35.48	\$38.95	\$9.72	\$84.15
Environmental Planner 4	\$66.00	\$72.45	\$18.08	\$156.53
Biologist 5	\$75.26	\$82.62	\$20.62	\$178.50

The indirect cost rate (ICR), profit, and max rate per hour listed above are the maximum rates payable under this AGREEMENT. Rates invoiced shall be based on the direct salary of the individual employee plus ICR plus profit and shall not exceed the Max Rate Per Hour for each classification listed in this Exhibit D without prior written consent of the COUNTY.

Subconsultant Services and Other Direct Costs (ODC) will be reimbursed at the Actual Cost to the Consultant with no markup. ODCs are limited to the following items:

Reimbursable Classifications	Rates
Mileage	Current IRS Rate
Outside Vendor Costs	At Cost

Any ODC not included in the above list shall not be eligible for payment without prior written consent of the County. All reimbursable charges must be necessary for the services provided under this AGREEMENT.

Agreement Number: CCF02-18



**Washington State
Department of Transportation**

Transportation Building
310 Maple Park Avenue S.E.
P.O. Box 47300
Olympia, WA 98504-7300
360-705-7000
TTY: 1-800-833-6368
www.wsdot.wa.gov

April 19, 2019

Jacobs Engineering Group
1999 Bryan Street, Suite 1200
Dallas, TX 75201

Subject: Acceptance FYE 2018 ICR – CPA Report

Dear Lisa Oros:

We have accepted your firms FYE 2018 Indirect Cost Rate (ICR) based on the "Independent CPA Report," prepared by Cleary Government Services, LLC.

Jacobs Building and Infrastructure Americas (BIA) Design (At Office) 109.77% of direct labor
Jacobs Building and Infrastructure Americas (BIA) Design (At Site) 88.03% of direct labor

Jacobs BIA Project Management/Construction Management (At Office) 88.27% of direct labor
Jacobs BIA Project Management/Construction Management (At Office) 65.96% of direct labor

CH2M Hill (Home Office) 102.24% of direct labor (rates includes 0.34% Facilities Capital Cost of Money)

CH2M Hill (Field Office) 90.64% of direct labor

This rate will be applicable for WSDOT Agreements and Local Agency Contracts in Washington only. This rate may be subject to additional review if considered necessary by WSDOT. Your ICR must be updated on an annual basis.

Costs billed to agreements/contracts will still be subject to audit of actual costs, based on the terms and conditions of the respective agreement/contract.

This was not a cognizant review. Any other entity contracting with the firm is responsible for determining the acceptability of the ICR.

If you have any questions, feel free to contact our office at (360) 705-7019 or via email consultantrates@wsdot.wa.gov.

Regards,

Jonson, Erik
Apr 22 2019 8:44 AM

cosign

ERIK K. JONSON
Manager, Consultant Services Office

EKJ:mya

Acceptance ICR CPA Report

Agreement Number: CCF02-18

Exhibit E
Sub-consultant Cost Computations

Ash Way
Amendment No. 2
1 Alliance Design Fee

Classification - 1 Alliance	Hours	x	Rate	=	Cost
Director	6		\$ 240.00		\$ 1,440
Land Surv. 3	40		\$ 167.75		\$ 6,710
Land Surv. 2	16		\$ 136.62		\$ 2,186
Eng Aide 4	126		\$ 126.00		\$ 15,876
Eng Aide 4	216		\$ 126.00		\$ 27,216
Eng Aide 2	216		\$ 96.77		\$ 20,802
Eng Aide 2	156		\$ 96.77		\$ 15,090
Admin. Ass. 3	8		\$ 81.12		\$ 649
Admin. Ass. 5	4		\$ 116.50		\$ 466
Admin. Ass. 3	8		\$ 81.12		\$ 649
Subtotal	796				\$ 91,190

Direct Non-Salary Costs				Cost
Mileage	810	Miles @	\$ 0.580	\$ 469.80
Traffic Control (Uniformed Officer)	1	@	\$ 2,000.00	\$ 2,000.00
		@		\$ -
Reproduction		Page@	\$ 0.10	\$ -

Direct costs are paid based on actual expenses with no mark ups.

Receipts, logs, etc are required for reimbursement.

Direct Non-Salary Costs Total \$ 2,470

1 Alliance TOTAL	\$ 93,660
-------------------------	------------------

Fee Schedule

Subconsultant: 1 Alliance Geomatics, LLC

Position Classification	Direct Salary Rate	ICR @157.22%	Profit @27.40%	Max Rate Per Hour
Administrative Assistant 3	\$28.50	\$44.81	\$7.81	\$81.12
Administrative Assistant 5	\$40.93	\$64.35	\$11.22	\$116.50
Director	\$84.32	\$132.57	\$23.10	\$240.00
Engineering Aide 2	\$34.00	\$53.45	\$9.32	\$96.77
Engineering Aide 4	\$44.27	\$69.60	\$12.13	\$126.00
Land Survey 2	\$48.00	\$75.47	\$13.15	\$136.62
Land Survey 3/Survey Manager	\$58.94	\$92.66	\$16.15	\$167.75

The indirect cost rate (ICR), profit, and max rate per hour listed above are the maximum rates payable under this AGREEMENT. Rates invoiced shall be based on the direct salary of the individual employee plus ICR plus profit and shall not exceed the Max Rate Per Hour for each classification listed in this Exhibit E without prior written consent of the COUNTY.

Other Direct Costs (ODC) will be reimbursed at the Actual Cost to the subconsultant with no markup. ODCs are limited to the following items:

Reimbursable Classifications	Rates
Mileage	Current IRS Rate
Outside Vendor Costs	At Cost

Any ODC not included in the above list shall not be eligible for payment without prior written consent of the County. All reimbursable charges must be necessary for the services provided under this AGREEMENT.



**Washington State
Department of Transportation**

Transportation Building
310 Maple Park Avenue S.E.
P.O. Box 47300
Olympia, WA 98504-7300
360-705-7000
TTY: 1-800-833-6388
www.wsdot.wa.gov

July 16, 2019

1 Alliance Geomatics
1261A-120th Avenue NE
Bellevue, WA 98005

Subject: Acceptance FYE 2018 ICR – Audit Office Review

Dear Michael Paradis:

Transmitted herewith is the WSDOT Audit Office's memo of "Acceptance" of your firm's FYE 2018 Indirect Cost Rate (ICR) of 157.22% of direct labor. This rate will be applicable for WSDOT Agreements and Local Agency Contracts in Washington only. This rate may be subject to additional review if considered necessary by WSDOT. Your ICR must be updated on an annual basis.

Costs billed to agreements/contracts will still be subject to audit of actual costs, based on the terms and conditions of the respective agreement/contract.

This was not a cognizant review. Any other entity contracting with your firm is responsible for determining the acceptability of the ICR.

If you have any questions, feel free to contact our office at (360) 705-7019 or via email consultantrates@wsdot.wa.gov.

Regards;

Jonson, Erik
Jul 16 2019 11:04 AM

ERIK K. JONSON
Contract Services Manager

EKJ:ah

Acceptance ICR Audit Office Review

Agreement Number: CCF02-18