

# SNOHOMISH COUNTY BALLOT FACILITY TENANT IMPROVEMENTS

## - ADMIN WEST 3RD FLOOR

3000 ROCKEFELLER AVE, EVERETT WA 98201

**PROJECT #:** 21016-2201

**PROJECT DESCRIPTION:** RENOVATION OF SNOHOMISH COUNTY'S 3RD FLOOR WEST ADMINISTRATIVE BUILDING. THIS PROJECT IS LOCATED AT 3000 ROCKEFELLER AVE. EVERETT, WA 98201. RENOVATION WORK INCLUDES 17,000 SQ. FT. OF TENANT IMPROVEMENT TO CONVERT AN EXISTING OFFICE AREA INTO THE NEW SNOHOMISH COUNTY ELECTIONS & BALLOT COUNTING PROCESSING FACILITY.

**LEGAL DESCRIPTION:** EVERETT PLAT OF BLK 716 D-00 - ALL BLK 716 TGW W1/2 VAC ROCKEFELLER ST LY ADJ TO & TGW VAC ALLEY WHN SD BLK

**LAND USE CODE:** 671 EXECUTIVE, LEGISLATIVE AND JUDICIAL FUNCTIONS

**ARCHITECT:** WJA DESIGN COLLABORATIVE

**PROJECT MANAGER:** SHAUNA ALLISON

**ADDRESS:** 617 WESTERN AVENUE, SEATTLE, WA

**OWNER:** SNOHOMISH COUNTY

**CONTACT:** JEFFERY HENCZ

**ADDRESS:** 3000 ROCKEFELLER AVENUE, EVERETT, WA

**FLOOR AREA:** 17,000 SF (NO CHANGE)

**CODE:** 2018 INTERNATIONAL BUILDING CODE (2018 IBC)  
 2018 INTERNATIONAL EXISTING BUILDING CODE (IEBC)  
 2018 INTERNATIONAL MECHANICAL CODE (IMC)  
 2018 UNIFORM PLUMBING CODE (UPC)  
 2020 NATIONAL ELECTRICAL CODE (NFPA 70)  
 ICC A117.1-2009 ACCESSIBLE AND USABLE BUILDINGS AND FACILITIES

**PARCEL NUMBER:** 00439171600000

SHEET LIST	
SHEET NO.	SHEET NAME
GENERAL	
G-001	COVER SHEET
ARCHITECTURAL GENERAL	
A-001	ARCHITECTURAL GENERAL NOTES & LEGENDS
A-002	ACCESSIBILITY DIAGRAMS
A-003	ACCESSIBILITY DIAGRAMS
A-004	ADMIN 3RD FLOOR WEST - CODE ANALYSIS
A-005	ADMIN 3RD FLOOR WEST - CODE PLAN
A-006	ADMIN 3RD FLOOR WEST - EXISTING FLOOR PLAN
A-007	ADMIN 3RD FLOOR WEST - EXISTING CONDITIONS - IMAGES
AD101	ADMIN 3RD FLOOR WEST - DEMOLITION PLAN
AD102	ADMIN 3RD FLOOR WEST - DEMOLITION CEILING PLAN
ARCHITECTURAL	
A-101	ADMIN 3RD FLOOR WEST - FLOOR PLAN
A-102	ADMIN 3RD FLOOR WEST - FURNITURE & EQUIPMENT PLAN
A-111	ADMIN 3RD FLOOR WEST - REFLECTED CEILING PLAN
A-201	WALL ELEVATIONS - CORRIDOR MONITORS & LOBBY ENTRY
A-202	FINISH ELEVATIONS - ACOUSTIC WALL PANELS
A-203	FINISH ELEVATIONS - ACOUSTIC WALL PANELS
A-311	WALL SECTIONS
A-401	ENLARGED FLOOR PLAN - BREAK ROOM
A-402	ENLARGED FLOOR PLAN - BALLOT SCANNERS
A-501	FIRE RATED DETAILS
A-502	DOOR AND WINDOW DETAILS
A-503	CASEWORK DETAILS
A-504	GENERAL DETAILS
A-505	FRAMING DETAIL ELEVATIONS
A-601	WALL, FLOOR & CEILING TYPES LEGEND
A-603	DOOR AND WINDOW SCHEDULE AND LEGEND
INTERIORS	
I-101	FINISH PLAN
I-601	INTERIOR FINISH LEGEND AND SCHEDULE
I-602	SIGNAGE SCHEDULE
FIRE ALARM	
FA000	FIRE ALARM LEGEND, ABBREV. AND GENERAL NOTES
FA102	3RD FLOOR WEST - FIRE ALARM PLAN
PLUMBING GENERAL	
P000	PLUMBING GENERAL NOTES AND PARTIAL PLANS
MECHANICAL GENERAL	
M000	HVAC LEGEND, ABBREVIATION AND GENERAL NOTES
MD101	3RD FLOOR WEST HVAC DEMOLITION PLAN
MECHANICAL	
M101	3RD FLOOR WEST - HVAC FLOOR PLAN
M501	HVAC DETAILS
M601	HVAC SCHEDULES
M701	SCHEDULE OF OPERATIONS & POINTS LIST
ELECTRICAL GENERAL	
E000	ELECTRICAL LEGEND, ABBREVIATION AND GENERAL NOTES
ED101	3RD FLOOR WEST- ELECTRICAL POWER DEMOLITION FLOOR PLAN
ED102	3RD FLOOR WEST- ELECTRICAL LIGHTING DEMOLITION FLOOR PLAN
ELECTRICAL	
E101	3RD FLOOR WEST- ELECTRICAL POWER FLOOR PLAN
E102	3RD FLOOR WEST - ELECTRICAL LIGHTING FLOOR PLAN
E201	3RD FLOOR WEST- ELECTRICAL IT SYSTEMS PLAN
E501	ELECTRICAL DETAILS
E601	ELECTRICAL SCHEDULES
E602	CONDUIT SCHEDULE
E701	ELECTRICAL ONE-LINE DIAGRAM

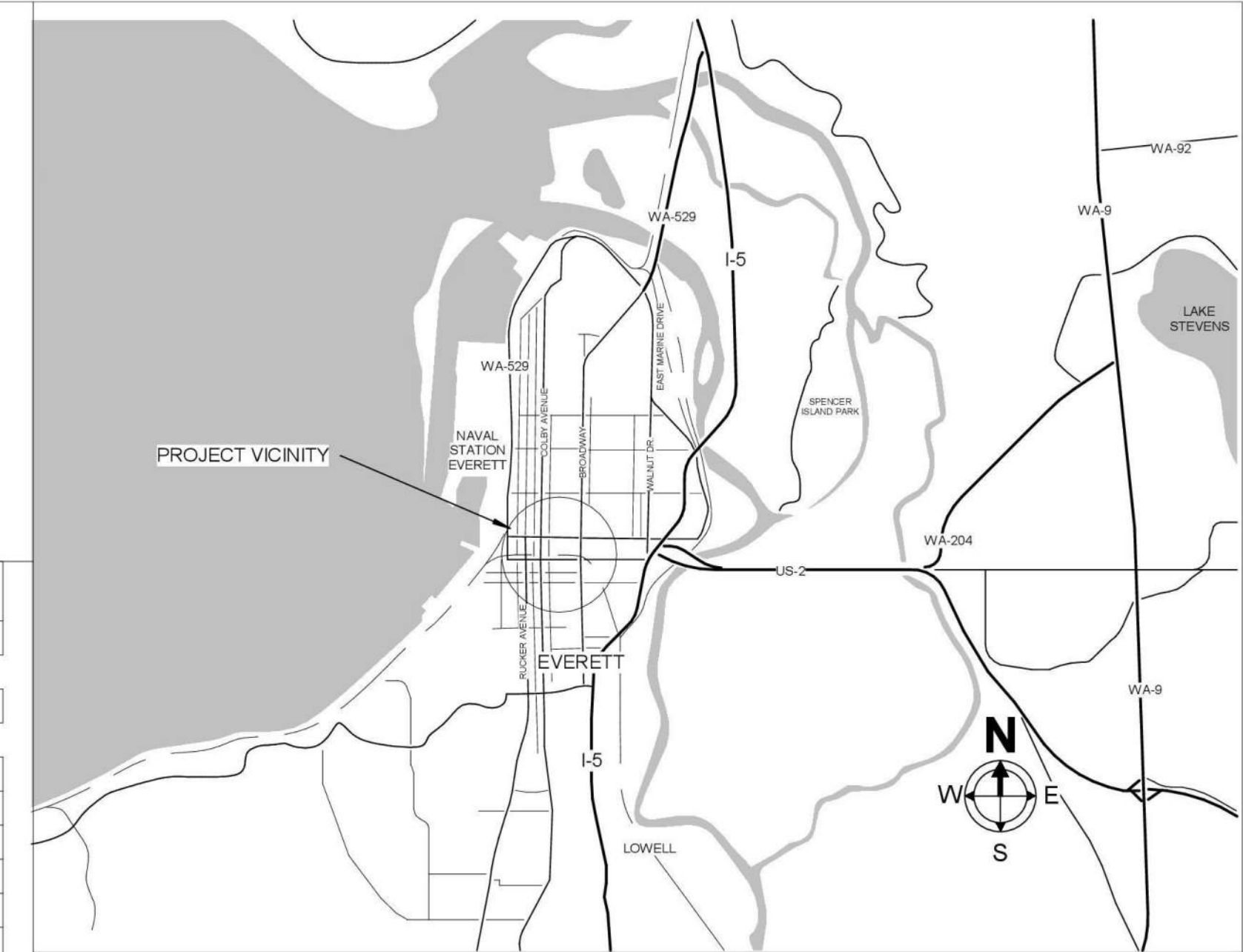

**VICINITY MAP** NOT TO SCALE

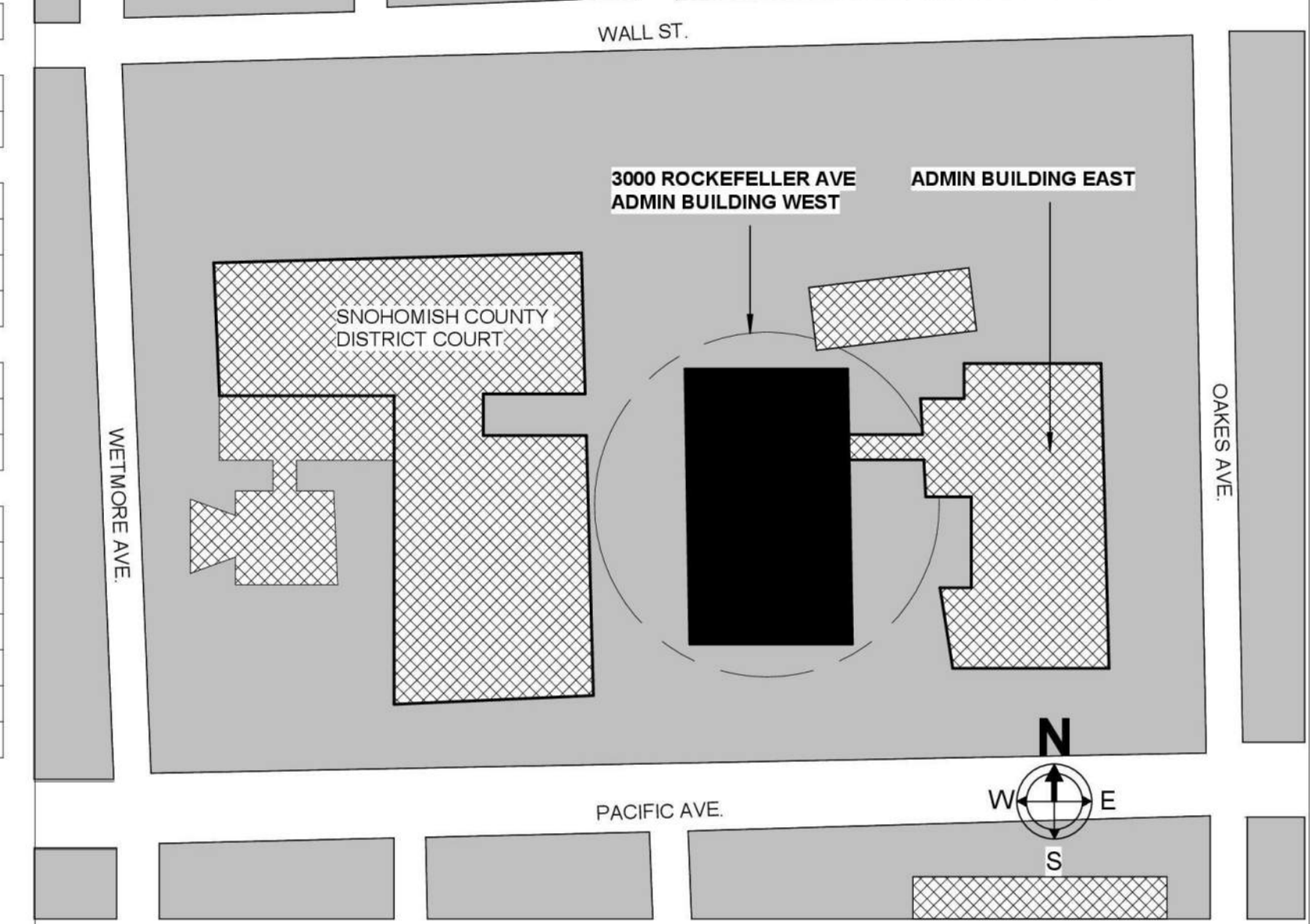
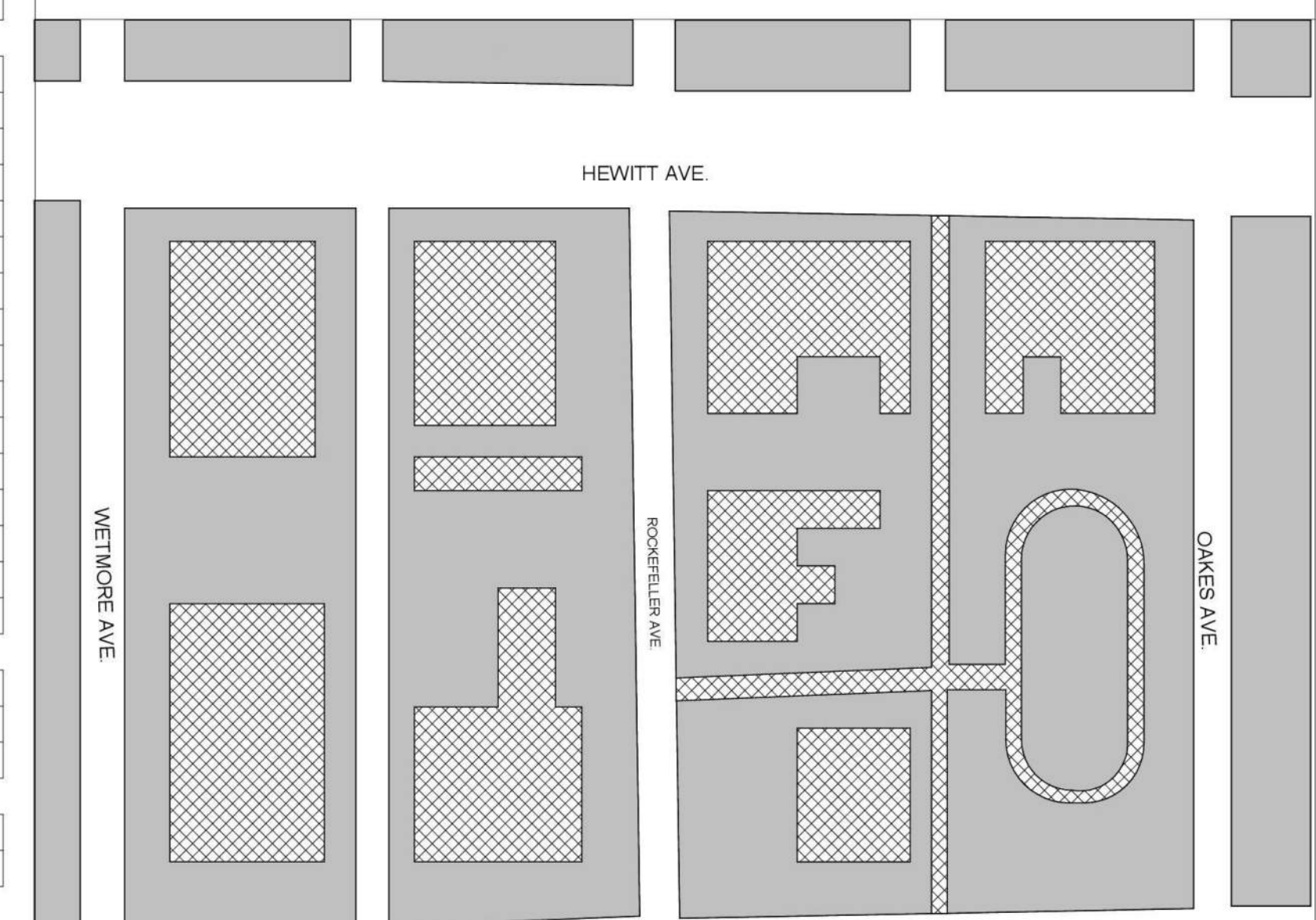

**SITE PLAN** NOT TO SCALE



design collaborative  
 617 Western Avenue  
 Seattle, WA 98104  
 Tel. 206.946.9746  
 www.wja-dc.com



Project No.: 21016	Designed By: WJA	Drawn By: RM, SA	Checked By: EP
Date	Description	Mark	

SNOHOMISH COUNTY  
 SNOHOMISH COUNTY BALLOT FACILITY TENANT IMPROVEMENTS - ADMIN  
 WEST 3RD FLOOR - 3000 ROCKEFELLER AVENUE, EVERETT, WA  
**COVER SHEET**

**G-001**

Sheet Size: 22" x 34"