

SNOHOMISH COUNTY COUNCIL
Snohomish County, Washington

MOTION NO. 22-439

APPROVING AND AUTHORIZING THE COUNTY EXECUTIVE
TO EXECUTE A CRITICAL AREA SITE PLAN

WHEREAS, in November 2006, the Snohomish County Council approved construction of the Woods Creek Bridge #445 (RC1232); and

WHEREAS, in order for this project to be constructed, a Critical Area Study was prepared for the project dated May 2005; and

WHEREAS, the Critical Area Study called for a designated protection site that would be left permanently undisturbed in a substantially natural state for compensatory mitigation of the project's impacts to critical areas; and

WHEREAS, parcel 28073500100500 was chosen for the critical area impact mitigation site to be protected in perpetuity; and

WHEREAS, in order to permanently protect this property, a Critical Area Site Plan is required to be approved by the Snohomish County Council and recorded with the Snohomish County Auditor;

NOW, THEREFORE, ON MOTION, the Snohomish County Council hereby authorizes the critical area protection on County property as shown on the Critical Area Site Plan as attached hereto and incorporated by reference herein and authorizes the County Executive to execute the same.

PASSED this 14th day of December, 2022.

SNOHOMISH COUNTY COUNCIL
Snohomish County, Washington



Council Chair

ATTEST:



Asst. Clerk of the Council

Return Address:
Public Works MS 607
3000 Rockefeller Ave MS 607
Everett, WA 98201

CRITICAL AREA SITE PLAN

Applicant/Project Proponent: **Snohomish County Public Works**
Project Name and #: **Woods Creek Bridge #445 (RC1232)**
Site Address: **MP 2.72 Florence Acres Road, Monroe**
Tax Acct #: **28073500100500**

PAGE 1 OF 2

This Critical Area Site Plan is recorded to provide permanent protection for critical areas to comply with conditions of the Army Corp of Engineers Permit #200500699 issued in connection with the Woods Creek Bridge 445 Replacement Project, as shown on the project right-of-way plans, filed with Snohomish County Public Works under Survey # 3653
REFERENCE NUMBER(S) OF RELATED DOCUMENTS:

GRANTOR(S): **Snohomish County**

GRANTEE(S): **The Public**

Legal Description:

**SEC 35 TWP 28 RGE 07TH PTN LY N OF CO RD & LY E OF WOODS CR OF FDP
NW1/4 NE1/4 LY E OF WOODS CR LESS RD**

Notes:

1. Mitigation areas and associated maintenance activities to improve wetland, stream and buffer functions exist on this parcel. Future restoration or mitigation measures are permitted including unavoidable temporary disturbance to soils and vegetation to achieve improvement of ecological functions.
2. The restrictions imposed by this Critical Area Site Plan do not supersede or otherwise diminish previously established easements, conveyances, or other legally established uses.
3. The following activities are restricted: (a) construction of new structures; (b) removal of existing native vegetation; and (c) other development activities that would adversely affect the functions and values of the critical areas and buffers. Habitat enhancement in wetland(s), fish and wildlife habitat conservation area(s) and buffers are allowed. Representations on this site plan may be approximations only and should not be used for purposes other than for determining general locations of critical areas and buffers. Development activities beyond the scope of this plan may require additional studies and regulatory approvals, including compensatory mitigation.

Site Plan

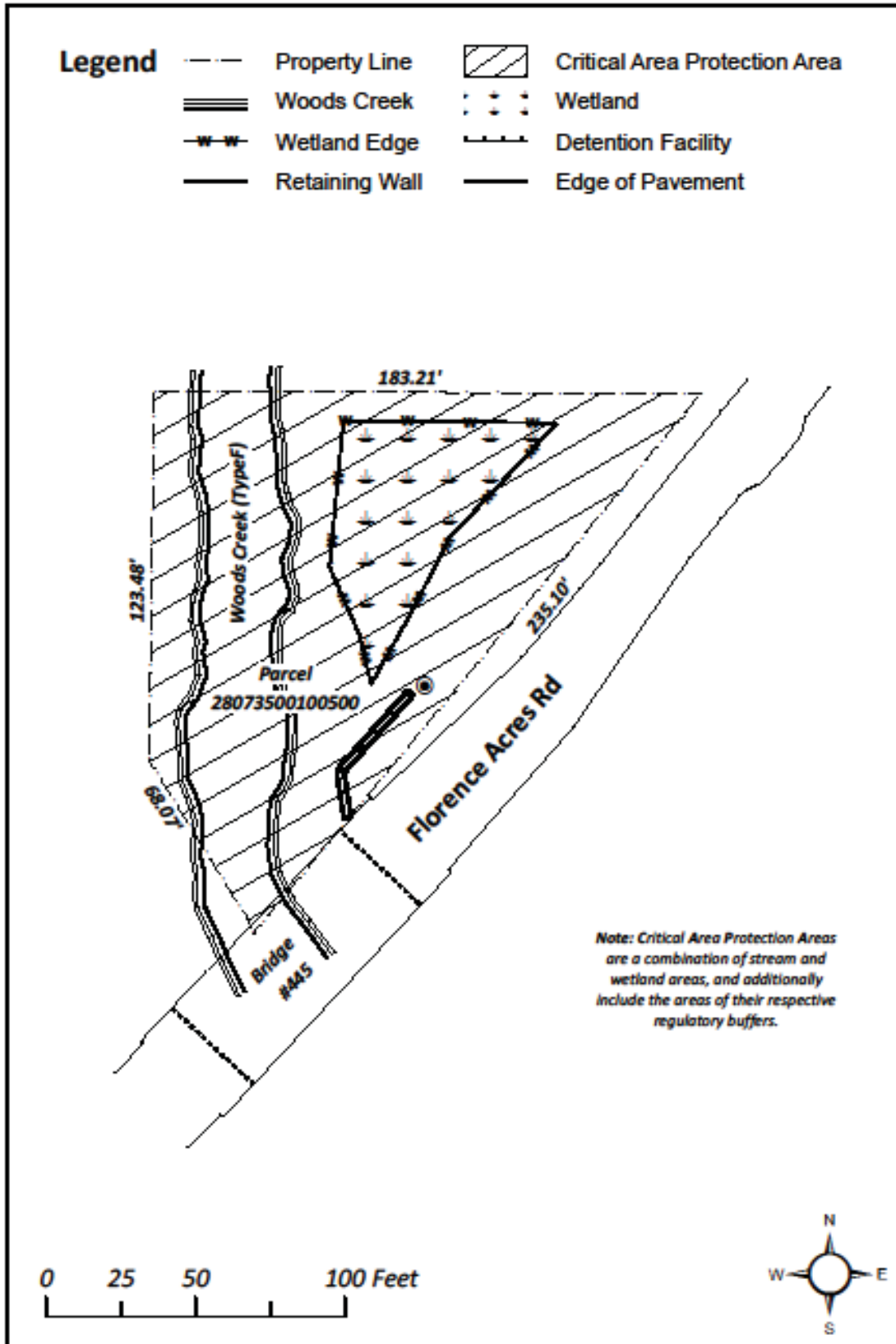

Douglas W McCormick
 Digitally signed by Douglas W McCormick
 Date: 2022.09.28 10:28:39 -07'00'
 APPROVED as compliant with Chapter 30.62A SCC
 Snohomish County Public Works
 Douglas W. McCormick, County Engineer
 Date: August 28, 2022

Klein, Kenneth Klein, Kenneth
 2022.12.16 12:54:26 -08'00'
 APPROVED Ken Klein
 Snohomish County Executive Executive Director
 Date: December 16, 2022