

ANDREW MICHAEL WISE 3/7/77 - 6/1/03	EDYVNA EASTMAN 12/17/46 - 8/1/82	DICK ORVILLE WITHEE 10/23/47 - 12/27/05	EUKT EMERY GESSYER 12/22/45 - 3/14/04	MARTIN A. RAMIREZ 6/22/90 - 1/26/10	RICHARD PAUL ANGEREFF 8/1/34 - 10/26/99	BERT WAYNE BRICKSON 10/22/46 - 8/23/64	MICHAEL JOSEPH LEE 9/11/73 - 12/1/01				
IMOTHY WESLAW WARDENBLO 4/17/81 - 4/28/03	JANE NUNKO HOFFMAN 1/16/22 - 10/7/83	JOSHUA MICHAEL HADGETON 3/25/83 - 12/19/09	SHEENA M. BLAA 12/19/51 - 2/24/10	BUSA KATE OLDER 10/8/81 - 4/10/98	DOUGLAS C. ALLEN 4/18/85 - 9/1/07	JANELLE LOUISA COOPER 10/31/81 - 5/22/08	ESHAU WILLIAM ALDRIDGE 3/24/77 - 8/1/03	JOEY JAY CALAWAN 10/22/87 - 9/29/02			
MATTHEW RUSSELL RIBCO 8/16/83 - 8/29/04	JENNY ANN MCCOLLUM 1/29/31-3-23/03	HEIDI ELIZABETH HUSTON 7/16/81-6/1/90	<div style="border: 1px solid black; padding: 5px; text-align: center;"> <b>SNOWHOMI COUNTY DUI VICTIMS' MEMORIAL WALL</b>             IN LOVING MEMORY OF THOSE WHO HAVE            LOST THEIR LIVES AS A RESULT OF            SOMEONE DRIVING UNDER THE            INFLUENCE OF ALCOHOL OR DRUGS         </div>			JILL MARR SHALIMAN 2/10/90-7/14/92	TY CHRISTOPHER JOHNS 9/1/74-4/1/02	SHAWN FRANCIS ELLIOTT 7/14/86 - 9/27/04			
JEANETTE M. CLINE HANCOCK 1/26/64 - 4/20/07	MICHAEL THOMAS SEANY 2/21/81-3/23/03	MATTHEW PAULS 8/19/72-7/14/90				TRIANE "TRIG" SANDS 10/23/93-04/09/11	SCOTT BRYAN TRAPP 10/24/75-07/29/98	CHRISTOPHER CARL LINDS 12/16/49-10/20/91	ADREY LEONE JONES 9/30/00-4/1/02	MARCO LOPEZ-SILVA 4/25/89 - 3/22/10	
CORY E. SAUCY 4/22/89-8/21/04	WILLIAM ROBERT BRUCE 12/26/62-7/14/90	LAWRENCE CURTIS BRUCE 12/2/69-7/14/90				STAN MORGAN COMBELL 1/20/59-10/31/99	PODER CLARE JONES 10/11/20-10/20/95	SUZANNE MICHELLE JONES 1/14/63-6/1/02			
AARON ROBINSON HARVEY 8/1/82-4/30/06	JULIAN LONDON MOHLER 4/18/83-10/1/97	JENNIFER LEE SHAR 2/10-7/27/14/90	ANNE HAJAMA 04/12/29-06/23/18				MEDIAN LIND SWISS 05/31/80-07/28/11	ROBT SPINCKER COFFINBLY 7/14/82-01/20/89	SUSAN MARR CARLSON 1/20/40-7/4/84	PHILIP LAWRENCE CHILDEN 7/30/62-6/2/85	
JANEL MARY ZARETTI 12/25/63-3/1/93	GAIL KAMPF STORGAN 7/15/16-1/13/40	ONARIE LESTER HOSCHKEIT 9/27/52-1/24/80	BRODIE DANIEL ASERUP 1/20/51 - 10/29/89	MELISSA ANNE AZERUP 11/28/41 - 11/29/09	HILDA MARGARITA WOODS 4/10/27 - 11/29/09	THOMAS JEFFREY WOODS 8/1/25T - 11/29/09	KAMI MAY MORAN 5/28/89-2/18/99	NICHOLE RENEE BISHOP 7/23/82-2/10/05	ALEXANDER ASSAUT BISHOP 6/2/82-10/8/99		
KENNETH GLENN BOODIARY 4/27/34-12/14/90	PAUL FRANCIS WICE 7/2/20-1/22/99	SEAN MICHAEL MEYER 8/20/83-7/16/99	KRISTOFFER SEAN SCHWELER 12/14/82-2/23/99	GIBBYR D. SMITH 02/18/16-12/21/91	DAVID EUGENE THOMPSON 12/31/31-11/20/82	ELLEN ROSE FROTS 08/23/92-04/16/15	ELMER FRANCIS KYNSLAND 2/4/23-4/27/00	JOYCE ELAINE KYNSLAND 8/19/28-6/19/00	THOMAS MCNEILIAN COBA 5/21/21-2/29/04	KYLE LEE OSBERI 7/17/11-12/22/01	
DEON RACHON WOODWARD 1/24/58-8/19/93	JAMES HIBBODD FROST 6/3 - 6/30/1988	DERRELL LARAS CALHOUN 1/18/80-1/24/97	EARL CYCUL BECKER JR. 12/16/32-3/7/87	RYAN LEE BENYON 10/14/87-02/02/18	STEPHAN NICOLE PROFFIT 03/24/89-01/19/12	NICHOLE "NIKI" TERRE DUFFRES 8/10/84-4/4/98	JOSEPH "J.C." ALLEN COFF 7/28/23-12-1-87	DARLEN (D.C.) COFF 12/28/49-12/20/00	DANIEL WAYNE SANDALL 4/25-11/6/2013		
CHARLES DAVID WOODRIF 1/19/52-8/1/03	LOREYNGA HARRIS JONE 8/10/75-6/8/91	JAMES ADAM BROOKMAN 9/24/44-8/9/94	NICHOLE JOHN BOLLER 1/29/62-4/24/78	DAVIA MARY BASTIS 5/26/78-8/20/83	MARGARET ANNA REASER 04/28/22-04/28/87	DAVID EDWARD SWEARINGEN 6/18/56-8/19/98	KARLE FRANK HOFFERBERGER 8/1/40-10/5/02	KRYSTAL MARR YORK 10/10/23-1/1/97	WILLIAM DONALD GARDIN 2/18/74-8/2/01	JEFFREY TODD FELIX 11/30/72-11/20/79	
JANEL MARY COLE JR. 2/10/51-8/1/98	SEAN WARREN ENDLEY 10/24/62-11/5/87	CARY GALE FORBUSH 12/2/52-10/18/89	LEE PENNAU 3/30/42-3/16/89	ROBERT BOSS HARBONY 1/18-4/23/70	DONALD ALASTAIR WANDER 8/25/34-8/21/77	ERIC MARTIN THORNQUEST 9/4/22-8/21/92	ADAM WARREN SINGLETON 8/12/79-6/2/98	GREGORY T. AUST AU 3/28/1951-8/1/95	SHANNON MARR CHAVEZ 8/17/69-6/26/95	DENNIS MICOLE MOORE 09/10/51-04/16/18	
PETE JOHN SHON 12/02/58-09/28/08	COFFY ALLEN HAPKINS 3/19/49-8/13/08	ORLAND TYNNE HUSTON 8/27/19/30-11/7/94	ANTONIA LEE KELLER 4/4/58-6/6/92	LAURENCE LENTINE 8/21/47-8/20/98	RADD ALLEN WACHS 10/24-4/20/72	CELIE JOYCEM HATHORN 3/18/25-7/22/72	DAVID MARK LAIBOTS 4/24/34-9/27/76	AUD'S EIDE EASTMAN 1/20/47-4/30/83	BETTY JANE MOOD 3/28/20-10/19/82	DENNIS MICOLE MOORE 09/10/51-04/16/18	
ANITA JOHNSON 10-10/2004-10-11/2017	STEPHEN JON MOORE 6/19-87-7/8/78	DONALD RAY HUBBIE 4-18/54-8/4/78	JOANNA MARIE KACERA 8/1/45-7/20/82	CARLE DONNIEY LINDHARTE 2/23/79-10/24/01	MARGARET ANNE SPIZ 10/30/25-02/1/02	MURIEL ANN GRYTON 8/12/34-7/27/82	ANTHONY RAYNE BARRIERS 8/15/42-8/8/00	JAMES T. JENSON 02/08-1987-03-1-2013			
MADE POSSIBLE BY DONATIONS BY SNOWHOMI COUNTY DISTRICT COURT -LIVERT DIVISION, AND VIA TRAFFIC SAFETY COMMISSION	ANNIE CAROLE BROOK JR 6/12/43-3/3/81	RONALD JAY LINDRO 12/20/57-9/2/79	FREDA HOBAMA BROWN 11-17-28-9-9-89	JEFFREY CRYSTIAN BROWN 8/1/81-12/5/02	BARRY DELVIN BUCKNER 8/2/42-3/27/84	MURIEL ANN SCHWARTZ 3/24/1915-7/27/82	BEARNOON L. BING 11/08/1987-07/01/2019				
		YOGG E. FROTS 7/16/63-3/1/81	SHAWNEEL COUGHEN 8/27/89-8/30/00	R. CRAIG WOOD 7/23/34-4/20/00	JAMES DOUGLAS MALVERN 7/4/31-3/24/94	JUDITH ANN HUNTER 1/32/43-7/7/95					
		TRACY LEE GREGAN 8/25-8/18-2/01	FANDY LEE MURIEL 9/29/21-6/14/84	ROONEY DANIEL KELLY 12/31/40-11/4/86				SPONSORED BY SNOWHOMI COUNTY DISTRICT COURT			
		AMBER LEE LINDRO 03/21/95-02/1/94							DICKIE JEAN M. ...		





# METAL GRID, MOISTURE CONTROL SYSTEM (MCS)

The Brick-It™ Moisture Control System (MCS) is the only system in the world that was especially designed to answer all moisture concerns and for which was awarded a US & Canada Patent. Brick-It™ MCS is the best way to install exterior thin brick because the metal grid was designed to:

- Brick It MCS system is the only thin brick veneer installation system that was awarded US Patent for its water and moisture drainage capabilities.
- High impact drainage mat provides rapid exit for water which is naturally absorbed by brick.
- Create perfectly aligned brick veneer every time, and the interlocking feature and structural panel shape provides equal weight distribution of the bricks, reinforces the building corners and gives additional support to the wall itself.
- Offset panel weep holes redirect 100% of water every 8 inches (vertically) from the front to the back of the panel.
- Drainage mat drains the water and keeps it free air flow between the veneer and the wall.
- Compartmentalized channels promote pressure equalization.
- Rectangular weep holes punched from the front of the panel assure that water goes in to it and not around it.

## COMPLETE SYSTEM

**Moisture Control Panel (MCS)** is now available to accommodate all thin brick sizes; 2 1/4" H (Modular, Standard, Norman, Saxon), 2 1/2" H (Modified Standard, Modified Norman), 2 5/8" H (Queen) 2 3/4" (King, Kingston), 3 5/8" H (Closure/Econo, Utility, Titan), 7 5/8" H (8-Square, Double Utility).

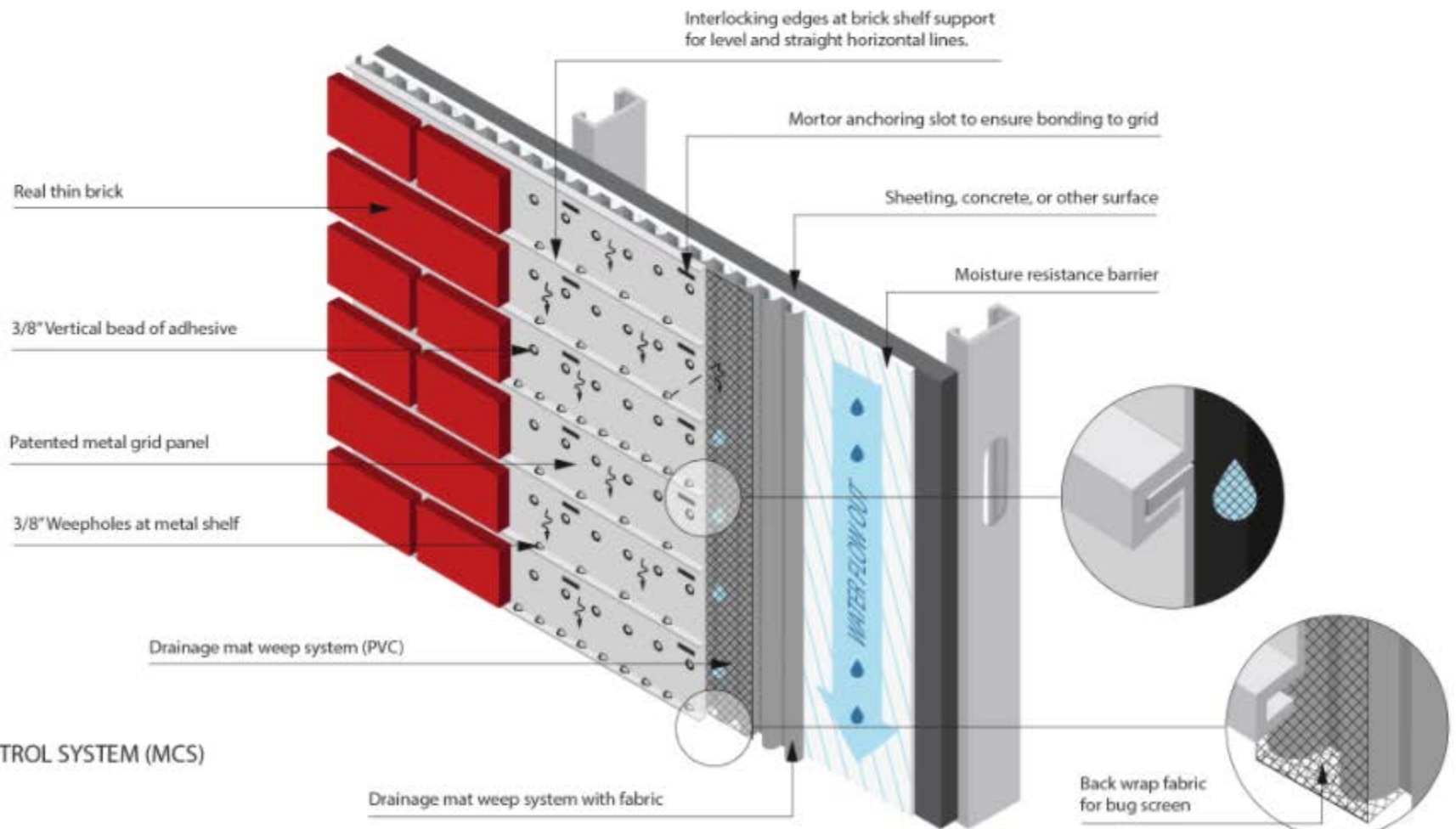

**BRICK - IT™**  
MOISTURE CONTROL SYSTEM (MCS)

