

SNOHOMISH COUNTY COUNCIL
Snohomish County, Washington

MOTION NO. 22-294

APPROVING AND AUTHORIZING THE COUNTY EXECUTIVE
TO EXECUTE CRITICAL AREA SITE PLANS

WHEREAS, in the 2022 CIP the Snohomish County Council approved construction of the Kayak Point Day Use Renovation project; and

WHEREAS, in order to construct the project, a Critical Area Report (April 2022) was required, and the report called for designated protection sites that would be left permanently undisturbed in a substantially natural state; and

WHEREAS, a portion of the project property was chosen for habitat protection adjacent to the shoreline habitat enhancement areas; and

WHEREAS, in order to permanently protect the properties, Critical Area Site Plans are required to be approved by the Snohomish County Council and recorded with the Snohomish County Auditor;

NOW, THEREFORE, ON MOTION, the Snohomish County Council approves and authorizes the Snohomish County Executive to sign and execute the Critical Area Site Plans as attached hereto and incorporate by reference herein.

PASSED this 17th day of August, 2022.

SNOHOMISH COUNTY COUNCIL
Snohomish County, Washington



Council Chair

ATTEST:



Asst. Clerk of the Council

Return Address: Snohomish County
Parks and Recreation Division
6705 PUGET PARK DRIVE
SNOHOMISH, WA 98296

CRITICAL AREA SITE PLAN

Project #:	21118694-LDA
Applicant:	Snohomish County
Site Address:	15711 Marine Dr, Stanwood, WA 98292
Tax Acct. #:	310325-004-001-00
REFERENCE NUMBER(S) OF RELATED DOCUMENTS: 310336-001-001-00 1 of <u>2</u>	
GRANTOR(S) (OWNERS OF PROPERTY):	
<u>Snohomish County</u>	
LAST NAME	FIRST NAME MI
GRANTEE(S): SAME AS ABOVE:	

Legal Description:

Section 25 Township 31 Range 03 Quarter SE - S 18AC GOVT LOT 4 & 2ND CLASS TDLNS ADJ THRTO EXC CO RD R/W & ANY PART OF PLAT OF C. D. HILLMAN'S BIRMINGHAM WF ADD TO COE AT PORT SUSAN ON PUGET SOUND DIV 2 & EXC BAAP ON S SEC LN 368.78FT OF FRAC COR TH N 360FT TO PT DESIG AS "A" TH N 40FT TPB TH E 69.90FT TH SW TO PT 39.40FT E OF PT "A" TH W 39.40FT TO PT "A" TH TO PTN N02*12 00W 360FT FR PT ONSEC LN 370.20FT E OF FRAC COR TH W PLT S SEC LN 120FT M/L TO SHR PORT SUSAN BAY TH N THON TO PT W OF TPB TH E TO TPB & 2ND CLASS TDLNS ADJ THRTO TO SNO CO - N SALTWATER REGIONAL PK 1972 \$10.00 V651P399 REGIONAL PK

Additional legal description is on page ____ of document

In consideration of Snohomish County Code requirements, except as otherwise provided herein, the CAPA (Critical Area Protection Area) shall be left permanently undisturbed in a substantially natural state.
Exceptions: The following are allowed in CAPAs: Existing legally established uses and structures (see site plan); Non-ground disturbing interior or exterior building improvements; routine landscape maintenance of established, ornamental landscaping; non ground disturbing normal maintenance or repair; removal of noxious weeds conducted in accordance with chapter 16-750 WAC; maintenance or replacement that does not expand the affected area of the following existing facilities: (a) septic tanks and drainfields; (b) wells; (c) individual utility service connections; data collection by non-mechanical means, and non-mechanical survey and monument placement.

Applicant: Snohomish County
 Project #: 21118694-LDA
 Tax Acct. #: 310325-004-001-00

SITE PLAN:

2 OF 2

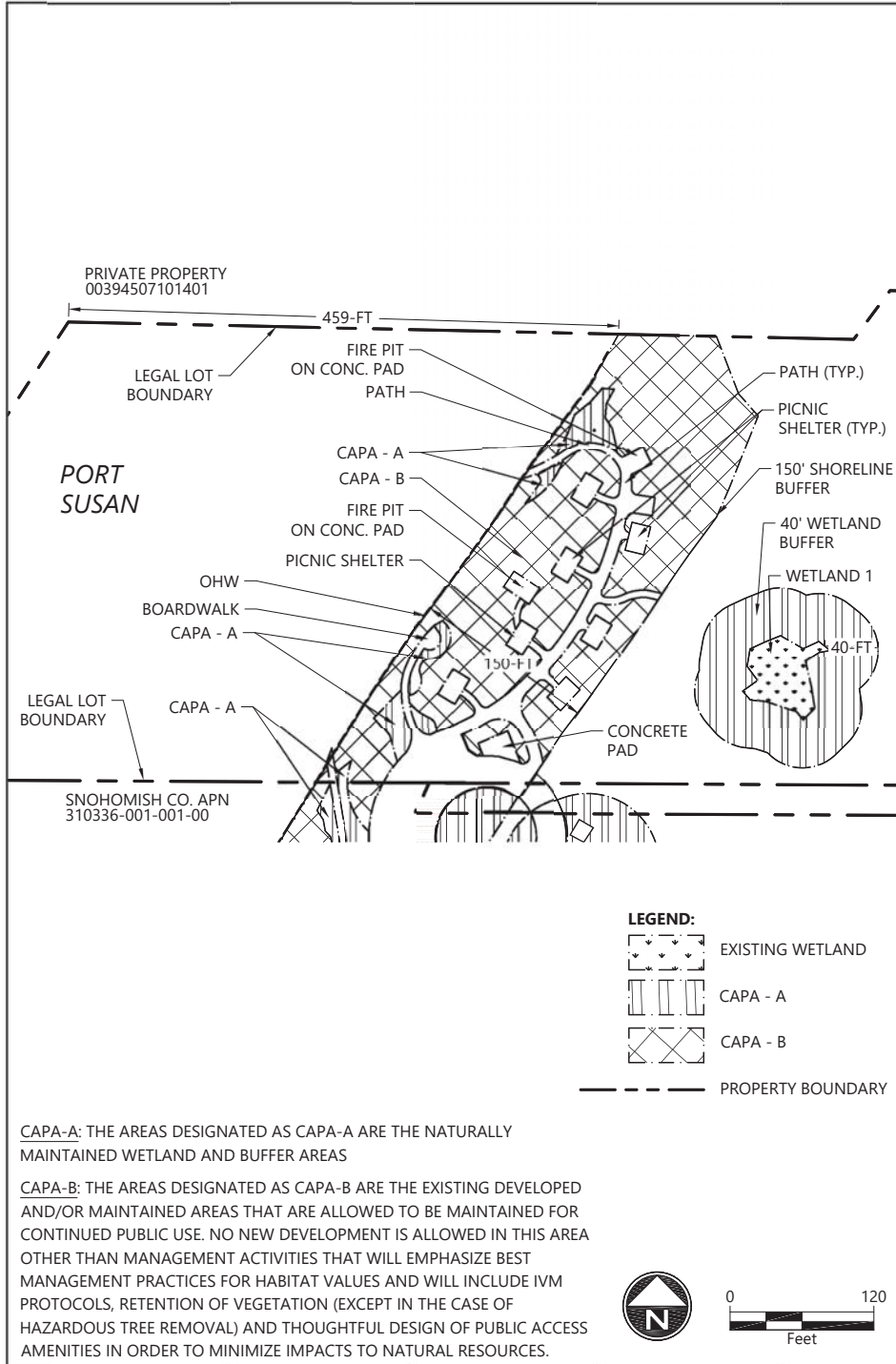

Representation on this site plan may be approximations only and should not be used for purposes other than for determining general locations of critical areas and buffers.

Erin Harker 07/05/2022 Lacey Harper Digitally signed by Lacey Harper
 APPROVED SNOCO PDS DATE OWNER(S) Date: 2022.08.18 09:07:08 -07'00' DATE

Return Address: Snohomish County
Parks and Recreation Division
6705 PUGET PARK DRIVE
SNOHOMISH, WA 98296

CRITICAL AREA SITE PLAN

Project #:	21118694-LDA
Applicant:	Snohomish County
Site Address:	15711 Marine Dr, Stanwood, WA 98292
Tax Acct. #:	310336-001-001-00
REFERENCE NUMBER(S) OF RELATED DOCUMENTS: 310325-004-001-00 1 of <u>4</u>	
GRANTOR(S) (OWNERS OF PROPERTY):	
<u>Snohomish County</u>	
LAST NAME	FIRST NAME MI
GRANTEE(S): SAME AS ABOVE:	

Legal Description:

SEC 36 TWP 31 RGE 03TH PTN SEC 36-31-3 TGW ADJ TDLNDS OF 2ND CLASS LY WHN FDP BAAP WH BEARS N00*57 17E 25FT & N89*02 43W 814.92FT FRE1/4 COR SEC 36 SD POB BEING ON NLY R/W LN 148TH ST NW AKA ROWLAND AVE TH ALG SDNLY R/W LN N89*02 43W 400FT TH N19*31 38E 218.02FT TH N27*15 11W 921.70FT TH N59*15 12W 1106.56FT TH N25*02 37E 1110.38FT TH N25*02 37E 388.54FT TH S88*35 48E 249.21FT TH N36*49 50E 50.76FT AAP ON NLY LN OF S 18 ACS GOVT LOT 4 SEC25-31-3 TH S89*03 03E 1287.94FT TAP ON GENERAL WLY LN OF 60FT WIDE RD R/W TH ALG SD WLY LN S31*51 46W 459.58FT THN89*00 00W 71.59FT TH S01*06 06W 120.15 FT TO INT SD WLY R/W LN TH ALG SD WLY LN S31*51 46W 22.38FT TANG TO PRECEDING CRSE ALG ARC OF CRV TO L HAVG RAD OF 1175.92FT & C/A OF 59*04 37 AN ARC LENGTH OF 1212.48FT TANG TO PRECEDING CRV S27*12 51E 701.44FT TAP THON TH LEAVING SD WLY LN S62*47 09W 492.96FT TH S01*09 25W 432.57FT TO POBTGW TH PTN OF 94TH AVE NW (FKA FIRST AVE) VAC PER COMM REC'S VOL 44 PG 565 SEPT 1963 NORTH SALTWATER REGIONAL PARK.



Additional legal description is on page ____ of document

In consideration of Snohomish County Code requirements, except as otherwise provided herein, the CAPA (Critical Area Protection Area) shall be left permanently undisturbed in a substantially natural state. Exceptions: The following are allowed in CAPAs: Existing legally established uses and structures (see site plan); Non-ground disturbing interior or exterior building improvements; routine landscape maintenance of established, ornamental landscaping; non ground disturbing normal maintenance or repair; removal of noxious weeds conducted in accordance with chapter 16-750 WAC; maintenance or replacement that does not expand the affected area of the following existing facilities: (a) septic tanks and drainfields; (b) wells; (c) individual utility service connections; data collection by non-mechanical means, and non-mechanical survey and monument placement.

Applicant: Snohomish County
Project #: 21118694-LDA
Tax Acct. #: 310336-001-001-00

SITE PLAN:

2 OF 4

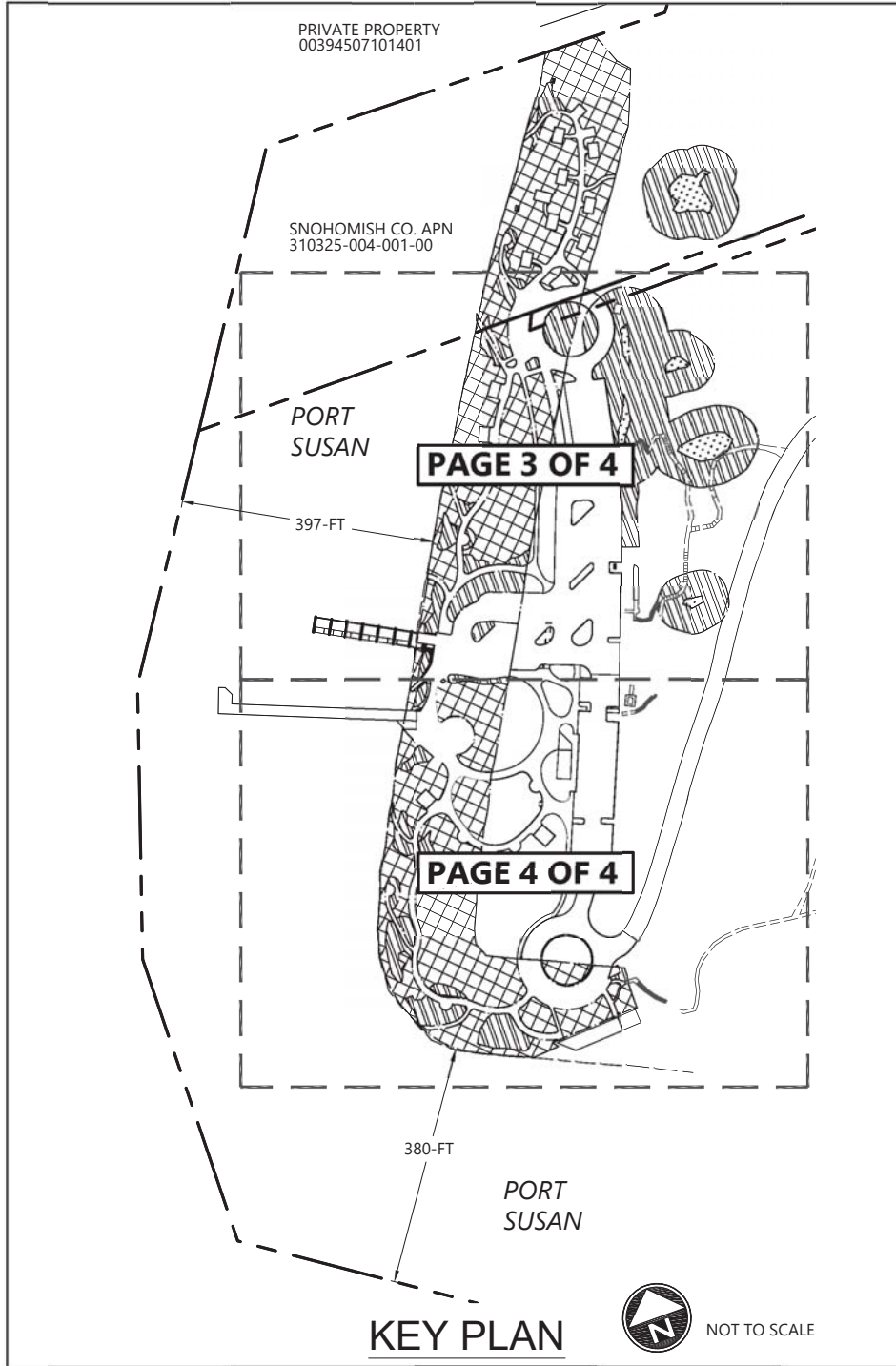

Representation on this site plan may be approximations only and should not be used for purposes other than for determining general locations of critical areas and buffers.

Erin Harker 07/05/2022 DATE APPROVED SNOCO PDS

Lacey Harper Digitally signed by Lacey Harper Date: 2022.08.18 09:08:20 -0700' OWNER(S)

DATE

Applicant: Snohomish County
 Project #: 2118694-LDA
 Tax Acct. #: 310336-001-001-00

SITE PLAN:

3 OF 4

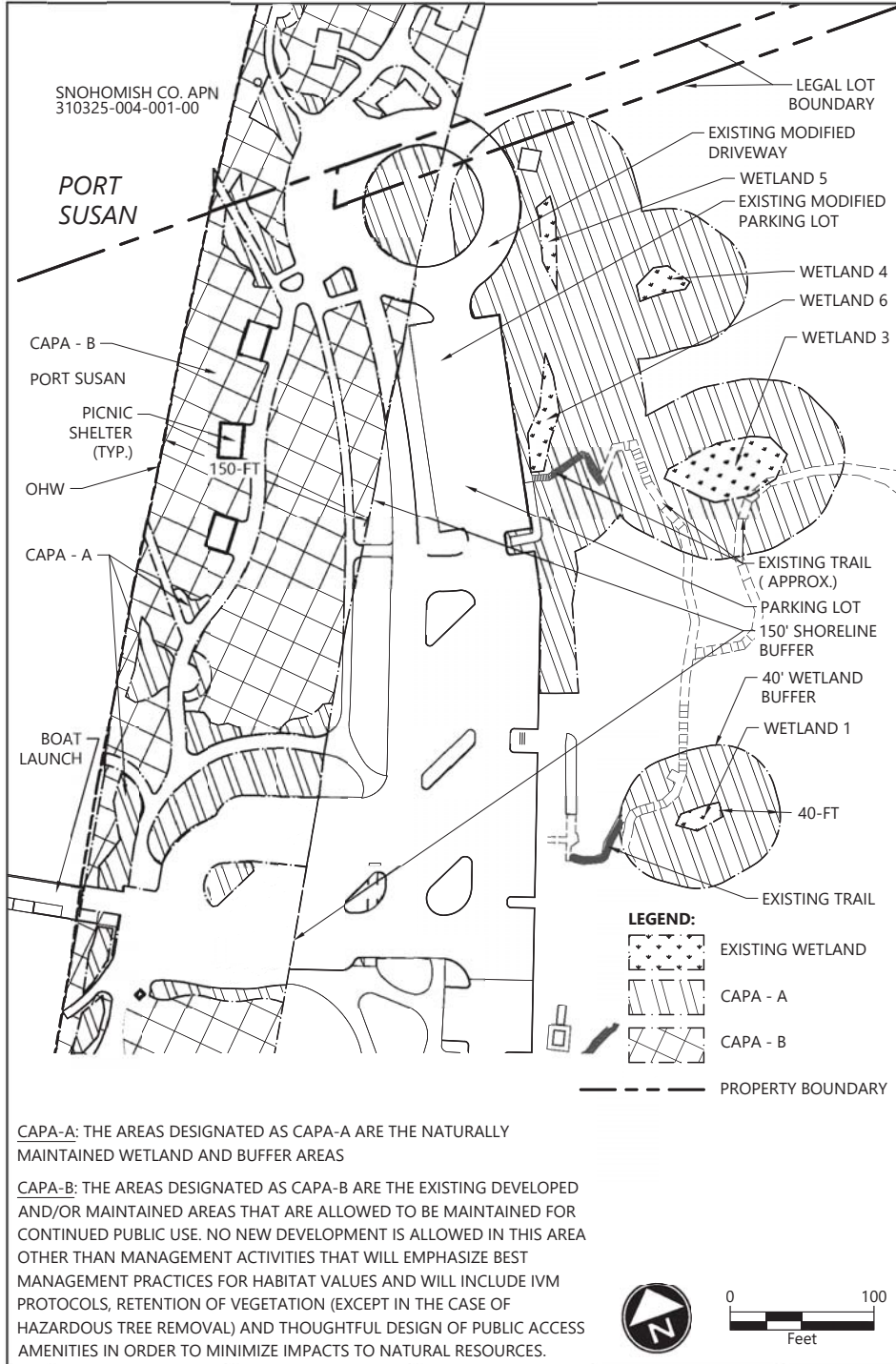

Representation on this site plan may be approximations only and should not be used for purposes other than for determining general locations of critical areas and buffers.

Erin Harker 07/05/2022 DATE APPROVED SNOCO PDS
 Lacey Harper 09/10/25 07:00' DATE OWNER(S)
Digitally signed by Lacey Harper Date: 2022.08.18

Applicant: Snohomish County
 Project #: 21118694-LDA
 Tax Acct. #: 310336-001-001-00

SITE PLAN:

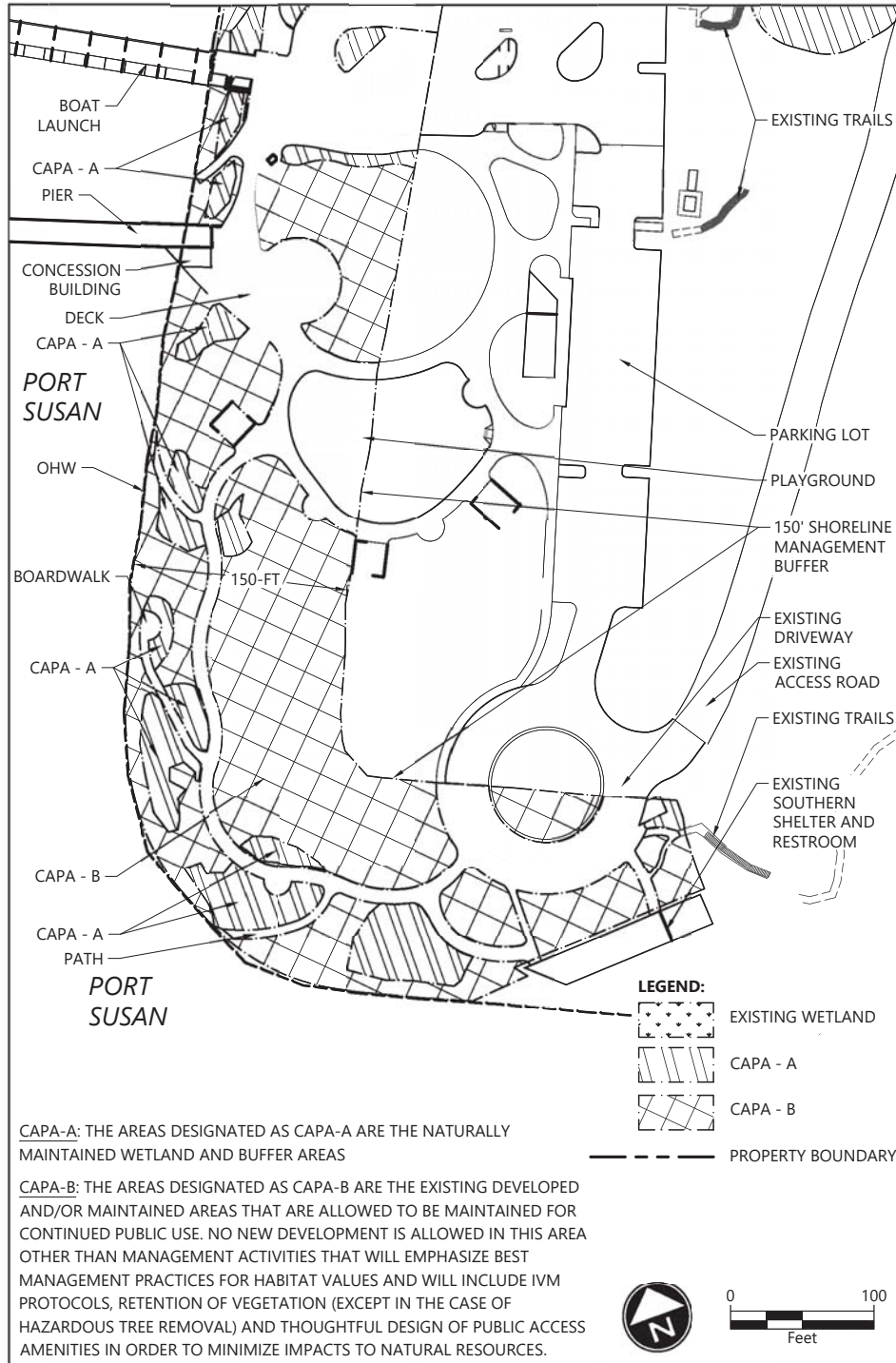

Representation on this site plan may be approximations only and should not be used for purposes other than for determining general locations of critical areas and buffers.

Erin Harker 07/05/2022 DATE APPROVED SNOCO PDS
 Lacey Harper 09-18-02 -07'00" DATE OWNER(S)
Digitally signed by Lacey Harper Date: 2022.08.18 09:18:02 -07'00'