

Return Address: Snohomish County  
Parks and Recreation Division  
6705 PUGET PARK DRIVE  
SNOHOMISH, WA 98296

## CRITICAL AREA SITE PLAN

Project #:	21118694-LDA
Applicant:	Snohomish County
Site Address:	15711 Marine Dr, Stanwood, WA 98292
Tax Acct. #:	310336-001-001-00
REFERENCE NUMBER(S) OF RELATED DOCUMENTS: 310325-004-001-00 1 of <u>4</u>	
GRANTOR(S) (OWNERS OF PROPERTY):	
<u>Snohomish County</u>	
LAST NAME	FIRST NAME MI
GRANTEE(S): SAME AS ABOVE:	

### Legal Description:

SEC 36 TWP 31 RGE 03TH PTN SEC 36-31-3 TGW ADJ TDLNDS OF 2ND CLASS LY WHN FDP BAAP WH BEARS N00\*57 17E 25FT & N89\*02 43W 814.92FT FRE1/4 COR SEC 36 SD POB BEING ON NLY R/W LN 148TH ST NW AKA ROWLAND AVE TH ALG SDNLY R/W LN N89\*02 43W 400FT TH N19\*31 38E 218.02FT TH N27\*15 11W 921.70FT TH N59\*15 12W 1106.56FT TH N25\*02 37E 1110.38FT TH N25\*02 37E 388.54FT TH S88\*35 48E 249.21FT TH N36\*49 50E 50.76FT AAP ON NLY LN OF S 18 ACS GOVT LOT 4 SEC25-31-3 TH S89\*03 03E 1287.94FT TAP ON GENERAL WLY LN OF 60FT WIDE RD R/W TH ALG SD WLY LN S31\*51 46W 459.58FT THN89\*00 00W 71.59FT TH S01\*06 06W 120.15 FT TO INT SD WLY R/W LN TH ALG SD WLY LN S31\*51 46W 22.38FT TANG TO PRECEDING CRSE ALG ARC OF CRV TO L HAVG RAD OF 1175.92FT & C/A OF 59\*04 37 AN ARC LENGTH OF 1212.48FT TANG TO PRECEDING CRV S27\*12 51E 701.44FT TAP THON TH LEAVING SD WLY LN S62\*47 09W 492.96FT TH S01\*09 25W 432.57FT TO POBTGW TH PTN OF 94TH AVE NW (FKA FIRST AVE) VAC PER COMM REC'S VOL 44 PG 565 SEPT 1963 NORTH SALTWATER REGIONAL PARK.



Additional legal description is on page \_\_\_\_ of document

In consideration of Snohomish County Code requirements, except as otherwise provided herein, the CAPA (Critical Area Protection Area) shall be left permanently undisturbed in a substantially natural state.  
**Exceptions:** The following are allowed in CAPAs: Existing legally established uses and structures (see site plan); Non-ground disturbing interior or exterior building improvements; routine landscape maintenance of established, ornamental landscaping; non ground disturbing normal maintenance or repair; removal of noxious weeds conducted in accordance with chapter 16-750 WAC; maintenance or replacement that does not expand the affected area of the following existing facilities: (a) septic tanks and drainfields; (b) wells; (c) individual utility service connections; data collection by non-mechanical means, and non-mechanical survey and monument placement.

Applicant: Snohomish County  
Project #: 21118694-LDA  
Tax Acct. #: 310336-001-001-00

SITE PLAN:

2 OF 4

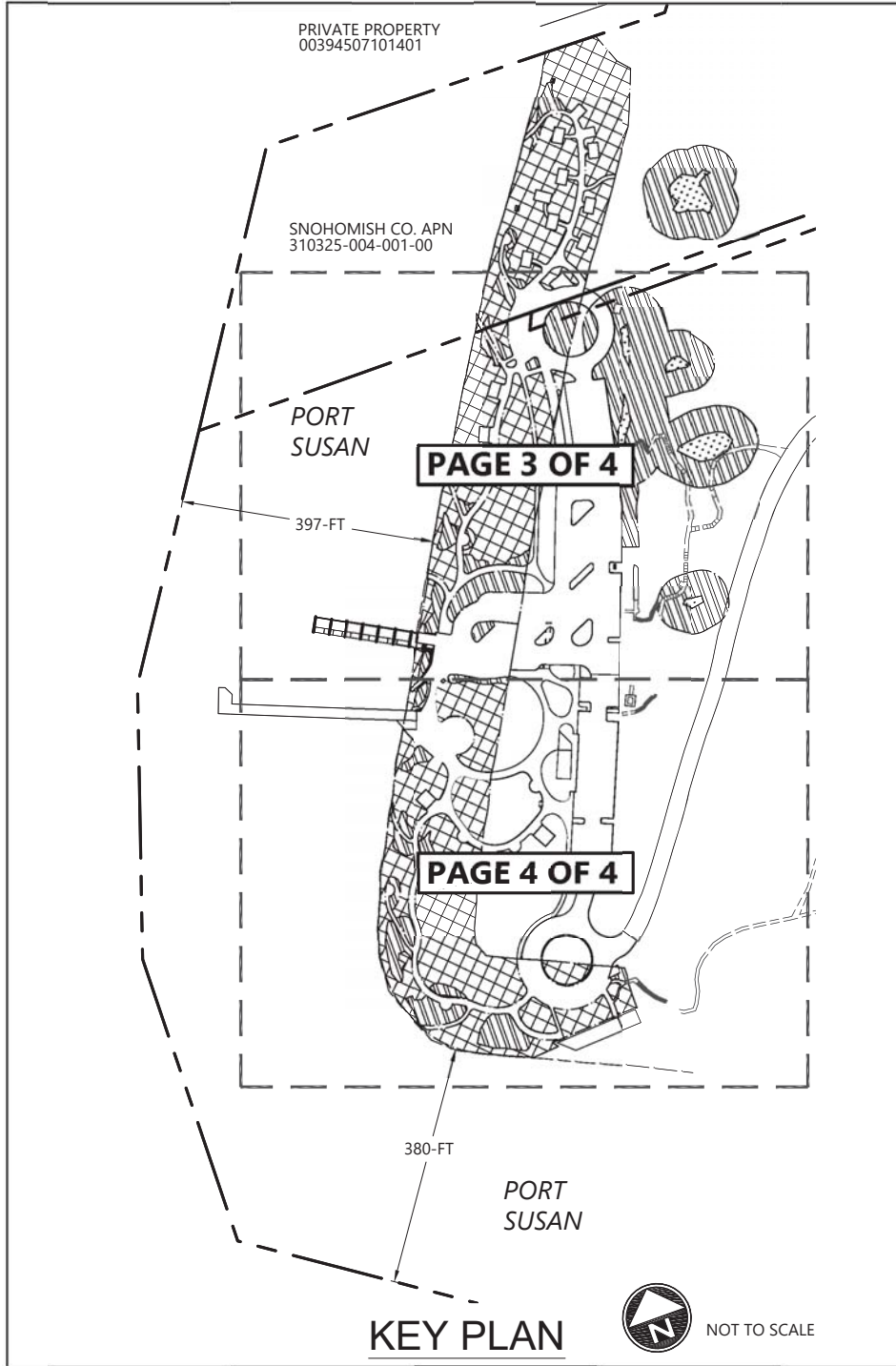

Representation on this site plan may be approximations only and should not be used for purposes other than for determining general locations of critical areas and buffers.

Erin Harker 07/05/2022 DATE APPROVED SNOCO PDS

Digitally signed by Lacey Harper  
Harper Date: 2022.08.18  
09:08:20 -0700'

Lacey Harper OWNER(S)

DATE

Applicant: Snohomish County  
 Project #: 2118694-LDA  
 Tax Acct. #: 310336-001-001-00

SITE PLAN:

3 OF 4

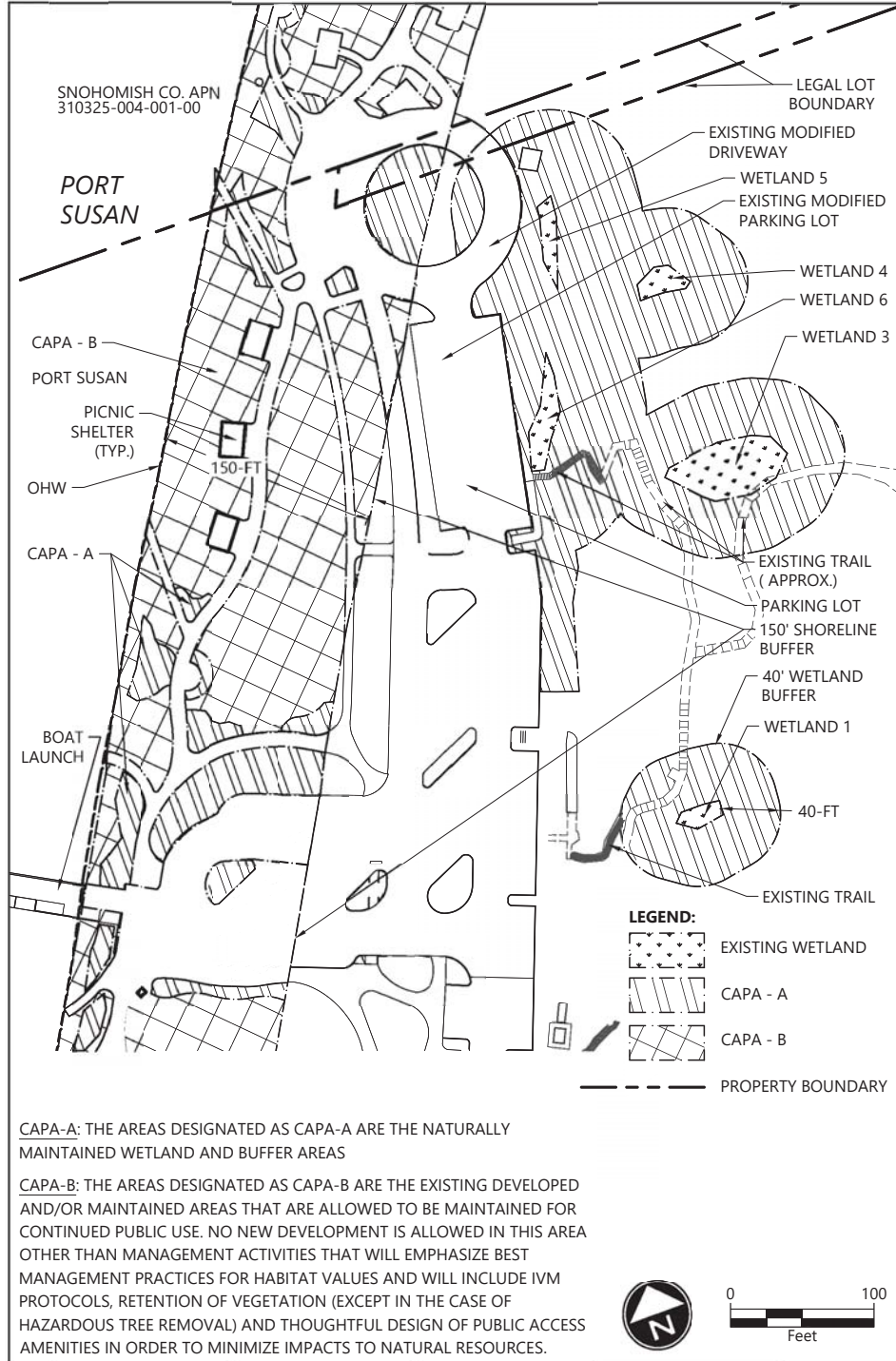

Representation on this site plan may be approximations only and should not be used for purposes other than for determining general locations of critical areas and buffers.

*Erin Harker* 07/05/2022 DATE APPROVED SNOCO PDS  
 Lacey Harper 09/10/25 07:00' DATE OWNER(S)  
Digitally signed by Lacey Harper Date: 2022.08.18 09:10:25 -07'00'

Applicant: Snohomish County  
 Project #: 21118694-LDA  
 Tax Acct. #: 310336-001-001-00

SITE PLAN:

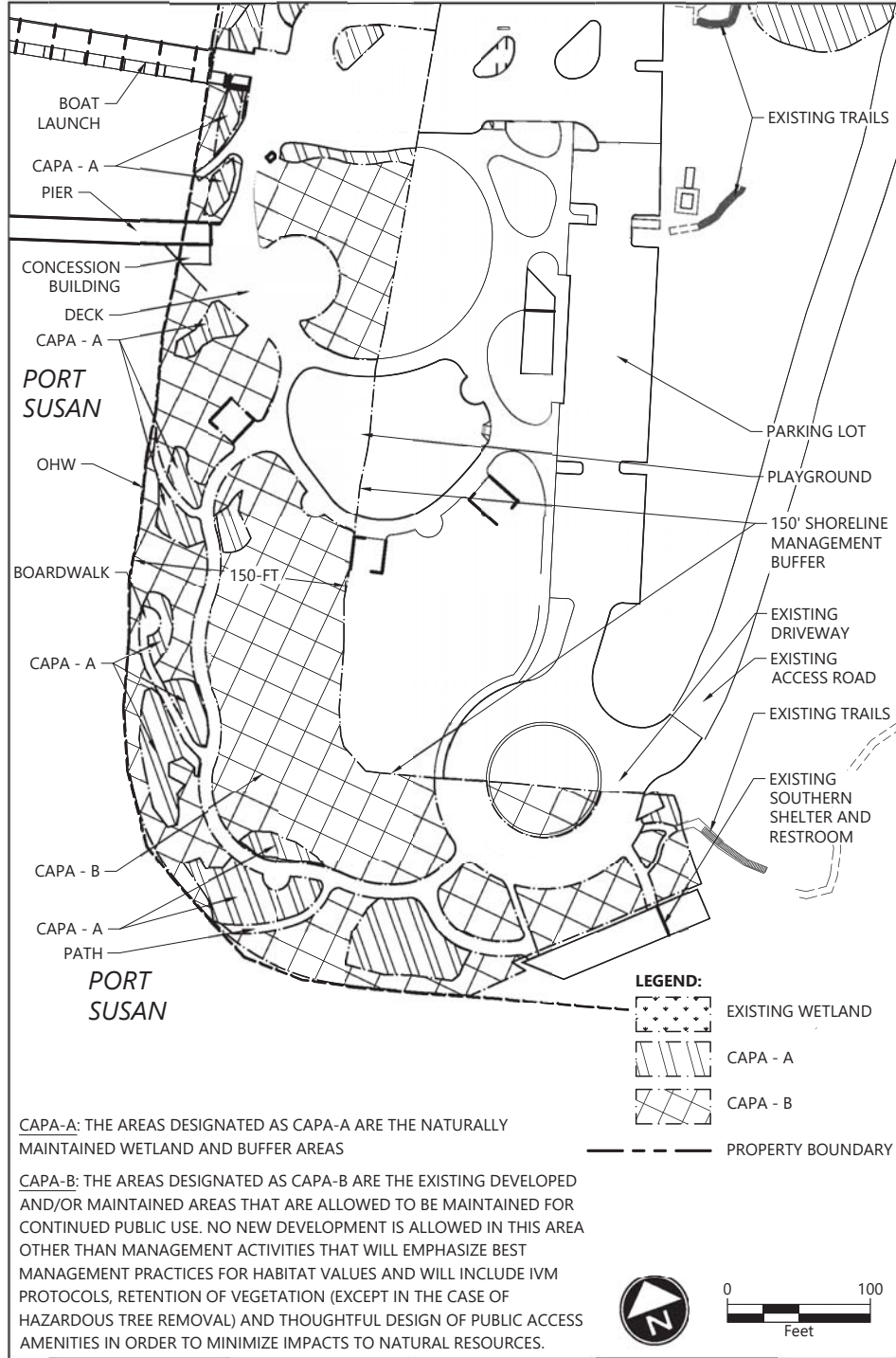

Representation on this site plan may be approximations only and should not be used for purposes other than for determining general locations of critical areas and buffers.

*Erin Harker* 07/05/2022 DATE APPROVED SNOCO PDS  
 Lacey Harper 09-18-02 -07'00" DATE OWNER(S)  
Digitally signed by Lacey Harper Date: 2022.08.18 09:18:02 -07'00'