

RECEIVED
NOV 01 2022

Change of Classification
(Chapters 84.33 and 84.34 RCW)

Tax Code: _____
County: _____ ASSESSOR'S OFFICE
CSC

File With County Assessor

Applicant(s) name and address:

Myron Friesen
Jennifer Swaim

Phone No: (425) 273-8844 ; (425) 749-6753

Assessor's Parcel or Account No:

27061700303000

Auditor's File No. on original application:

ptn 9812150519

Land subject to this application (legal description):

SEC 17 TWP 27RGE 06LOT 4 OF PFN 94-321585P
REC AF NO 9704175002 BEING PTN OF
NE1/4 SW1/4 SW1/4 + E1/2 NW1/4 SW1/4

Change of Classification
(Check appropriate box)

The land is currently classified as Farm and Agricultural land under RCW 84.34.020(2) and I hereby request reclassification as:

- Timber land as provided under RCW 84.34.020(3), unless county has merged their timber land classification into their designated forest land program. (Attach completed form REV 64 0109 or 64 0111 and a timber-management plan)
- Open Space land as provided under RCW 84.34.020(1). (Attach completed form REV 64 0021)
- Forest Land classification under Chapter 84.33 RCW. (Attach completed form REV 62 0021 or 62 0110)
- Farm and Agricultural Conservation land as defined in RCW 84.34.020(8)(a). (Attach completed form REV 64 0021)

The land is currently classified as Farm and Agricultural Conservation land under RCW 84.34.020(8)(a) and I hereby request reclassification to:

- Farm and Agricultural land under RCW 84.34.020(2). (Attach completed form REV 64 0024 or 64 0108)

The land is currently classified as Timber land under RCW 84.34.020(3) and I hereby request reclassification as:

- Forest land classification under Chapter 84.33 RCW. (Attach completed form REV 62 0021 or 62 0110)
- Open Space land as provided under RCW 84.34.020(1). (Attach completed form REV 64 0021)
- Farm and Agricultural land as provided under RCW 84.34.020(2). (Attach completed form REV 64 0024 or 64 0108)

NOTE: If request to change classification is approved, no additional tax, interest, and penalty will be imposed.

Requests to transfer from Forest Land designation under provisions of Chapter 84.33 RCW to Current Use classification under Chapter 84.34 RCW should be made on REV 64 0038.

Attachment:

- REV 62 0021
- REV 62 0110
- Timber Management Plan
- REV 64 0021
- REV 64 0024
- REV 64 0108
- REV 64 0109
- REV 64 0111

REV 64 0060e (w) (6/5/14)

OPEN SPACE
Assessor's
Application No.
3249

General Information

RECLASSIFICATIONS are defined in RCW 84.34.070(2) as follows:

- (2) The following reclassifications are not considered withdrawals or removals and are not subject to additional tax under RCW 84.34.108:
 - (a) Reclassification between lands under RCW 84.34.020(2) and (3);
 - (b) Reclassification of land classified under RCW 84.34.020(2) or (3) or Chapter 84.33 RCW to open space land under RCW 84.34.020(1);
 - (c) Reclassification of land classified under RCW 84.34.020(2) or (3) to forest land classified under Chapter 84.33 RCW; and
 - (d) Reclassification of land classified as open space land under RCW 84.34.020(1)(c) and reclassified to farm and agricultural land under RCW 84.34.020(2) if the land had been previously classified as farm and agricultural land under RCW 84.34.020(2).
- (3) Applications for reclassification shall be subject to applicable provisions of RCW 84.34.035, 84.34.037, 84.34.041, and Chapter 84.33 RCW.
- (4) The income criteria for land classified under RCW 84.34.020(2)(b) and (c) may be deferred for land being reclassified from land classified under RCW 84.34.020(1)(c) or (3), or Chapter 84.33 RCW into RCW 84.34.020(2)(b) or (c) for a period of up to five years from the date of reclassification.

FARM AND AGRICULTURAL CONSERVATION LAND is defined in RCW 84.34.020(8)(a & b) as follows:

- (8) "Farm and agricultural conservation land" means either:
 - (a) Land that was previously classified under RCW 84.34.020(2), that no longer meets the criteria and is reclassified under RCW 84.34.020 (1)(c); or
 - (b) Land that is traditional farmland that is not classified under Chapter 84.33 or 84.34 RCW, that has not been irrevocably devoted to a use inconsistent with agricultural uses, and that has a high potential for returning to commercial agriculture.

And also defined in RCW 84.34.037(2)(c) as follows:

- (c) Whether granting the application for land applying under RCW 84.34.020(1)(c) will; (i) preserve land previously classified under RCW 84.34.020(2) or preserve land that is traditional farmland and not classified under Chapter 84.33 or 84.34 RCW; (ii) preserve land with a potential for returning to commercial agriculture; and (iii) affect any other factors relevant in weighing benefits to the general welfare of preserving the current use of property.

Signatures of Owner(s) or Contract Purchaser(s):

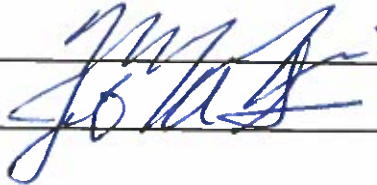

Date 10-30-2027

Assessor Use Only

If the parcel(s) subject to this document is considered contiguous, as defined in RCW 84.34.020(6), with other parcels having different ownerships, verify all remaining classified parcels with different ownerships are still:

- Adjoining
- Being managed as part of a single operation
- Meeting the definition of "family" as defined in RCW 84.34.020(6)(b)(ii) with the owner of an adjoining parcel

To ask about the availability of this publication in an alternate format for the visually impaired, please call 1-800-647-7706. Teletype (TTY) users may use the Washington Relay Service by calling 711. For tax assistance, call (360) 534-1400.



Snohomish County

PLANNING & DEVELOPMENT SERVICES

3000 Rockefeller Avenue, Everett, WA 98201-4046

M/S #304

OPEN SPACE GENERAL CHECKLIST

The Snohomish County Department of Planning & Development Services reviews all applications for OPEN SPACE GENERAL and REQUIRES the following information be submitted with each application:

1. A completed application with the signatures of all persons having an interest in the property.
2. The legal description (s) and Snohomish County property tax number (s).
3. The completed OPEN SPACE CRITERIA enclosed with the application packet. Read the document and check any items that pertain or describe the property. Additional information and pictures are also useful.
4. A map or drawing of the property, showing placement of streams, buildings of all kinds, roads, wooded areas, swamp areas, etc. A map sheet is provided with the application package.
5. A copy of any lease or agreement that would permit uses other than the present use.
6. A non-refundable application fee of \$500.00. Checks may be made payable to the Snohomish County Assessor's Office.

WITHOUT ALL OF THIS INFORMATION AND THE APPLICATION FEE, THE APPLICATION CANNOT BE PROCESSED.

PERFORMANCE STANDARDS AND CHANGES OF USE FOR SPACE GENERAL

- Developed portions of a property are generally not eligible for Open Space General Classification. Exceptions to this include, but are not limited to: outdoor recreational facilities, interpretive centers, outdoor displays, ETC.,
- Lands, which have been granted Open Space General Classification, must remain in a natural, undeveloped state and/or provide the features for which the classification was granted.
- Subdivision and/or development of property may result in revocation of the classification. Failure to meet the intent of the classification criteria and standards or any conditions of the approval will result in revocation of the classification and the assessment of the deferred taxes, penalties and interest.

Return completed applications to:
Snohomish County Assessor's Office
3000 Rockefeller Ave., M/S 510
Everett, WA 98201

IF YOU HAVE ANY QUESTIONS CONCERNING THE APPLICATION CALL THE EXEMPTION DEPARTMENT IN THE ASSESSOR'S OFFICE AT (425) 388-3540

IF YOU HAVE QUESTIONS ABOUT ELIGIBILITY, PLEASE CALL SCOTT LINDQUIST, IN PLANNING & DEVELOPMENT SERVICES AT 425-262-2086 OR EMAIL: scott.lindquist@snoco.org

OPEN SPACE
Assessor's
Application No
3249



Snohomish County

PLANNING & DEVELOPMENT SERVICES
3000 Rockefeller Avenue, Everett, WA 98201-4046
M/S #304

WETLANDS INFORMATION
OPEN SPACE GENERAL

PLEASE READ CAREFULLY

IF THIS APPLICATION FOR OPEN SPACE GENERAL IS FOR PROPERTY WITH WETLANDS AND IS UNDER 5.00 ACRES, PLEASE READ THIS CAREFULLY BEFORE FILING APPLICATION.

THIS IS THE DEFINITION OF WETLAND UNDER THE NEW COUNTY ORDINANCE THAT COULD BE ELIGIBLE FOR OPEN SPACE GENERAL:

WETLANDS: THOSE AREAS THAT ARE INUNDATED OR SATURATED BY SURFACE OR GROUNDWATER AT A FREQUENCY AND DURATION SUFFICIENT TO SUPPORT, AND THAT UNDER NORMAL CIRCUMSTANCES DO SUPPORT, A PREVALENCE OF VEGETATION TYPICALLY ADAPTED FOR LIFE IN SATURATED SOIL CONDITIONS. WETLANDS GENERALLY INCLUDE SWAMPS, MARSHES, BOGS AND SIMILAR AREAS. **WETLANDS DO NOT INCLUDE ARTIFICIAL WETLANDS INTENTIONALLY CREATED FROM NON-WETLANDS SITES INCLUDING, BUT NOT LIMITED TO, IRRIGATION AND DRAINAGE DITCHES, GRASS-LINED SWALES, CANALS, DETENTION FACILITIES, WASTEWATER TREATMENT FACILITIES, FARM PONDS, AND LANDSCAPE AMENITIES.....** HOWEVER, WETLANDS SHALL INCLUDE ARTIFICIAL WETLANDS INTENTIONALLY CREATED FROM NON-WETLAND ACRES TO MITIGATE CONVERSION OF WETLANDS IF PERMITTED BY THE COUNTY.

AGAIN, IF THIS APPLICATION IS UNDER 5.00 ACRES, YOU MAY WANT TO CHECK WITH THE APPRAISAL DEPARTMENT IN THE ASSESSOR'S OFFICE TO SEE IF YOUR WETLANDS MAY ALREADY BE ASSESSED AT A LOWER RATE. IF IS THE CASE, THE TAX SAVINGS WOULD NOT WARRANT THE APPLICATION FEE AND A TAX LIEN OF OPEN SPACE.

FOR QUESTIONS CONCERNING:

- **APPRAISAL** - ASSESSOR'S OFFICE APPRAISAL DEPARTMENT - (425) 388-6576
- **ELIGIBILITY** - DEPARTMENT OF PLANNING & DEVELOPMENT SERVICES – Scott Lindquist – 425-262-2086

APPLICATIONS AND INFORMATION - EXEMPTION DEPARTMENT ASSESSOR'S OFFICE - (425) 388-3540

<p>OPEN SPACE Assessor's Application No. 3249</p>

Application for Classification or Reclassification
Open Space Land
Chapter 84.34 RCW

File With The County Legislative Authority

Name of Owner(s): Myron Friesen + Jennifer Swain Phone No: 425.273.8844
Email Address: myron_f@yahoo.com jenniferaswain@gmail.com 425.749.6753
Address: 11802 188th Street SE
Snohomish, WA 98296

Parcel Number(s): 27061700303000
Legal Description: SEC 17 TWP 27 RGE DBLOT 4 OF PFN 94-32158SP RECAF
NO 9704175002 BEING PTN OF NE1/4 SW1/4 SW1/4 + E1/2
NW1/4 SW1/4 OSA-81
Total Acres in Application: 5.75

Indicate what category of open space this land will qualify for:

- Conserve or enhance natural, cultural, or scenic resources
- Protect streams, stream corridors, wetlands, natural shorelines, or aquifers
- Protect soil resources, unique or critical wildlife, or native plant habitat
- Promote conservation principles by example or by offering educational opportunities
- Enhance the value to the public of abutting or neighboring parks, forests, wildlife preserves, nature reservations or sanctuaries, or other open spaces
- Enhance recreation opportunities
- Preserve historic or archaeological sites
- Preserve visual quality along highway, road, street corridors, or scenic vistas
- Retain in its natural state tracts of land not less than one acre situated in an urban area and open to public use on such conditions as may be reasonably required by the granting authority
- Farm and agricultural conservation land previously classified under RCW 84.34.020(2), that no longer meets the criteria
- Farm and agricultural conservation land that is "traditional farmland" not classified under Chapter 84.33 or Chapter 84.34 RCW, that has not been irrevocably devoted to a use inconsistent with agricultural uses, and has a high potential for returning to commercial agriculture

1. Describe the present use of the land. Residential home, horse pastures, barns for personal use.

2. Is the land subject to a lease or agreement which permits any other use than its present use? Yes No
If yes, attach a copy of the lease agreement.

3. Describe the present improvements (residence, buildings, etc.) located on the land.
Home (residence), horse barn with arena, workshop, yard, garden

4. Is the land subject to any easements? Yes No
If yes, describe the type of easement, the easement restrictions, and the length of the easement.

5. If applying for the farm and agricultural conservation land category, provide a detailed description below about the previous use, the current use, and the intended future use of the land.

Previously pastures leased out, currently for personal use/recreational horse grazing; Intending to maintain pasture/grazing spaces for horses and possible 4H goat/small animal project. May lease individual stalls and turnout's as children age/mature in the future

NOTICE:
The county and/or city legislative authorities may require owners to submit additional information regarding the use of the land.

As owner of the parcel(s) described in this application, I hereby indicate by my signature below that I am aware of the additional tax, interest, and penalties involved when the land ceases to be classified under the provisions of Chapter 84.34 RCW. I also certify that this application and any accompanying documents are accurate and complete.

The agreement to tax according to use of the property is not a contract and can be annulled or canceled at any time by the Legislature (RCW 84.34.070)

Print the name of each owner:

Signature of each owner:

Date

Myron Friesen
Jennifer Swaim

[Signature]
[Signature]

10-30-2022
10-30-2022

The granting or denial of an application for classification or reclassification as open space land is a legislative determination and shall be reviewable only for arbitrary and capricious actions. Denials are only appealable to the superior court of the county in which the land is located and the application is made.

Statement of Additional Tax, Interest, and Penalty Due Upon Removal of Classification

1. Upon removal of classification, an additional tax shall be imposed which shall be due and payable to the county treasurer 30 days after removal or upon sale or transfer, unless the new owner has signed the Notice of Continuance. The additional tax shall be the sum of the following:
 - (a) The difference between the property tax paid as "Open Space Land" and the amount of property tax otherwise due and payable for the last seven years had the land not been so classified; plus
 - (b) Interest upon the amounts of the difference in (a), paid at the same statutory rate charged on delinquent property taxes; plus
 - (c) A penalty of 20% will be applied to the additional tax and interest if the classified land is applied to some other use except through compliance with the property owner's request for withdrawal as described in RCW 84.34.070(1).
2. The additional tax, interest, and penalty specified in (1) shall not be imposed if removal resulted solely from:
 - (a) Transfer to a governmental entity in exchange for other land located within the State of Washington.
 - (b) A taking through the exercise of the power of eminent domain, or sale or transfer to an entity having the power of eminent domain in anticipation of the exercise of such power.
 - (c) A natural disaster such as a flood, windstorm, earthquake, wildfire, or other such calamity rather than by virtue of the act of the landowner changing the use of such property.
 - (d) Official action by an agency of the State of Washington or by the county or city where the land is located disallows the present use of such land.
 - (e) Transfer of land to a church when such land would qualify for property tax exemption pursuant to RCW 84.36.020.
 - (f) Acquisition of property interests by State agencies or agencies or organizations qualified under RCW 84.34.210 and 64.04.130 (See RCW 84.34.108(6)(f)).
 - (g) Removal of land classified as farm & agricultural land under RCW 84.34.020(2)(f) (farm home site).
 - (h) Removal of land from classification after enactment of a statutory exemption that qualifies the land for exemption and receipt of notice from the owner to remove the land from classification.
 - (i) The creation, sale, or transfer of forestry riparian easements under RCW 76.13.120.
 - (j) The creation, sale, or transfer of a conservation easement of private forest lands within unconfined channel migration zones or containing critical habitat for threatened or endangered species under RCW 76.09.040.
 - (k) The sale or transfer of land within two years after the death of the owner of at least a fifty percent interest in the land if the land has been assessed and valued as designated forest land under chapter 84.33 RCW, or classified under this chapter 84.34 RCW continuously since 1993. The date of death shown on the death certificate is the date used.
 - (l) The discovery that the land was classified in error through no fault of the owner.

FOR LEGISLATIVE AUTHORITY USE ONLY

Date application received: _____ By: _____

Amount of processing fee collected: \$ _____

- Is the land subject to a comprehensive land use plan adopted by a city or county? Yes No

If yes, application should be processed in the same manner in which an amendment to the comprehensive land use plan is processed.

If no, application must be acted upon after a public hearing and notice of the hearing shall have been given by one publication in a newspaper of general circulation in the area at least ten days before the hearing.

- If the land is not subject to a comprehensive land use plan, is the land located within an incorporated part of the county? Yes No

If yes, application must be acted upon by three members of the county legislative authority and three members of the city legislative authority. See RCW 84.34.037(1) for details.

If no, application must be acted upon by three members of the county legislative authority.

- Application approved In whole In part
- Application denied Date owner notified of denial (Form 64 0103): _____

If approved, date Open Space Taxation Agreement (OSTA) was mailed to owner: _____

Signed OSTA received by Legislative Authority on: _____

Copy of signed OSTA forwarded to Assessor on: _____

To ask about the availability of this publication in an alternate format for the visually impaired, please call 1-800-647-7706. Teletype (TTY) users may use the Washington Relay Service by calling 711. For assistance, contact your local county assessor's office.

SKETCHED MAP SHEET REQUIRED

Please sketch a representative drawing of your property which clearly locates all buildings, residence(s), sheds, forestlands, wetlands, buffers, roads, trails, etc. An aerial map may be attached, but will not be accepted as a replacement for this detailed sketch, as aerial maps may not always reflect recent activity on the property.

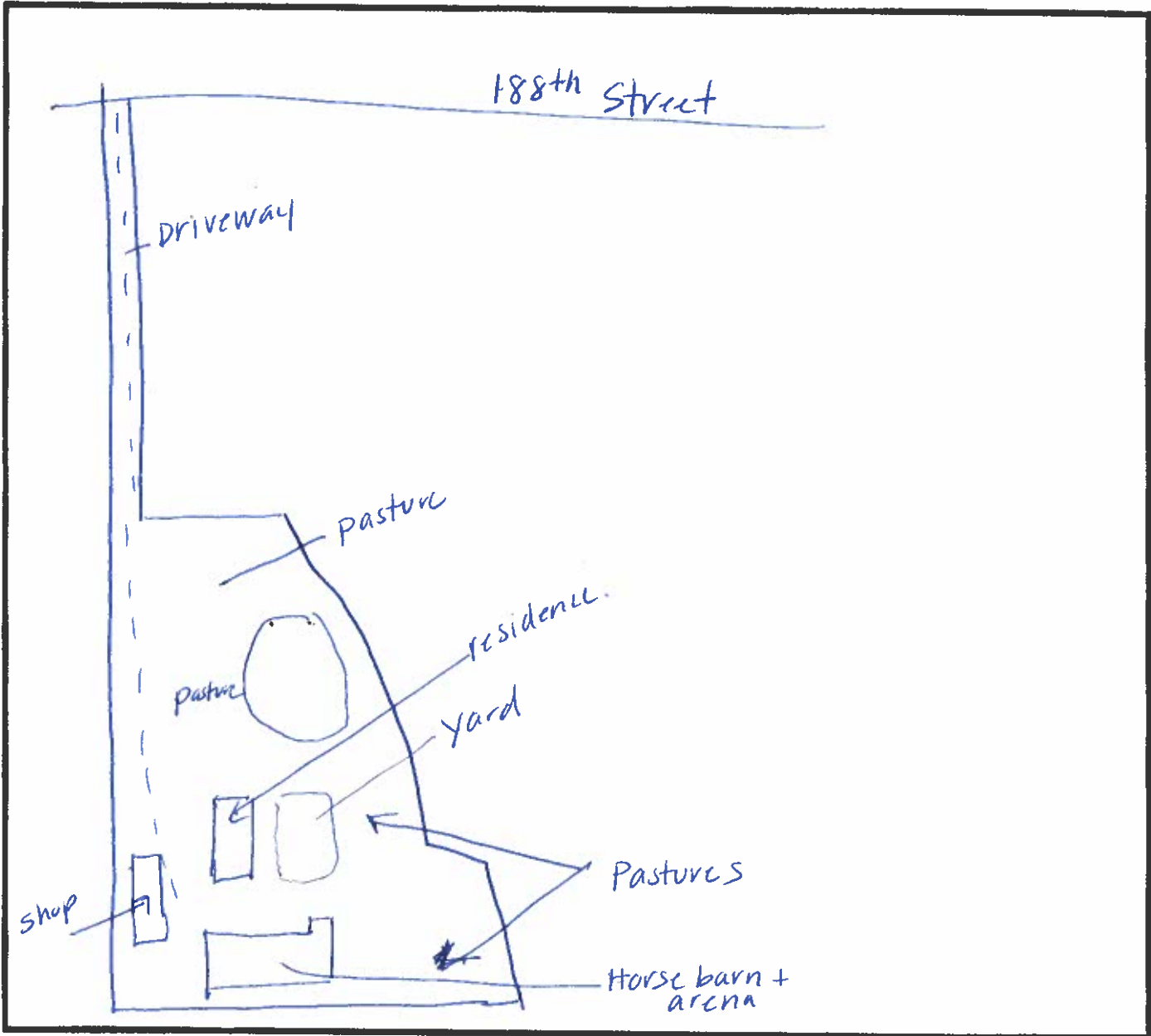

Property Owner Myron Friesen and Jennifer Swaim
Parcel Number(s) 27061700303000

OPEN SPACE
Assessor's
Application No.
3249



Snohomish County

PLANNING & DEVELOPMENT SERVICES

3000 Rockefeller Avenue, M/S #304
Everett, WA 98201-4046

OPEN SPACE CRITERIA

The Department of Planning & Development Services (PDS) reviews all Open Space/General applications according to the following checklist. In order to qualify for Open Space/General classification, **parcels must meet at least one of the criteria listed below.**

- ____(1) Urban areas where the entire site is in an undeveloped, natural state and has slopes of 25% or greater or where at least one-half of the total site area has slopes of at least 35% or more.
- ____(2) Areas designated on the comprehensive land use plan or the county park and recreation plan as potential parks, trails, or greenbelt, or designated as a critical area or environmentally sensitive area.
- ____(3) Areas which have plant or animal species which are considered rare, sensitive, threatened or endangered by an authority recognized by the county.
- ____(4) Sites within urban areas to be left in their natural state where the site is of at least 1-acre in size and is predominately forested with mature specimen trees.
- ____(5) Areas which are in an undeveloped, natural state and are not under the jurisdiction of the State Shoreline Management Act and are situated within stream corridors, i.e., streams and/or their associated stream buffers of 50-feet on either side of the stream. Buffer width may be increased from the 50-foot standard due to topographic, vegetative or wildlife habitat features which would logically suggest a wider buffer.
- ____(6) Undeveloped, natural areas adjacent to water bodies which come under the jurisdiction of the State Shoreline Management Act and are designated by the master plan as "natural", "conservancy", "rural", "suburban" or "urban" type environment.

- ____(7) Sites within an urban area which would serve as a buffer between residential development and tracts of land in excess of five acres which are designated on an adopted comprehensive plan for commercial or industrial development:
- ____(a) Where the site area is covered by stands of trees in excess of 20-feet in height, and,
 - ____(b) Where the ground vegetation creates a visual separation of at least 50-feet between the residential tracts of land and the commercial or industrial lands, or;
 - ____(c) Where the topographic features of the site form a physical separation from the abutting commercial or industrial lands by reason of gull or ravine or similar land condition.
- ____(8) Areas that would safely provide either public vehicular or pedestrian access to public bodies of water:
- ____(a) Where the site area abutting the water is at least 60-feet in width for vehicular access, or;
 - ____(b) Where the site area abutting the water is at least 25-feet in width for pedestrian access.
- ____(9) Areas which provide a scenic vista to which the general public has safe vehicular or pedestrian access.
- ____(10) Sites devoted to private outdoor recreational pursuits such as golf courses, riding stables, lakes, etc., provided that access to such facilities and areas is provided to the general public free of charge or at reasonable, customary rates.
- ____(11) Areas which contain features of unique historic, cultural or educational values which are open to the public's use, (e.g. public access to displays, interpretive centers, etc.), free of charge or at reasonable, customary rates:
- ____(a) Where there are several varieties or species of flora, fauna, or both present on the site making it desirable for educational study, or;

- ___ (b) Where there are habitats or species of plant life which are considered rare, sensitive, threatened or endangered by an authority recognized by the county, **or**:
 - ___ (c) Where there is or are recognized landmarks present on the site which provide visual reference and orientation for surrounding terrain (would include major promontories and rock formations but would exclude mountain forms and ranges), **or**;
 - ___ (d) Where there are historic or archeological features on the site of at least fifty years of age, which would have value to future generations due to the uncommon nature or rare representation of past times and events.
- ___ (12) Areas located adjacent to public parks, public trails or other public lands which would materially add to or enhance the recreational opportunities of that facility:
- ___ (a) Where such a site would constitute a logical extension of the park or other public lands including provisions for public use but has been excluded principally by lack of funds, **or**;
 - ___ (b) Where the site would provide additional public access to such lands during the duration of its open space classification, **or**;
 - ___ (c) Where the site contains unique features of recreational value which if public use of the site were allowed would expand the variety of recreational opportunities contained in the park or public land, **or**;
 - ___ (d) Where the site would act as a buffer between the park and surrounding development.
- ___ (13) Areas which contain or abut managed or monitored wildlife preserves or sanctuaries, arboretums or other designated open space and which will enhance the value of those resources:
- ___ (a) Where the open space designation would encompass a minimum of 10 acres in land area, **and**:
 - ___ (b) Where plant life and/or animal life contained within the site are found in abundant varieties, **or**:

- ___(c) Where the site area can be distinguished from surrounding land due to the unusualness of the vegetation or the animal life inhabitants.
- ___(14) Wetland areas of at least 1/4 acres in size. Associated wetland buffers of 50-feet may also be included. The wetland buffer width may be increased from the 50-foot standard due to topographic, vegetative or wildlife habitat features which would logically suggest a wider buffer.
- ___(15) Areas which lie adjacent to scenic highways which if not designated as open space would otherwise be subject to pressures for intense development:
 - ___(a) Where such highways have been designated by a city, the county or the state as scenic, **and**:
 - ___(b) Where at least one-half of the total site lies within 200 feet of the highway, and;
 - ___(c) Where pressures for urbanization are evident either due to provision of public water and sewer facilities to the area, subdivision activity in the immediate vicinity or the site, or the development of previously platted lands.
- ___(16) Undeveloped areas, five acres and larger which are not within the 100 year flood plain, suitable for agricultural pursuits which may not currently be devoted to such use:
 - ___(a) Where the comprehensive land use plan or the agricultural preservation plan designates the site as suitable for agricultural development, **or**;
 - ___(b) Where more than 75% of the total site area contains tillable Class II or III variety soils as classified by the Soil Conservation Service.
- ___(17) Undeveloped areas which contain a minimum of five (5) acres which are located within the 100-year flood plain as established by the U. S. Army Corps of Engineers or Snohomish County.
- ___(18) Areas where the entire site is in an undeveloped, natural state and is considered geological hazardous by an authority recognized by Snohomish County.

____ (19) Areas which are protective buffers as required by development regulations implementing the Growth Management Act.

(20) Farm & agricultural conservation land as defined in RCW 84.34.020(8)

(a) Land that was previously classified as Open Space Farm & Agriculture under subsection (2) of this section, that no longer meets the criteria of subsection (2) of this section, and that is reclassified under subsection (1) of this section; or

____ (b) Land that is traditional farmland that is not classified under chapter 84.33 or 84.34 RCW, that has not been irrevocably devoted to a use inconsistent with agricultural uses, and that has a high potential for returning to commercial agriculture.

NOTE: An **URBAN AREA** is defined as: an area, designated on an adopted comprehensive plan with a density of 2 or more dwelling units per acre; and/or zoned residential 20,000 (R-20,000), or at a higher density than R-20,000; and/or within an incorporated area.

Upon the adoption of urban growth boundaries pursuant to RCW 36.70A.110, urban area shall be defined as the areas within the adopted boundaries.