

HALLER BRIDGE PIER REPAIR

SECTION 2, T. 31 N., R. 5 E. W.M.

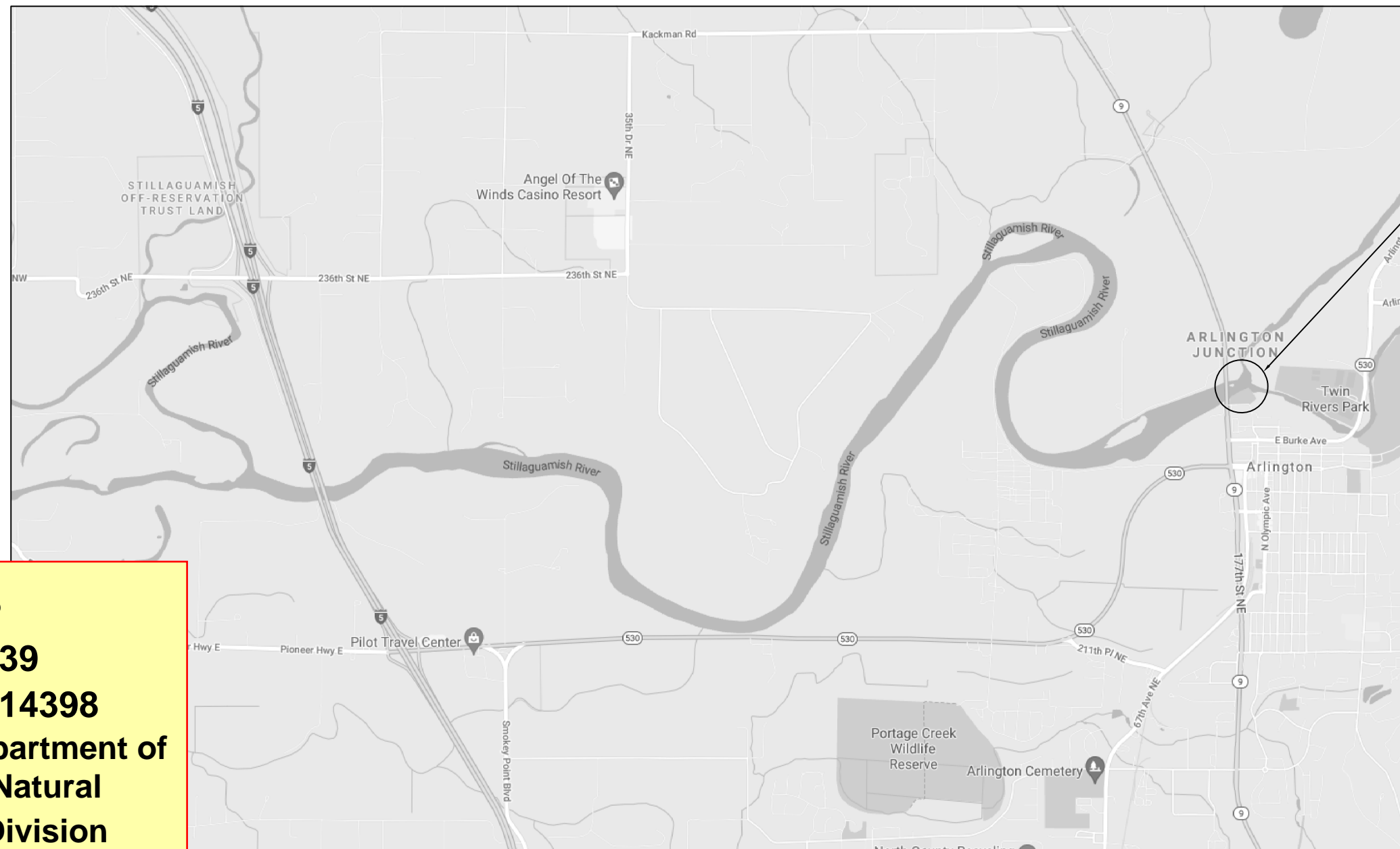

EXHIBIT B

ICN: 1-31-16939

LEASE #: AA-01-14398

Snohomish County Department of
Conservation and Natural
Resources/ Parks Division

Page 1 of 19

VICINITY MAP

EXHIBIT B

ICN: 1-31-16939

LEASE #: AA-01-14398

Snohomish County Department of Conservation and Natural Resources/ Parks Division

Page 2 of 19

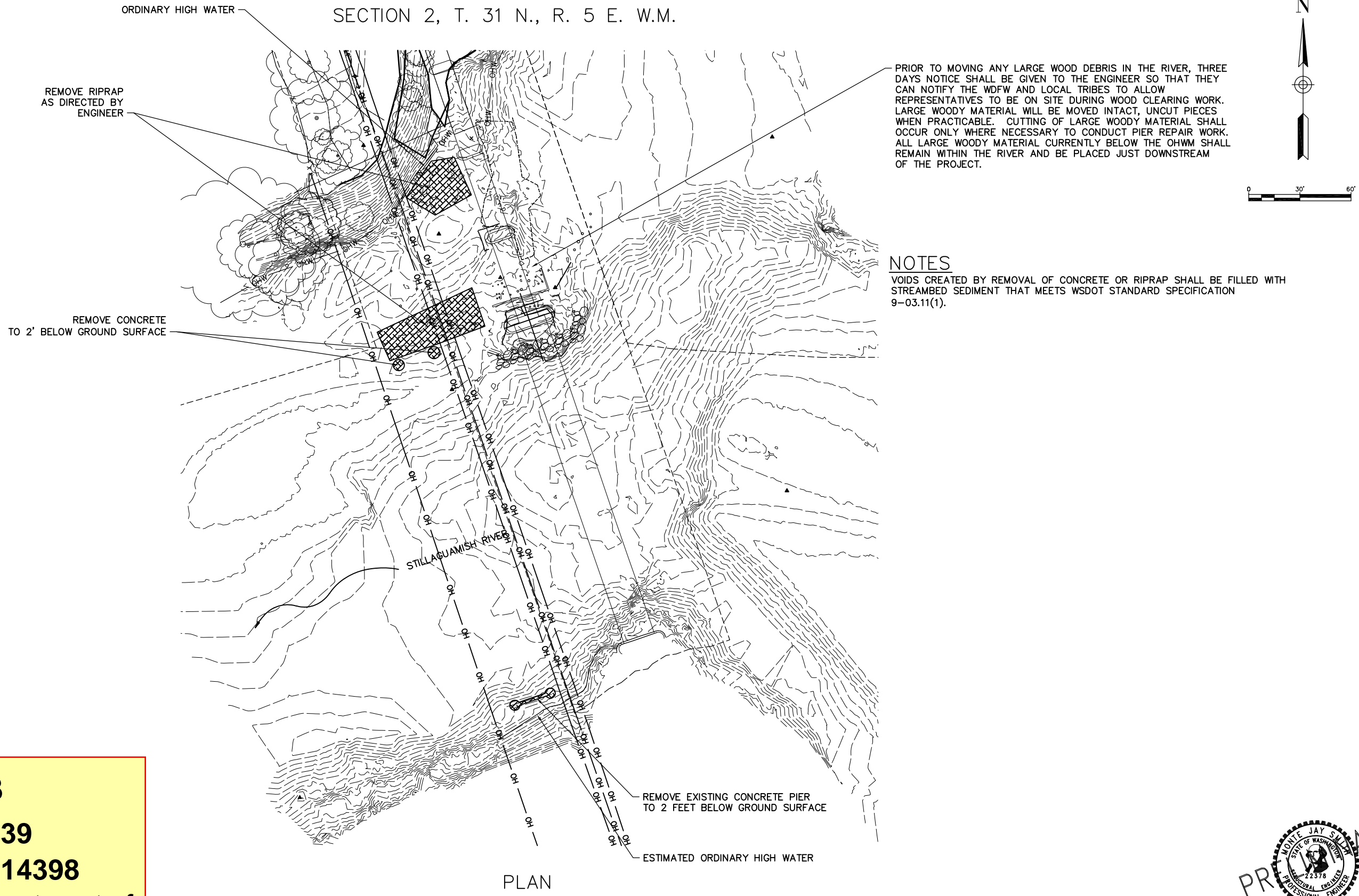

Last Saved By: montes Jun 02, 2021 - 12:07pm			
REGION NO.	STATE	FED. AID PROJ. NO.	SURVEY NO.
10	WASH.	.	.
DESIGNED BY: MJS		DRAWN BY: MJS	
FIELD BOOK(S):		UPI#	
BY			

SARGENT

Sargent Engineers, Inc.

320 Ronlee Lane NW • Olympia, WA 98502

Tel. 360 867-9284 • Fax 360 867-9318

SNOHOMISH COUNTY
DEPARTMENT OF
CONSERVATION AND
NATURAL RESOURCES
PARKS DIVISION

HALLER BRIDGE
PIER REPAIR

DEMOLITION PLAN

REFERENCE SHEET NO.
.
SHEET 2 OF SHEETS

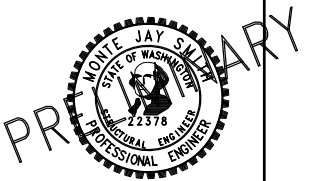

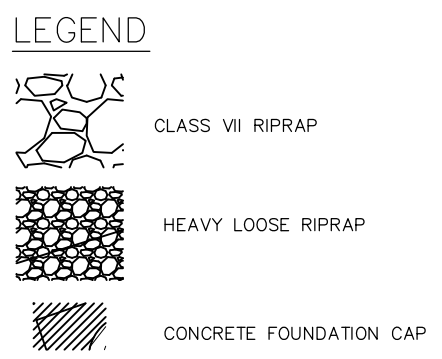

URGENT
 ment Engineers, Inc.
 e NW • Olympia, WA 98502
 9284 • Fax 360 867-9318

SNOHOMISH COUNTY
DEPARTMENT OF
CONSERVATION AND
NATURAL RESOURCES
PARKS DIVISION

HALLER BRIDGE
PIER REPAIR

PIER REPAIR PLAN

REFERENCE SHEET NO.	.
SHEET 3 OF . SHEETS	

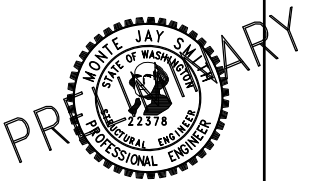

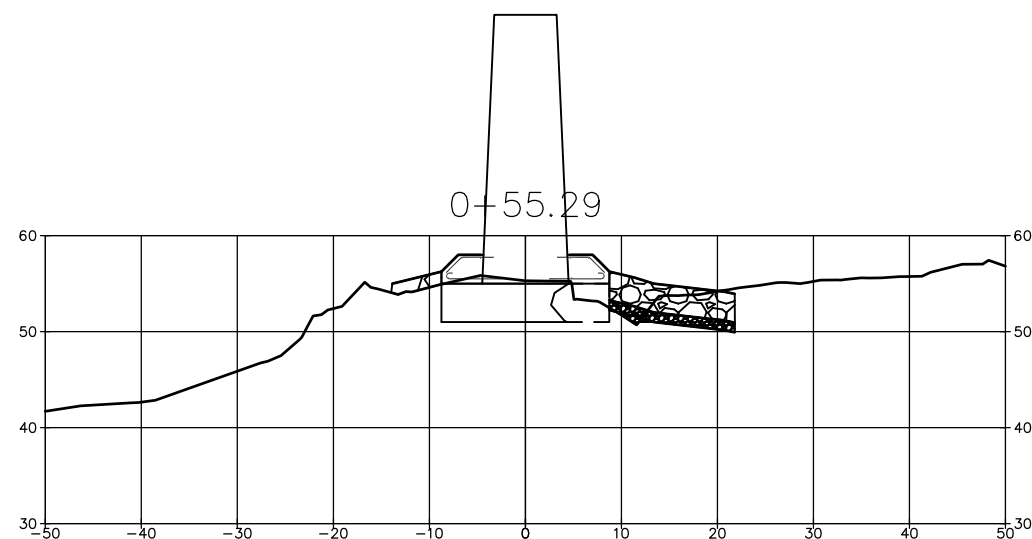
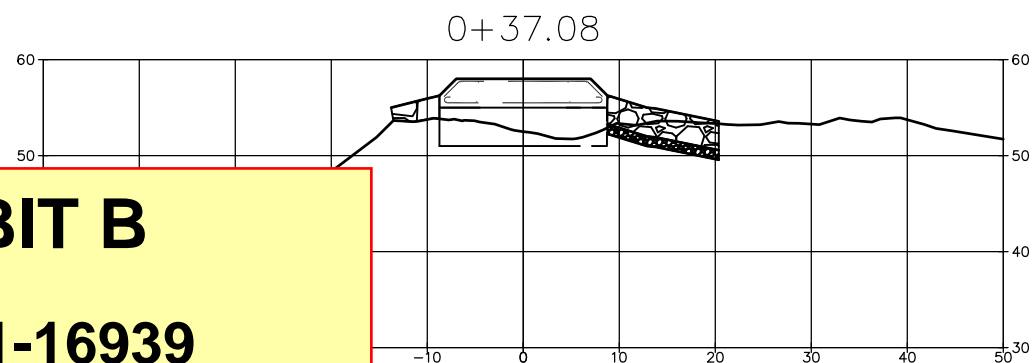
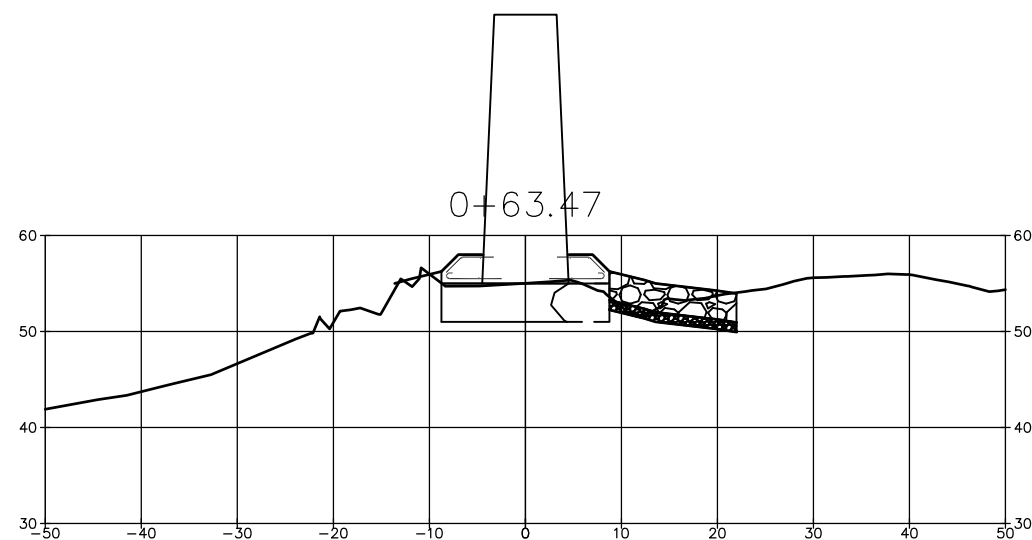
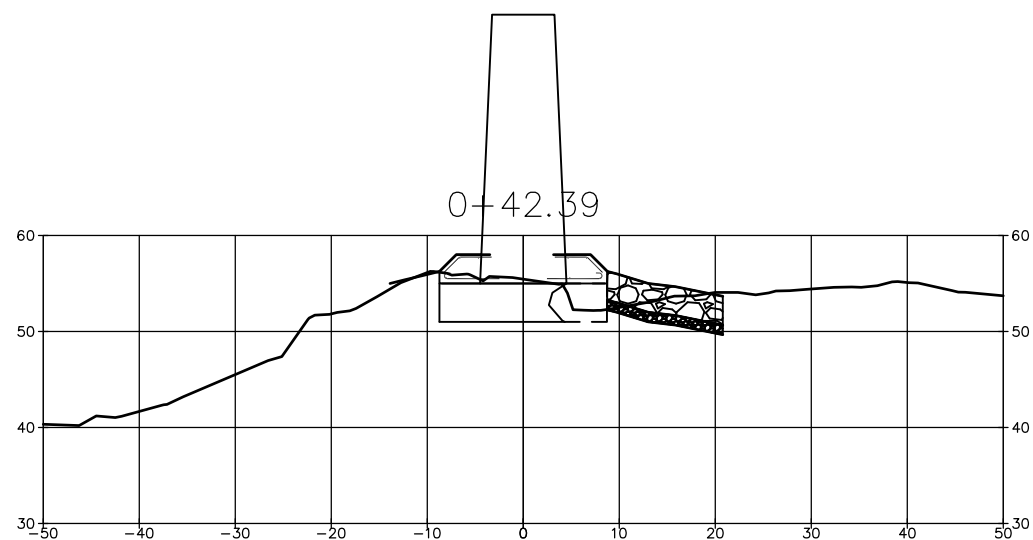
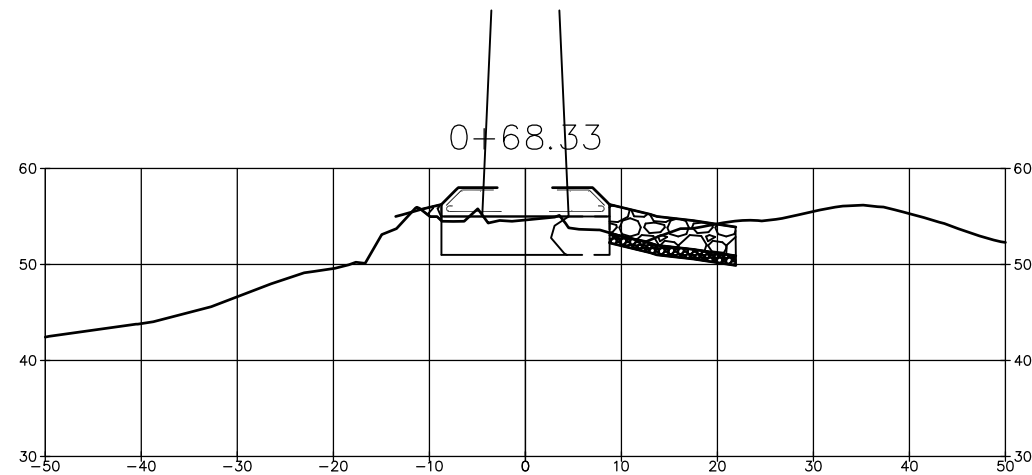
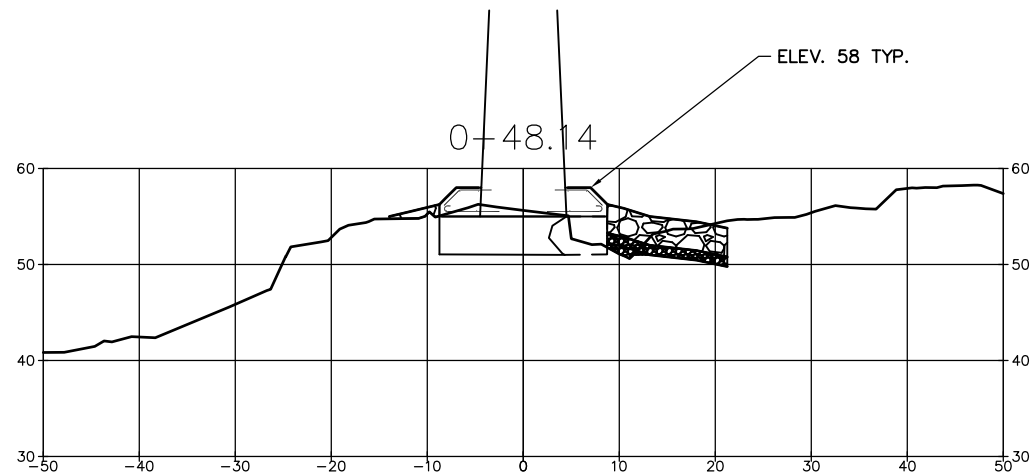

EXHIBIT B

ICN: 1-31-16939

LEASE #: AA-01-14398

Snohomish County Department of
Conservation and Natural
Resources/ Parks Division

Page 4 of 19

Last Saved By: montes Jun 02, 2021 - 12:07pm			
REGION NO.	STATE	FED. AID PROJ. NO.	SURVEY NO.
10	WASH.	.	.
DESIGNED BY: MJS		DRAWN BY: MJS	
FIELD BOOK(S):		UPI#	
BY			

SARGENT

Sargent Engineers, Inc.
320 Ronlee Lane NW • Olympia, WA 98502
Tel. 360 867-9284 • Fax 360 867-9318

SNOHOMISH COUNTY
DEPARTMENT OF
CONSERVATION AND
NATURAL RESOURCES
PARKS DIVISION

HALLER BRIDGE
PIER REPAIR
FOOTING SECTIONS

REFERENCE
SHEET NO.

SHEET
4
OF
SHEETS

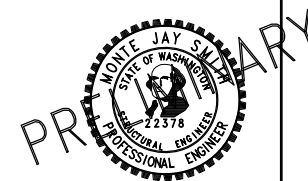

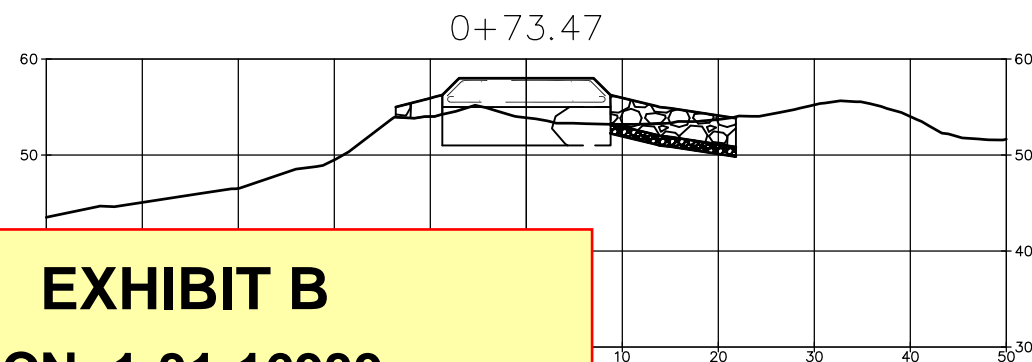
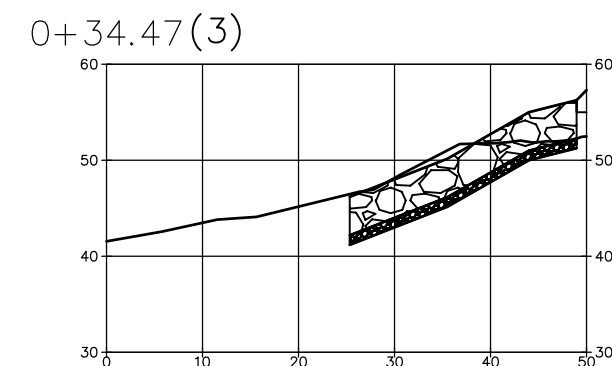
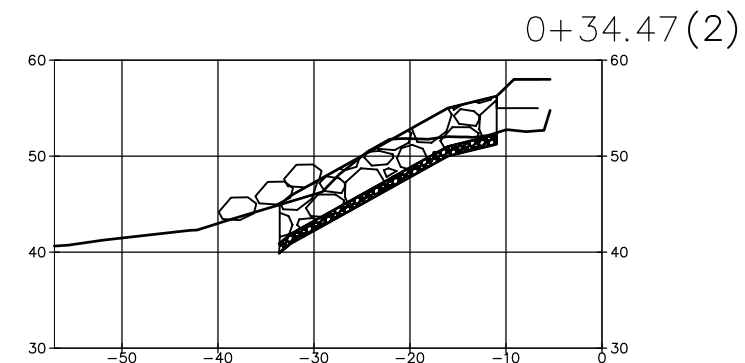
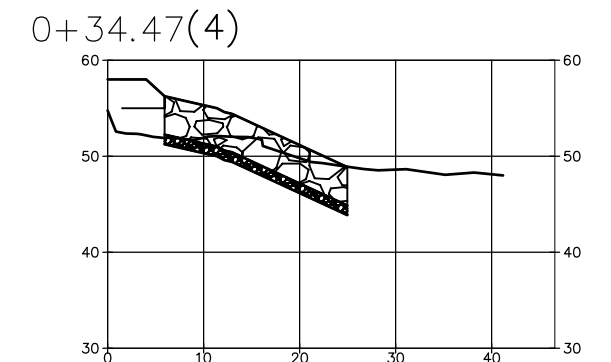
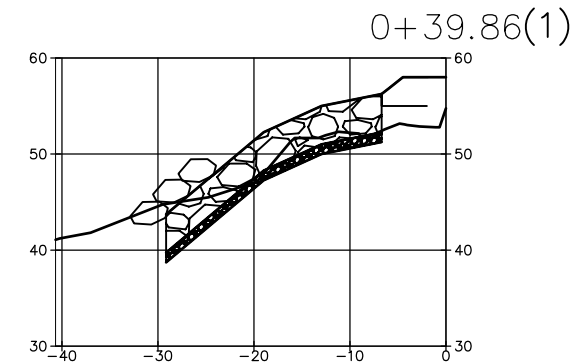

EXHIBIT B

ICN: 1-31-16939

LEASE #: AA-01-14398

Snohomish County Department of
Conservation and Natural
Resources/ Parks Division

Page 5 of 19

Last Saved By: montes Jun 02, 2021 -- 12:07pm			
REGION NO.	STATE	FED. AID PROJ. NO.	SURVEY NO.
10	WASH.	.	.
DESIGNED BY: MJS		DRAWN BY: MJS	
FIELD BOOK(S):		UPI#	
.		.	

SARGENT

Sargent Engineers, Inc.
320 Ronlee Lane NW • Olympia, WA 98502
Tel. 360 867-9284 • Fax 360 867-9318

SNOHOMISH COUNTY
DEPARTMENT OF
CONSERVATION AND
NATURAL RESOURCES
PARKS DIVISION

HALLER BRIDGE
PIER REPAIR
FOOTING SECTIONS 2

REFERENCE
SHEET NO.

SHEET
5
OF
SHEETS

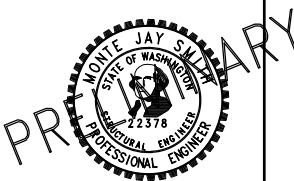

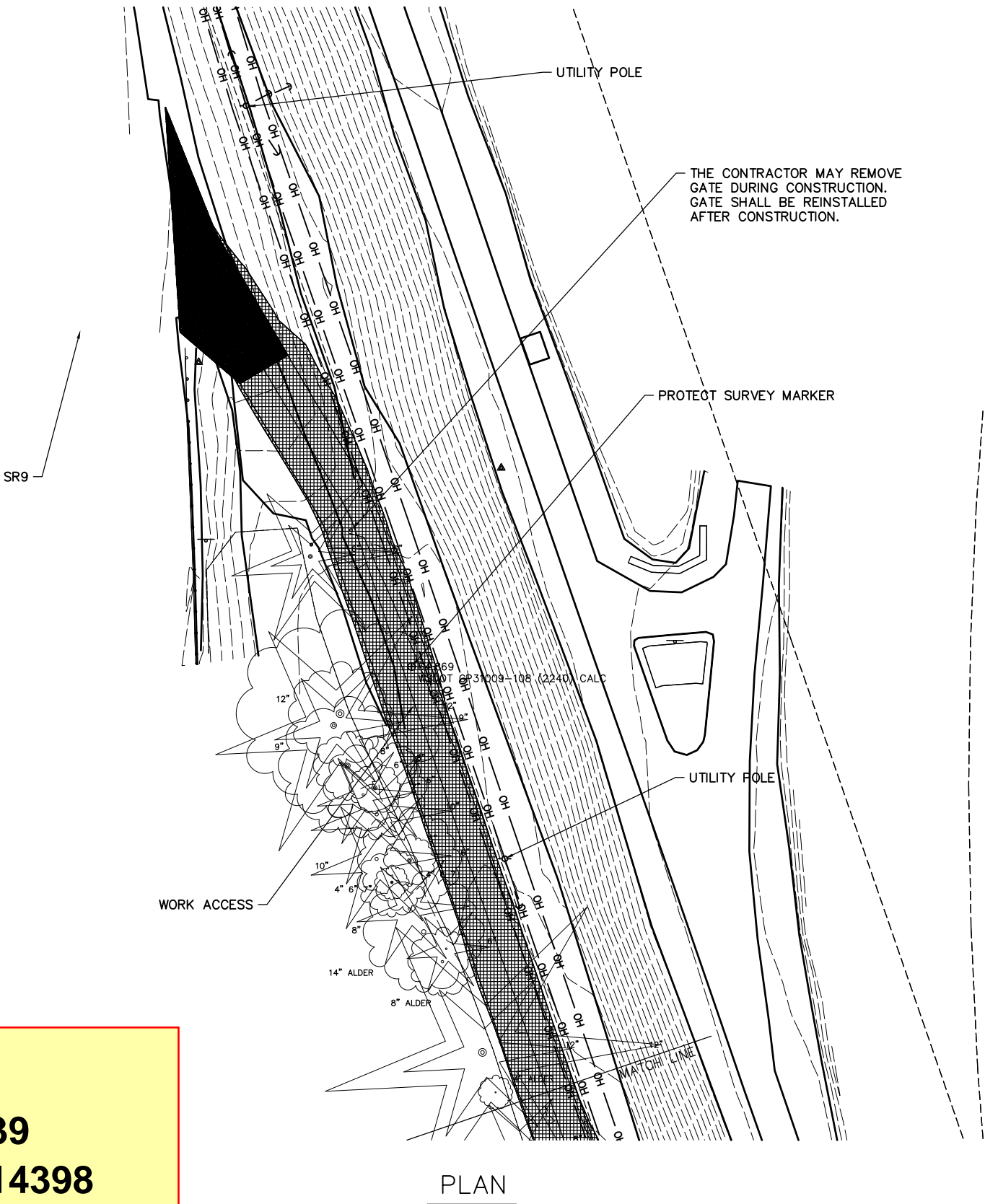

WORK ACCESS NOTES

THE WORK ACCESS THAT IS SHOWN IS CONCEPTUAL. IT IS UP TO THE CONTRACTOR TO LAYOUT THEIR OWN WORK ACCESS. THE WORK ACCESS SHALL MEET THE FOLLOWING CRITERIA:

THE WORK ACCESS SHALL NOT IMPACT THE EXISTING UTILITY POLES.

THE WORK ACCESS SHALL NOT IMPACT ANY MORE TREES THAN ARE SHOWN.

THE WORK ACCESS SHALL NOT IMPACT THE ADJOINING PROPERTY OWNERS.

THE WORK ACCESS IS TEMPORARY. IT SHALL BE CONSTRUCTED BY PLACING A GEOSYNTHETIC ON THE EXISTING UNDISTURBED GROUND AND THEN PLACING 6" OF HOG FUEL ON TOP OF THAT FOR THE WORKING SURFACE.

THE FILL USED IN THE STREAM SHALL BE WASHED ROCK FREE OF DEBRIS PLACED ON A GEOSYNTHETIC.

TREES ARE WOODY VEGETATION WITH A TRUNK DIAMETER OF 4" OR GREATER. NO TREES WILL BE REMOVED UNLESS SPECIFIED ON THESE PLANS.

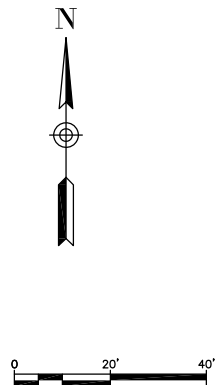

EXHIBIT B

ICN: 1-31-16939

LEASE #: AA-01-14398

Snohomish County Department of
Conservation and Natural
Resources/ Parks Division

Last Saved By: montes Jun 02, 2021 - 12:07pm			
REGION NO.	STATE	FED. AID PROJ. NO.	SURVEY NO.
10	WASH.	.	.
DESIGNED BY: MJS		DRAWN BY: MJS	
FIELD BOOK(S):		UPI#	
BY			

SARGENT

Sargent Engineers, Inc.
320 Ronlee Lane NW • Olympia, WA 98502
Tel. 360 867-9284 • Fax 360 867-9318

SNOHOMISH COUNTY
DEPARTMENT OF
CONSERVATION AND
NATURAL RESOURCES
PARKS DIVISION

HALLER BRIDGE
PIER REPAIR

SUGGESTED WORK ACCESS 1

REFERENCE
SHEET NO.

SHEET
6
OF
SHEETS

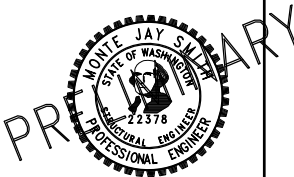

SECTION 2, T. 31 N., R. 5 E. W.M.

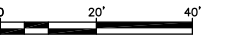
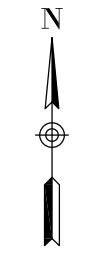
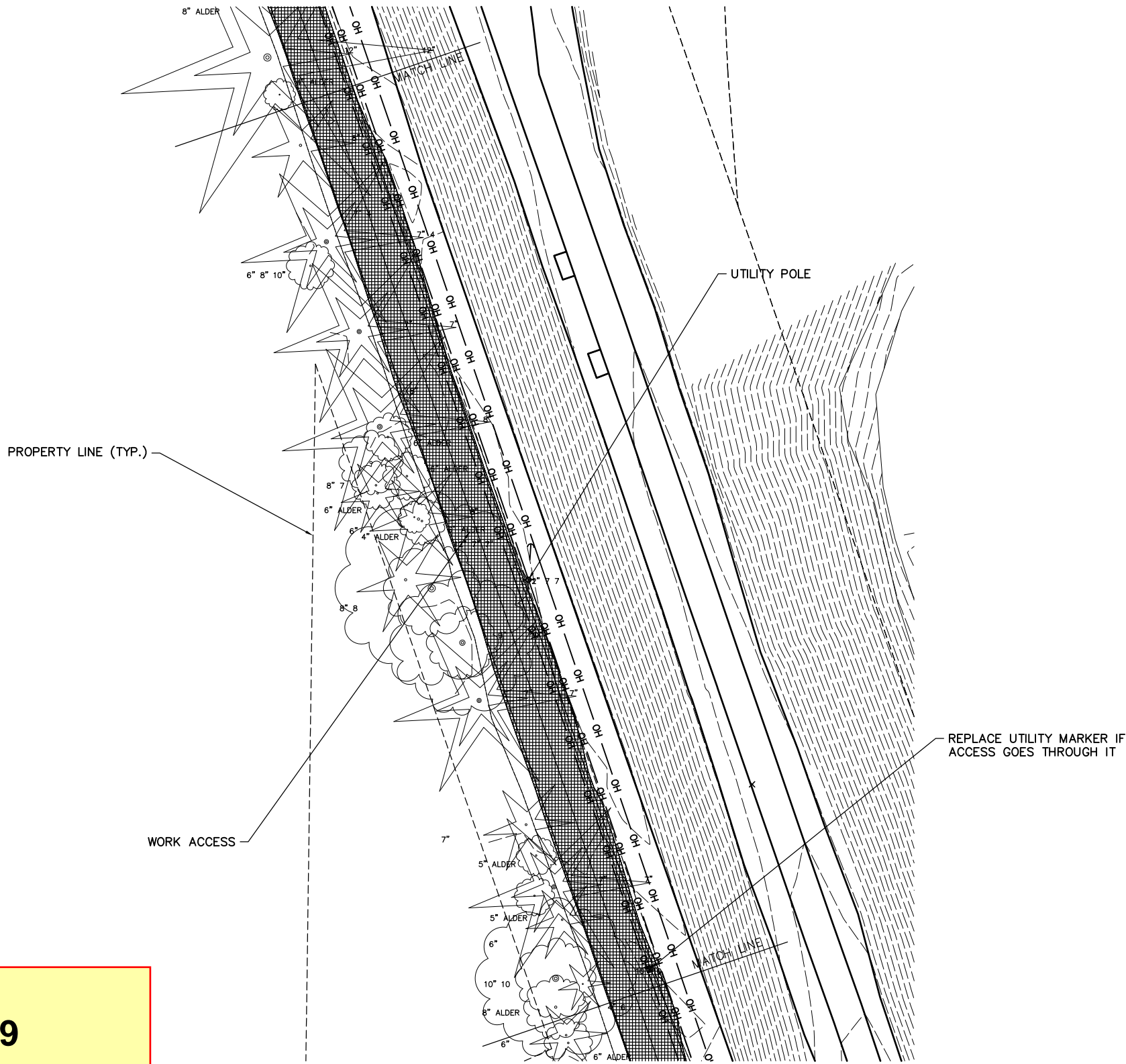

PLAN

EXHIBIT B

ICN: 1-31-16939

LEASE #: AA-01-14398

Snohomish County Department of Conservation and Natural Resources/ Parks Division

Page 7 of 19

Last Saved By: montes Jun 02, 2021 - 12:07pm			
REGION NO.	STATE	FED. AID PROJ. NO.	SURVEY NO.
10	WASH.	.	.
DESIGNED BY: MJS		DRAWN BY: MJS	
FIELD BOOK(S):		UPI#	
BY			

SARGENT

Sargent Engineers, Inc.

320 Ronlee Lane NW • Olympia, WA 98502

Tel. 360 867-9284 • Fax 360 867-9318

SNOHOMISH COUNTY
DEPARTMENT OF
CONSERVATION AND
NATURAL RESOURCES
PARKS DIVISION

HALLER BRIDGE
PIER REPAIR

SUGGESTED WORK ACCESS 2

REFERENCE SHEET NO.
.
SHEET 7 OF SHEETS

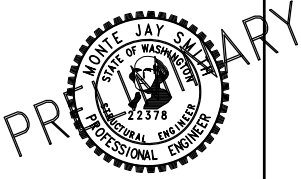

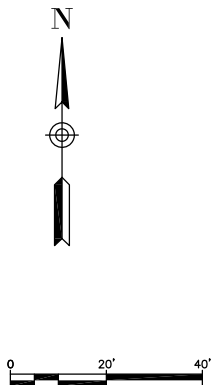
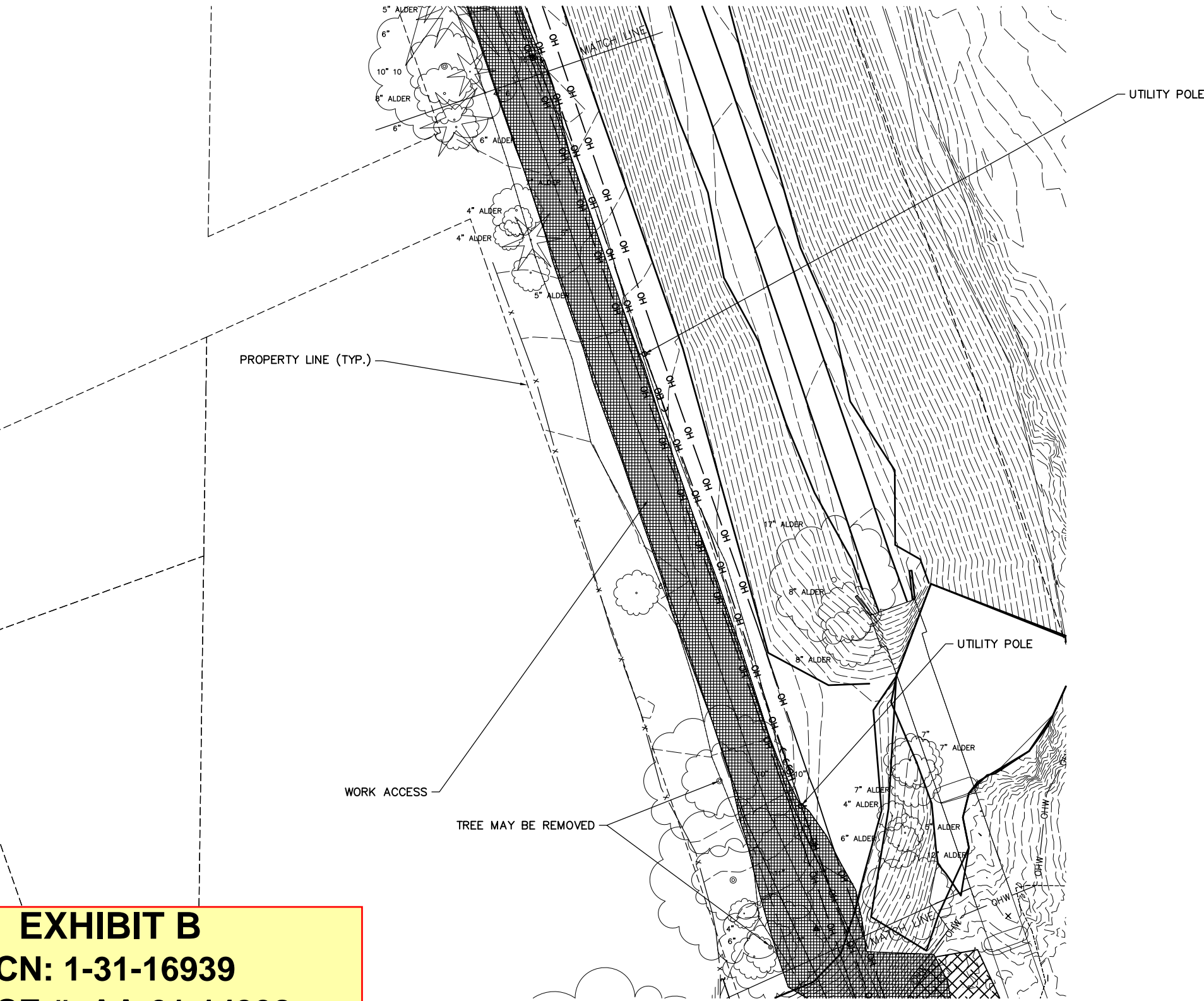

PLAN

EXHIBIT B

ICN: 1-31-16939

LEASE #: AA-01-14398

Snohomish County Department of Conservation and Natural Resources/ Parks Division

Page 8 of 19

Last Saved By: montes Jun 02, 2021 -- 12:07pm			
REGION NO.	STATE	FED. AID PROJ. NO.	SURVEY NO.
10	WASH.	.	.
DESIGNED BY: MJS		DRAWN BY: MJS	
FIELD BOOK(S):		UPI#	
BY			

SARGENT

Sargent Engineers, Inc.

320 Ronlee Lane NW • Olympia, WA 98502

Tel. 360 867-9284 • Fax 360 867-9318

SNOHOMISH COUNTY DEPARTMENT OF CONSERVATION AND NATURAL RESOURCES PARKS DIVISION	HALLER BRIDGE PIER REPAIR SUGGESTED WORK ACCESS 3	REFERENCE SHEET NO.
		.
		SHEET 8 OF SHEETS

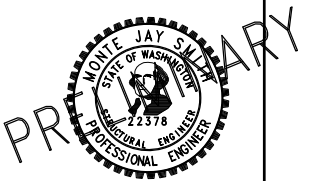

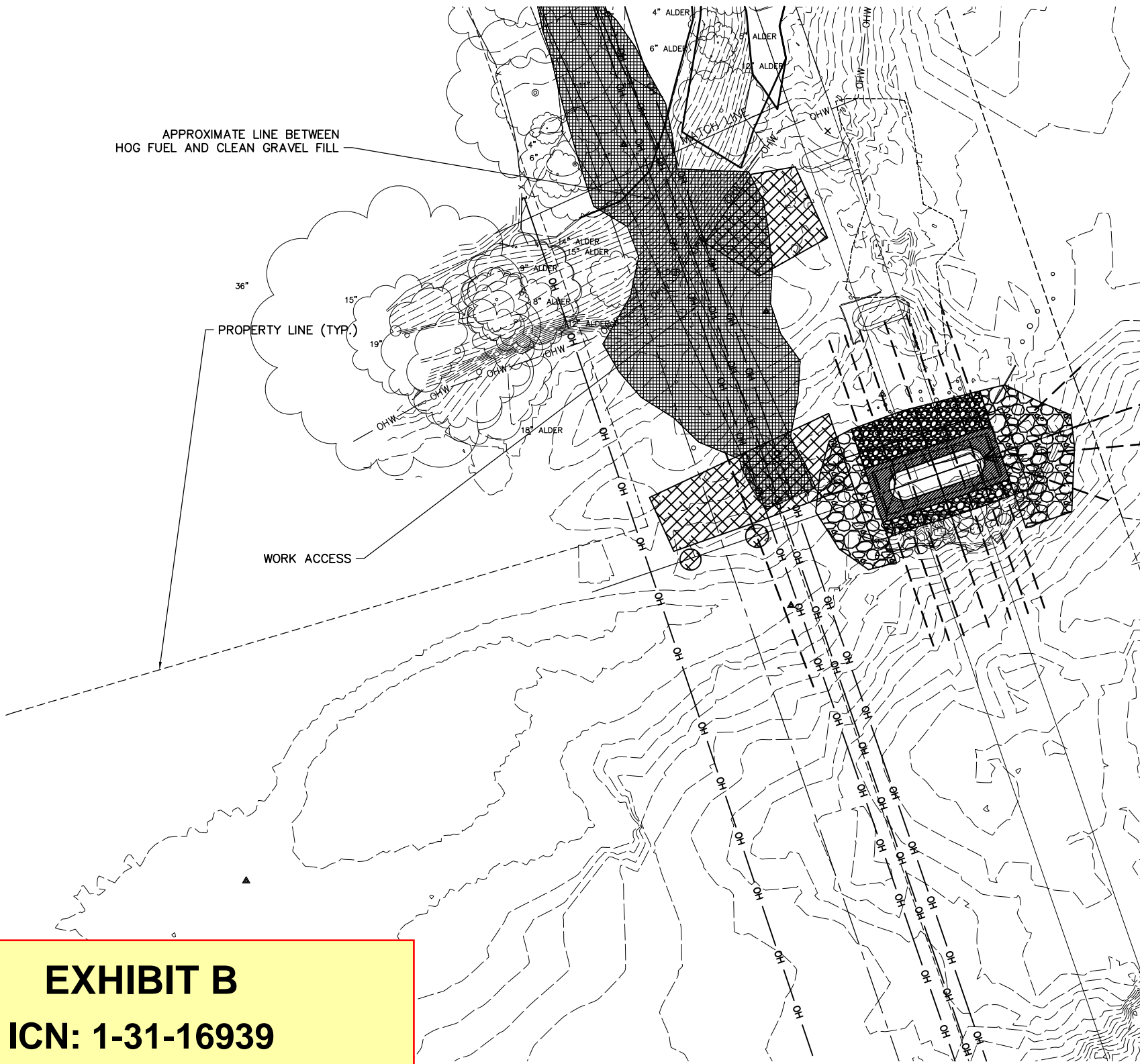
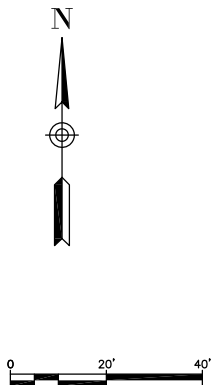

EXHIBIT B

ICN: 1-31-16939

LEASE #: AA-01-14398

Snohomish County Department of Conservation and Natural Resources/ Parks Division

Page 9 of 19

Last Saved By: montes Jun 02, 2021 - 12:07pm			
REGION NO.	STATE	FED. AID PROJ. NO.	SURVEY NO.
10	WASH.	.	.
DESIGNED BY: MJS		DRAWN BY: MJS	
FIELD BOOK(S):		UPI#	
BY	.	.	.

SARGENT

Sargent Engineers, Inc.

320 Ronlee Lane NW • Olympia, WA 98502

Tel. 360 867-9284 • Fax 360 867-9318

SNOHOMISH COUNTY
DEPARTMENT OF
CONSERVATION AND
NATURAL RESOURCES
PARKS DIVISION

HALLER BRIDGE
PIER REPAIR

SUGGESTED WORK ACCESS 4

REFERENCE SHEET NO.
.
SHEET 9 OF SHEETS

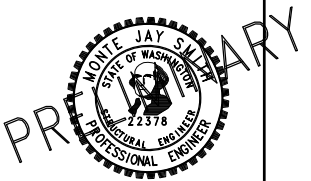

SECTION 2, T. 31 N., R. 5 E. W.M.

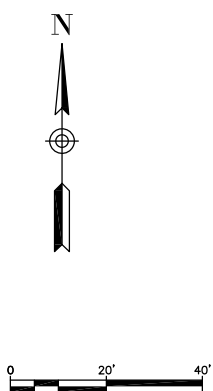
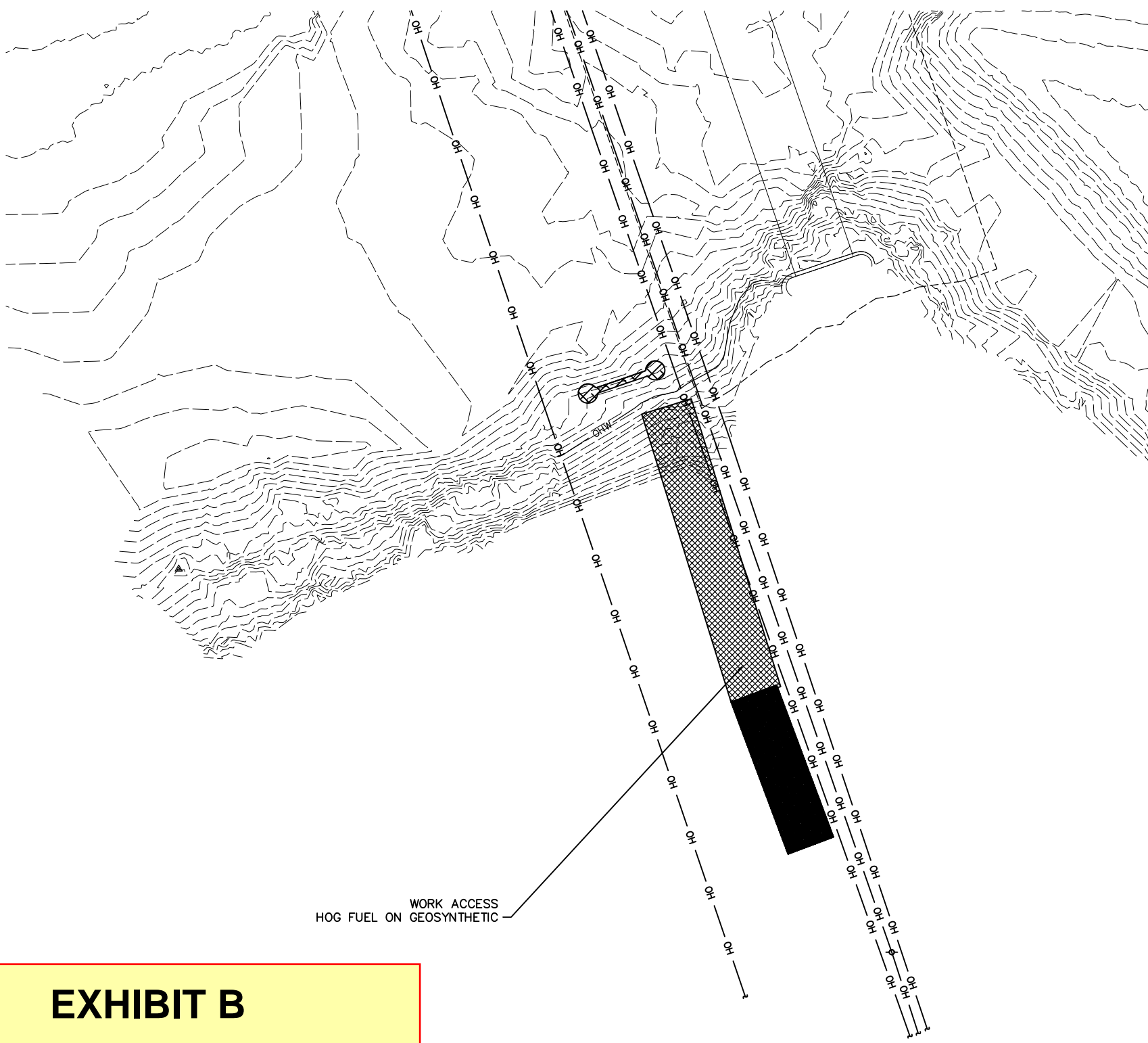

WORK ACCESS
HOG FUEL ON GEOSYNTHETIC

PLAN

EXHIBIT B

ICN: 1-31-16939

LEASE #: AA-01-14398

Snohomish County Department of Conservation and Natural Resources/ Parks Division

Page 10 of 19

Last Saved By: montes Jun 02, 2021 -- 12:07pm			
REGION NO.	STATE	FED. AID PROJ. NO.	SURVEY NO.
10	WASH.	.	.
DESIGNED BY: MJS		DRAWN BY: MJS	
FIELD BOOK(S):		UPI#	
BY			

SARGENT

Sargent Engineers, Inc.

320 Ronlee Lane NW • Olympia, WA 98502

Tel. 360 867-9284 • Fax 360 867-9318

SNOHOMISH COUNTY
DEPARTMENT OF
CONSERVATION AND
NATURAL RESOURCES
PARKS DIVISION

HALLER BRIDGE
PIER REPAIR

SUGGESTED WORK ACCESS 5

REFERENCE SHEET NO.
.
SHEET 10 OF SHEETS

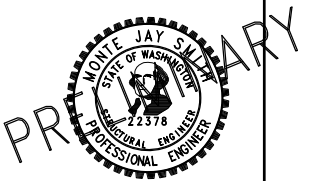

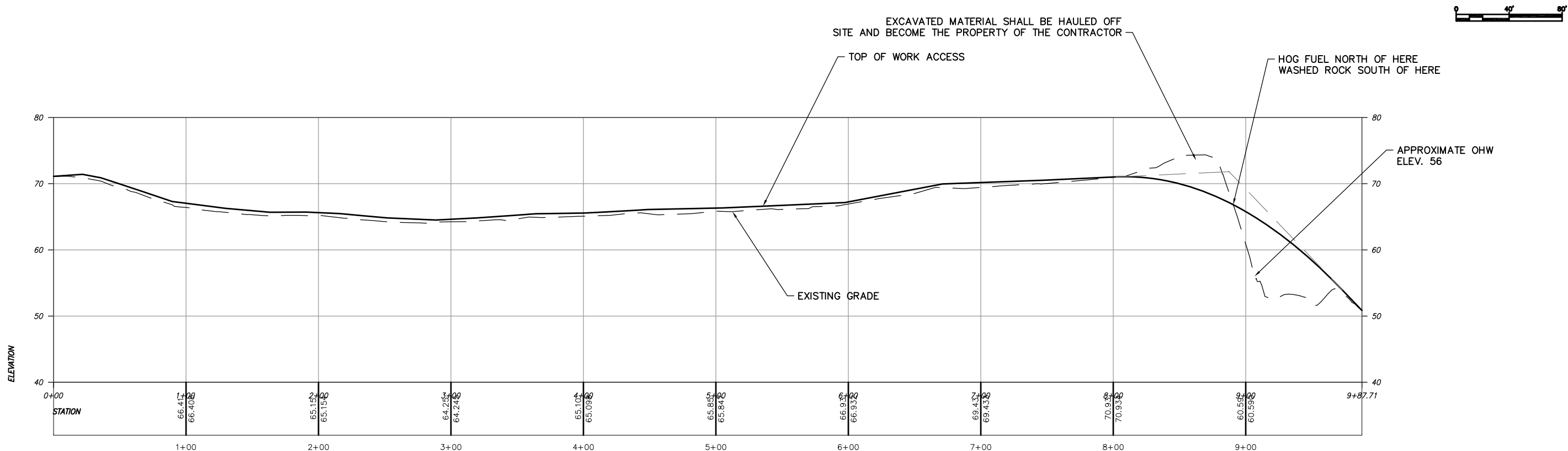

PROFILE

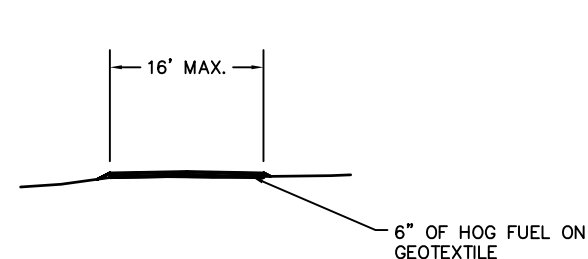

SECTION OUTSIDE RIVER CHANNEL

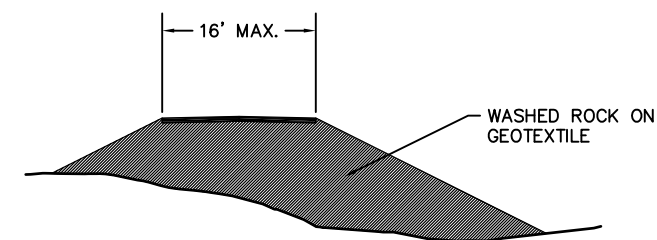

SECTION IN RIVER CHANNEL

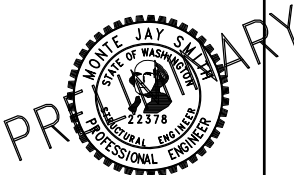

EXHIBIT B

ICN: 1-31-16939

LEASE #: AA-01-14398

Snohomish County Department of Conservation and Natural Resources/ Parks Division

Page 11 of 19

Last Saved By: montes Jun 02, 2021 - 12:07pm			
REGION NO.	STATE	FED. AID PROJ. NO.	SURVEY NO.
10	WASH.	.	.
DESIGNED BY: MJS		DRAWN BY: MJS	
FIELD BOOK(S):		UPI#	
BY			

SARGENT

Sargent Engineers, Inc.

320 Ronlee Lane NW • Olympia, WA 98502

Tel. 360 867-9284 • Fax 360 867-9318

SNOHOMISH COUNTY
DEPARTMENT OF
CONSERVATION AND
NATURAL RESOURCES
PARKS DIVISION

HALLER BRIDGE
PIER REPAIR
PROFILE
SUGGESTED WORK ACCESS

REFERENCE SHEET NO.
.
SHEET 11 OF SHEETS

TESC NOTES

THE IMPLEMENTATION OF THESE TESC PLANS AND THE CONSTRUCTION, MAINTENANCE, REPLACEMENT, AND UPGRADING OF THESE TESC FACILITIES IS THE RESPONSIBILITY OF THE CONTRACTOR UNTIL ALL CONSTRUCTION IS COMPLETED AND APPROVED AND VEGETATION/LANDSCAPING IS ESTABLISHED.

THE BOUNDARIES OF THE CLEARING LIMITS SHOWN ON THIS PLAN SHALL BE CLEARLY FLAGGED IN THE FIELD PRIOR TO CONSTRUCTION. DURING THE CONSTRUCTION PERIOD, NO DISTURBANCE BEYOND THE FLAGGED CLEARING LIMITS SHALL BE PERMITTED. THE FLAGGING SHALL BE MAINTAINED BY THE CONTRACTOR FOR THE DURATION OF CONSTRUCTION.

THE TESC FACILITIES SHOWN ON THIS PLAN MUST BE CONSTRUCTED IN CONJUNCTION WITH ALL CLEARING AND GRADING ACTIVITIES, AND IN SUCH A MANNER AS TO INSURE THAT SEDIMENT AND SEDIMENT LADEN WATER DO NOT ENTER THE DRAINAGE SYSTEM, ROADWAYS, OR VIOLATE APPLICABLE WATER STANDARDS.

THE TESC FACILITIES SHOWN ON THIS PLAN ARE THE MINIMUM REQUIREMENTS FOR ANTICIPATED SITE CONDITIONS. DURING THE CONSTRUCTION PERIOD, THESE TESC FACILITIES SHALL BE UPGRADED AS NEEDED FOR UNEXPECTED STORM EVENTS AND TO ENSURE THAT SEDIMENT AND SEDIMENT-LADEN WATER DO NOT LEAVE THE SITE.

THE TESC FACILITIES SHALL BE INSPECTED DAILY BY THE CONTRACTOR AND MAINTAINED AS NECESSARY TO ENSURE THEIR CONTINUED FUNCTIONING.
THE TESC FACILITIES ON INACTIVE SITES SHALL BE INSPECTED AND MAINTAINED A MINIMUM OF ONCE A MONTH OR WITHIN THE 48 HOURS FOLLOWING A MAJOR STORM EVENT.

STABILIZED CONSTRUCTION ENTRANCES SHALL BE INSTALLED AT THE BEGINNING OF CONSTRUCTION AND MAINTAINED FOR THE DURATION OF THE PROJECT. ADDITIONAL MEASURES MAY BE REQUIRED TO INSURE THAT ALL PAVED AREAS ARE KEPT CLEAN FOR THE DURATION OF THE PROJECT.

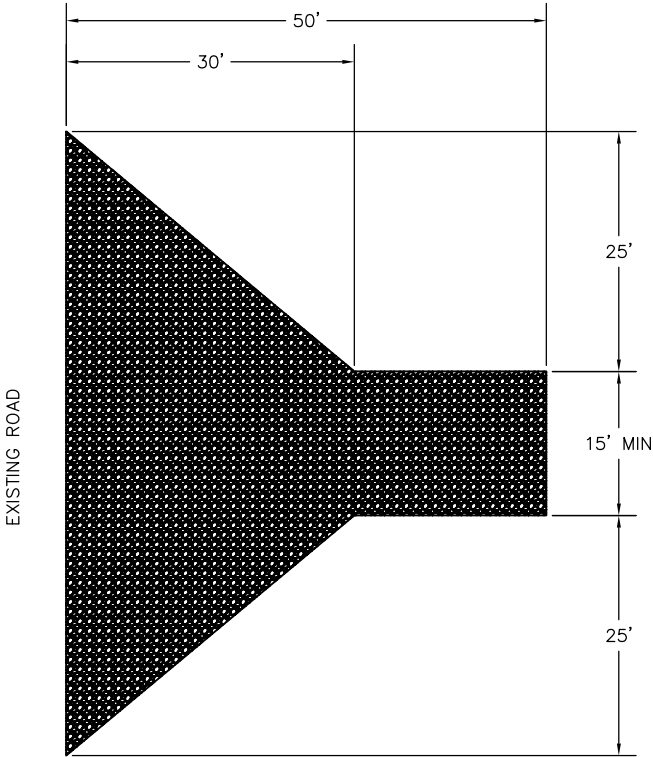

PLAN

STABILIZED CONSTRUCTION ENTRANCE

STABILIZED CONSTRUCTION ENTRANCE SHALL MEET THE REQUIREMENTS OF SECTION 8-01.3(7).

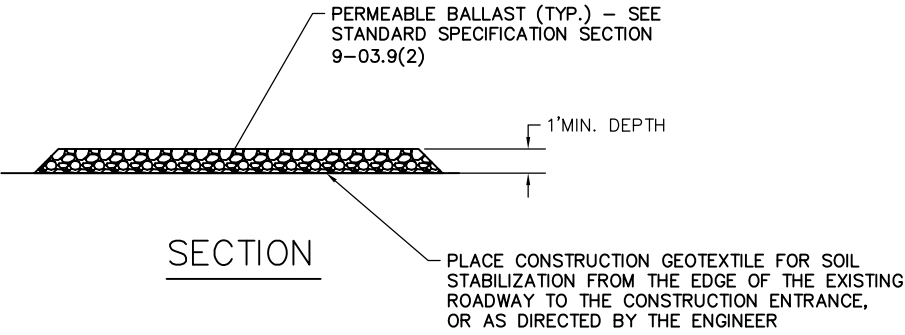

SECTION

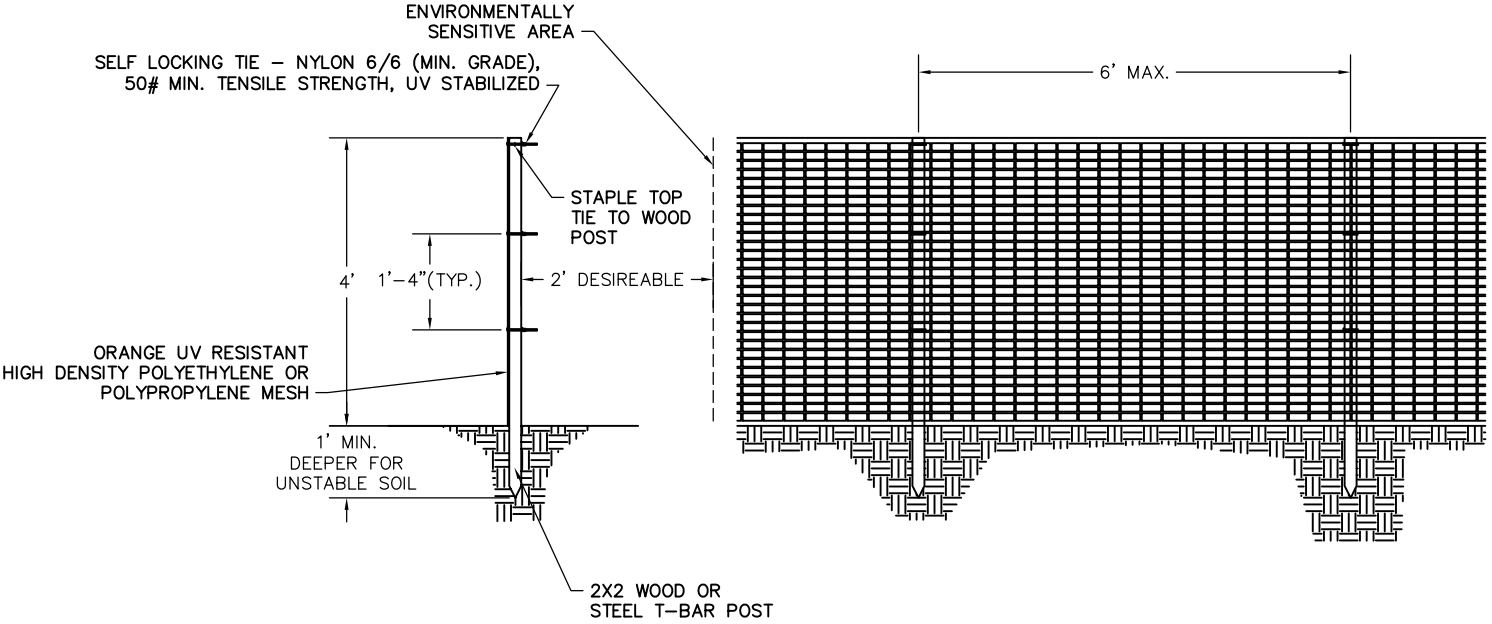

SECTION

ELEVATION

HIGH VISIBILITY FENCE

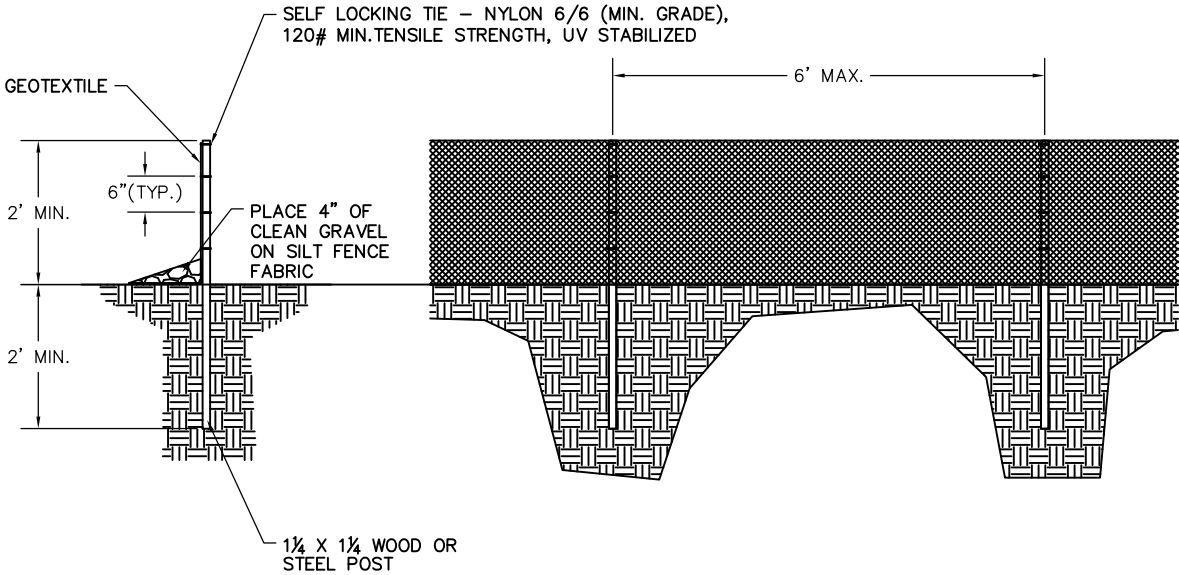

SECTION

ELEVATION

SILT FENCE

SILT FENCE FABRIC SHALL COMPLY WITH STANDARD SPECIFICATION 9-33.2(1), TABLE 6.
INSTALL THE ENDS OF THE SILT FENCE TO POINT SLIGHTLY UPSLOPE TO PREVENT SEDIMENT FROM FLOWING AROUND THE ENDS OF THE FENCE.
SPICES SHALL NEVER BE PLACED IN LOW SPOTS.

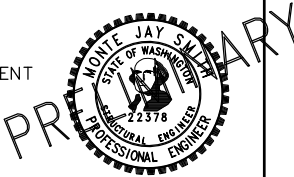

EXHIBIT B

ICN: 1-31-16939

LEASE #: AA-01-14398

Snohomish County Department of Conservation and Natural Resources/ Parks Division

Page 12 of 19

Last Saved By: montes Jun 02, 2021 - 12:07pm			
REGION NO.	STATE	FED. AID PROJ. NO.	SURVEY NO.
10	WASH.	.	.
DESIGNED BY: MJS		DRAWN BY: MJS	
FIELD BOOK(S):		UPI#	
BY		.	

SARGENT

Sargent Engineers, Inc.

320 Ronlee Lane NW • Olympia, WA 98502

Tel. 360 867-9284 • Fax 360 867-9318

SNOHOMISH COUNTY DEPARTMENT OF CONSERVATION AND NATURAL RESOURCES PARKS DIVISION

HALLER BRIDGE PIER REPAIR TEMPORARY EROSION AND SEDIMENTATION CONTROL (TESC)

REFERENCE SHEET NO. . SHEET 12 OF . SHEETS

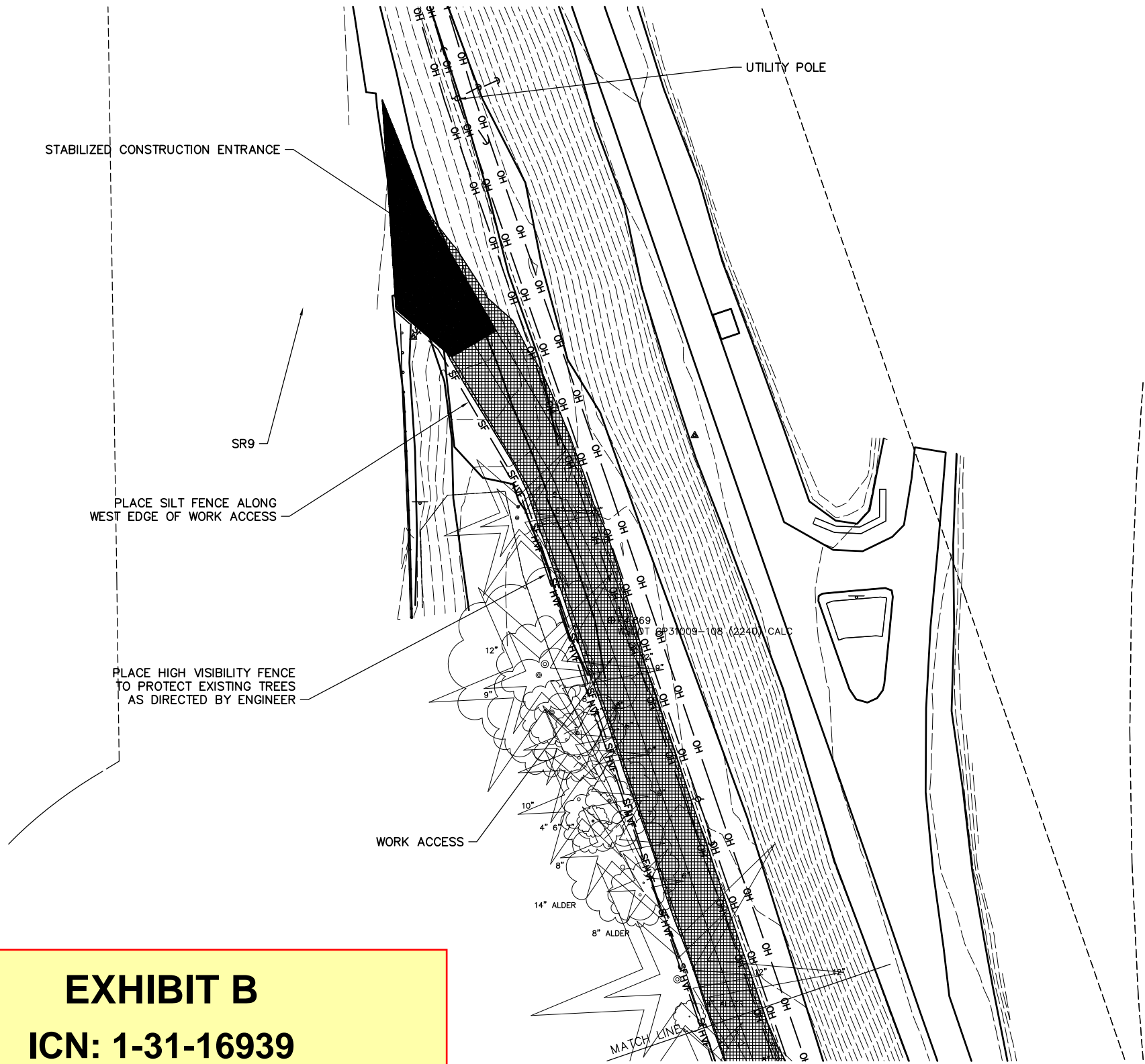

PLAN

NOTES

THE ONLY CLEARING THAT IS ALLOWED IS FOR THE WORK ACCESS. CUT EXISTING VEGETATION TO SIX INCHES TALL AND THEN PLACE GEOTEXTILE ON CUT VEGETATION.

EXISTING TREES MAY HAVE LIMBS REMOVED TO PROVIDE CLEARANCE FOR WORK ACCESS.

DO NOT CUT TREE ROOTS.

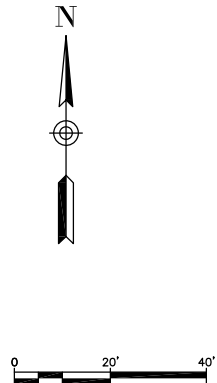

EXHIBIT B

ICN: 1-31-16939

LEASE #: AA-01-14398

Snohomish County Department of Conservation and Natural Resources/ Parks Division

Page 13 of 19

Last Saved By: montes Jun 02, 2021 -- 12:07pm			
REGION NO.	STATE	FED. AID PROJ. NO.	SURVEY NO.
10	WASH.	.	.
DESIGNED BY: MJS		DRAWN BY: MJS	
FIELD BOOK(S):		UPI#	
.		.	

SARGENT

Sargent Engineers, Inc.

320 Ronlee Lane NW • Olympia, WA 98502

Tel. 360 867-9284 • Fax 360 867-9318

SNOHOMISH COUNTY DEPARTMENT OF CONSERVATION AND NATURAL RESOURCES PARKS DIVISION	HALLER BRIDGE PIER REPAIR TEMPORARY EROSION AND SEDIMENT CONTROL 2	REFERENCE SHEET NO.
		.
		SHEET 13 OF SHEETS

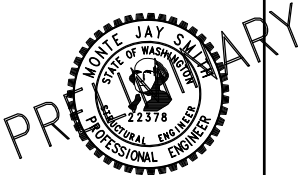

SECTION 2, T. 31 N., R. 5 E. W.M.

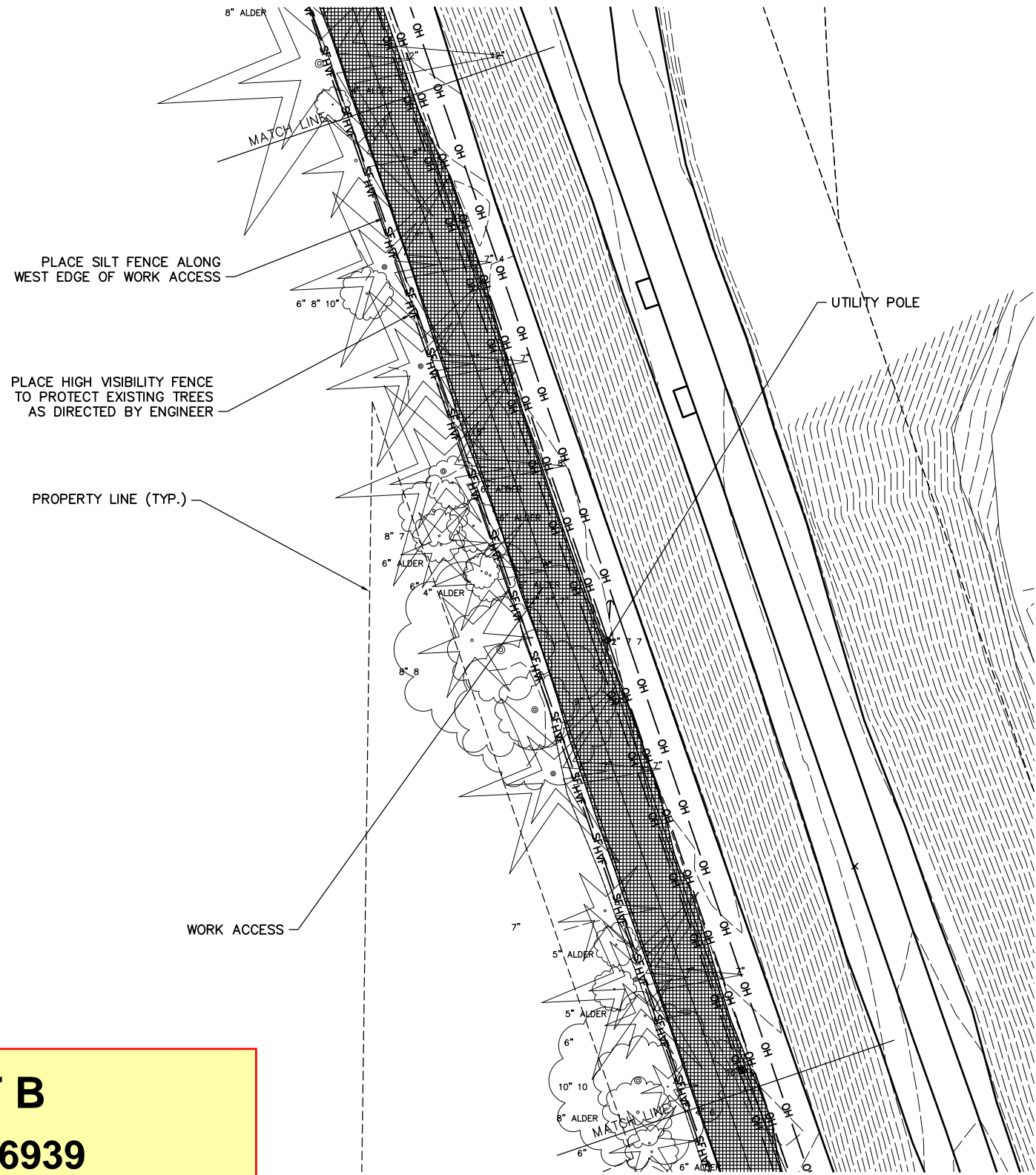

NOTES

THE ONLY CLEARING THAT IS ALLOWED IS FOR THE WORK ACCESS. CUT EXISTING VEGETATION TO SIX INCHES TALL AND THEN PLACE GEOTEXTILE ON CUT VEGETATION.

EXISTING TREES MAY HAVE LIMBS REMOVED TO PROVIDE CLEARANCE FOR WORK ACCESS.

DO NOT CUT TREE ROOTS.

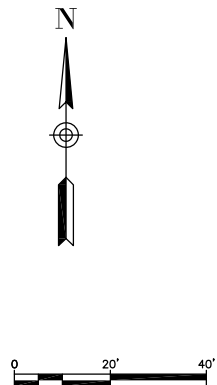

PLAN

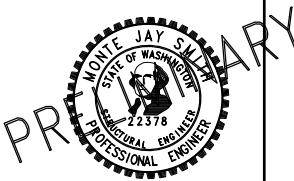

EXHIBIT B

ICN: 1-31-16939

LEASE #: AA-01-14398

Snohomish County Department of Conservation and Natural Resources/ Parks Division

Page 14 of 19

Last Saved By: montes Jun 02, 2021 -- 12:07pm			
REGION NO.	STATE	FED. AID PROJ. NO.	SURVEY NO.
10	WASH.	.	.
DESIGNED BY: MJS		DRAWN BY: MJS	
FIELD BOOK(S):		UPI#	
.		.	

SARGENT

Sargent Engineers, Inc.

320 Ronlee Lane NW • Olympia, WA 98502

Tel. 360 867-9284 • Fax 360 867-9318

SNOHOMISH COUNTY
DEPARTMENT OF
CONSERVATION AND
NATURAL RESOURCES
PARKS DIVISION

HALLER BRIDGE
PIER REPAIR
TEMPORARY EROSION AND
SEDIMENT CONTROL 3

REFERENCE SHEET NO.
.
SHEET 14 OF . SHEETS

SECTION 2, T. 31 N., R. 5 E. W.M.

NOTES

THE ONLY CLEARING THAT IS ALLOWED IS FOR THE WORK ACCESS. CUT EXISTING VEGETATION TO SIX INCHES TALL AND THEN PLACE GEOTEXTILE ON CUT VEGETATION.

EXISTING TREES MAY HAVE LIMBS REMOVED TO PROVIDE CLEARANCE FOR WORK ACCESS.

DO NOT CUT TREE ROOTS.

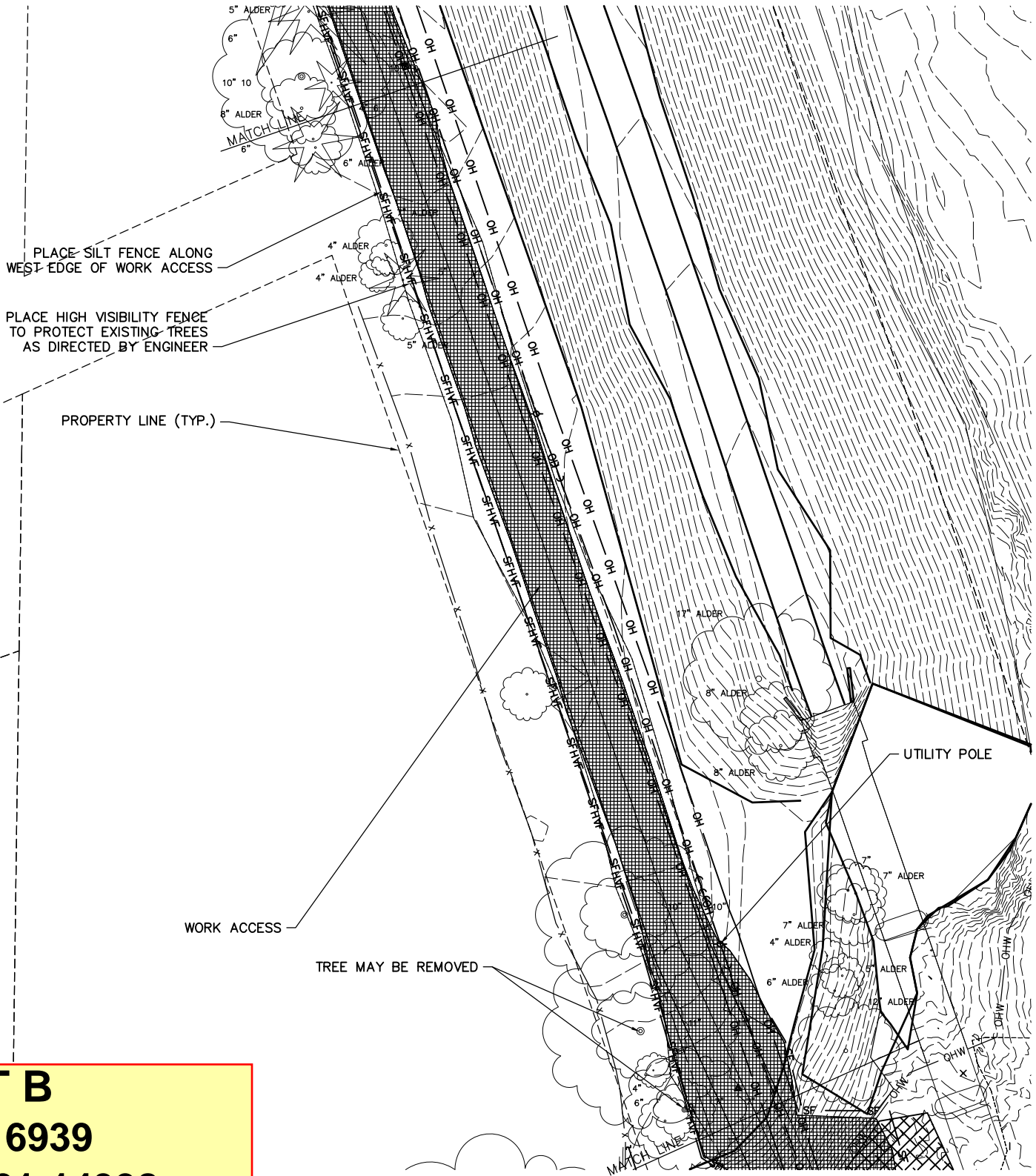
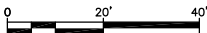

PLAN

EXHIBIT B

ICN: 1-31-16939

LEASE #: AA-01-14398

Snohomish County Department of
Conservation and Natural
Resources/ Parks Division

Page 15 of 19

Last Saved By: montes Jun 02, 2021 -- 12:07pm			
REGION NO.	STATE	FED. AID PROJ. NO.	SURVEY NO.
10	WASH.	.	.
DESIGNED BY: MJS		DRAWN BY: MJS	
FIELD BOOK(S):		UPI#	
.		.	

SARGENT

Sargent Engineers, Inc.

320 Ronlee Lane NW • Olympia, WA 98502

Tel. 360 867-9284 • Fax 360 867-9318

SNOHOMISH COUNTY
DEPARTMENT OF
CONSERVATION AND
NATURAL RESOURCES
PARKS DIVISION

HALLER BRIDGE
PIER REPAIR
TEMPORARY EROSION AND
SEDIMENT CONTROL 4

REFERENCE SHEET NO.
.
SHEET 15 OF SHEETS

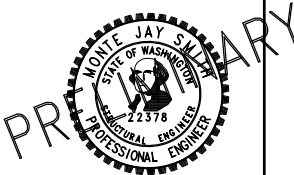

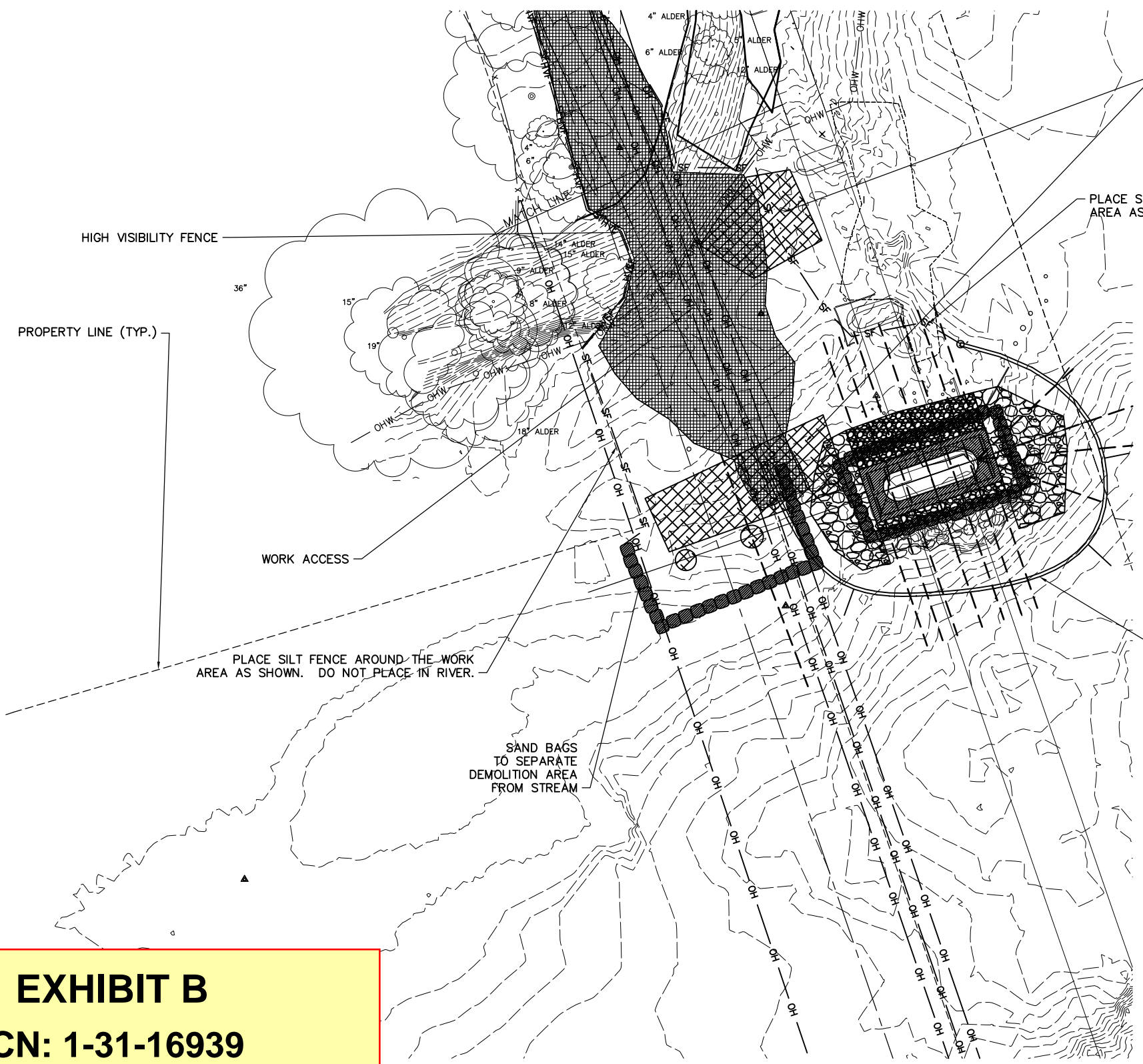
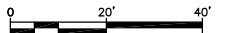
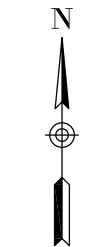

NOTES

- THE ONLY CLEARING THAT IS ALLOWED IS FOR THE WORK ACCESS. CUT EXISTING VEGETATION (EXCEPT KNOTWEED) TO SIX INCHES TALL.
- GEOTEXTILE SHALL BE PLACED UNDER ALL FILLS.
- EXISTING TREES MAY HAVE LIMBS REMOVED TO PROVIDE CLEARANCE FOR WORK ACCESS.
- DO NOT CUT TREE ROOTS.
- IF KNOTWEED IS IN THE AREA OF WORK, THE CONTRACTOR SHALL REMOVE ALL FLOWERING OR SEED HEAD FROM THE PLANT AND BAG THEM FOR DISPOSAL AT A MUNICIPAL WASTE SITE. THE STALK SHALL BE CUT TO THE GROUND AND ALL STEMS AND OTHER PORTIONS OF THE PLANT THAT ARE CUT DOWN SHALL BE BAGGED AND DISPOSED OF A MUNICIPAL WASTE SITE.
- THE CONTRACTOR SHALL SUBMIT FOR APPROVAL THEIR PLAN FOR SEPARATING THE DEMOLITION AREA FROM THE STREAM. THE SEPARATION HAS TO ISOLATE THE WORK AREA FROM THE STREAM. AFTER THE SEPARATION IS INSTALLED, ALL FISH NEED TO BE REMOVED FROM THE WORK AREA BEFORE WORK IS PERFORMED.
- ALL CONCRETE DEBRIS SHALL BE REMOVED FROM THE SITE. NO CONCRETE DEBRIS SHALL BE ALLOWED TO ENTER THE STREAM.
- NO CONCRETE SAWING OR GRINDING IS ALLOWED UNLESS APPROVED BY THE ENGINEER AND A DUST CONTAINMENT PLAN IS APPROVED.

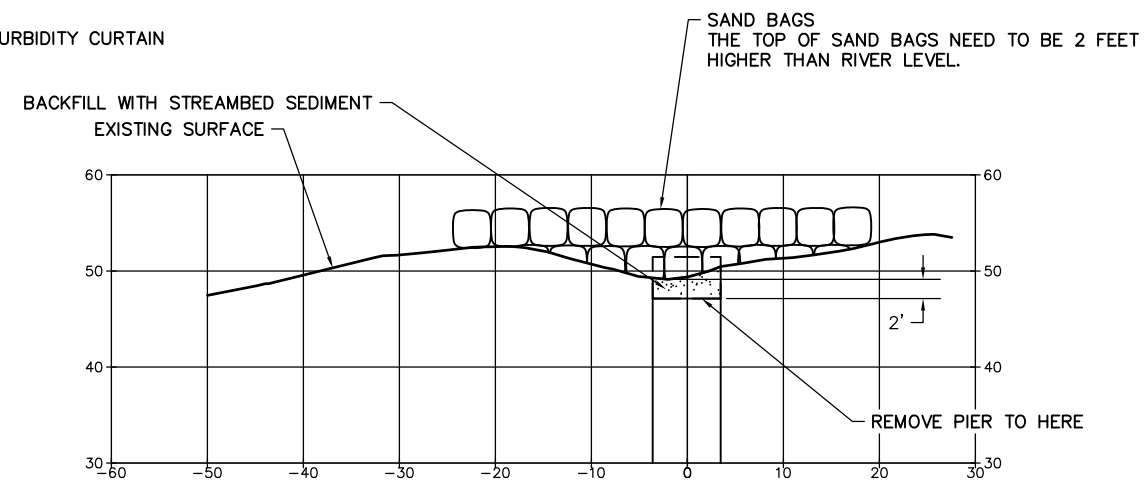

SECTION THROUGH PIER REMOVAL

PLAN

EXHIBIT B

ICN: 1-31-16939

LEASE #: AA-01-14398

Snohomish County Department of Conservation and Natural Resources/ Parks Division

Page 16 of 19

Last Saved By: montes Jun 02, 2021 -- 12:07pm			
REGION NO.	STATE	FED. AID PROJ. NO.	SURVEY NO.
10	WASH.	.	.
DESIGNED BY: MJS		DRAWN BY: MJS	
FIELD BOOK(S):		UPI#	
BY			

SARGENT

Sargent Engineers, Inc.

320 Ronlee Lane NW • Olympia, WA 98502

Tel. 360 867-9284 • Fax 360 867-9318

SNOHOMISH COUNTY
DEPARTMENT OF
CONSERVATION AND
NATURAL RESOURCES
PARKS DIVISION

HALLER BRIDGE
PIER REPAIR
TEMPORARY EROSION AND
SEDIMENT CONTROL 5

REFERENCE SHEET NO.
.
SHEET 16 OF SHEETS

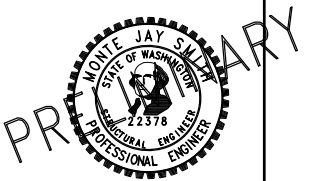



THE CONTRACTOR IS NOT ALLOWED TO PLACE ANY FRESH CONCRETE IN THE RIVER. ALL CONCRETE TOOLS AND EQUIPMENT SHALL BE CLEANED IN AN UPLAND AREA APPROVED BY THE ENGINEER. CONCRETE TRUCKS WILL NOT BE ALLOWED TO WASH OUT THEIR TRUCKS ON THE PROJECT SITE.



REFERENCE SHEET NO.	.
SHEET 17 OF . SHEETS	

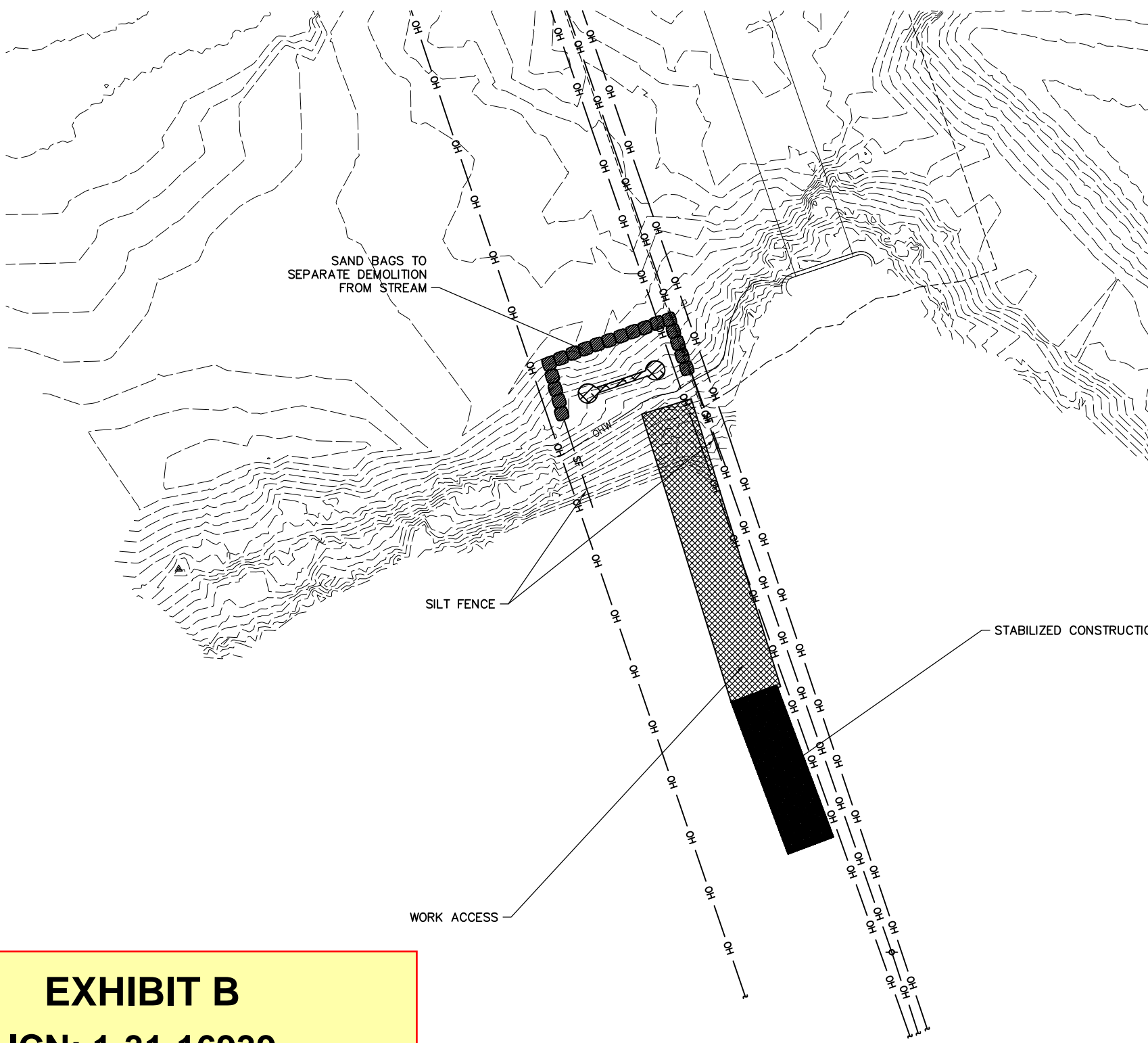

NOTES

- THE ONLY CLEARING THAT IS ALLOWED IS FOR THE WORK ACCESS. CUT EXISTING VEGETATION TO SIX INCHES TALL AND THEN PLACE GEOTEXTILE BELOW WORK ACCESS.
- EXISTING TREES MAY HAVE LIMBS REMOVED TO PROVIDE CLEARANCE FOR WORK ACCESS.
- DO NOT CUT TREE ROOTS.
- THE CONTRACTOR SHALL SUBMIT FOR APPROVAL THEIR PLAN FOR SEPARATING THE DEMOLITION AREA FROM THE STREAM. THE SEPARATION HAS TO ISOLATE THE WORK AREA FROM THE STREAM. AFTER THE SEPARATION IS INSTALLED, ALL FISH NEED TO BE REMOVED FROM THE WORK AREA BEFORE WORK IS PERFORMED.
- ALL CONCRETE DEBRIS SHALL BE REMOVED FROM THE SITE. NO CONCRETE DEBRIS SHALL BE ALLOWED TO ENTER THE STREAM.
- NO CONCRETE SAWING OR GRINDING IS ALLOWED UNLESS APPROVED BY THE ENGINEER AND A DUST CONTAINMENT PLAN IS APPROVED.
- NO TREES WITH A TRUNK DIAMETER LARGER THAN 4" SHALL BE REMOVED.

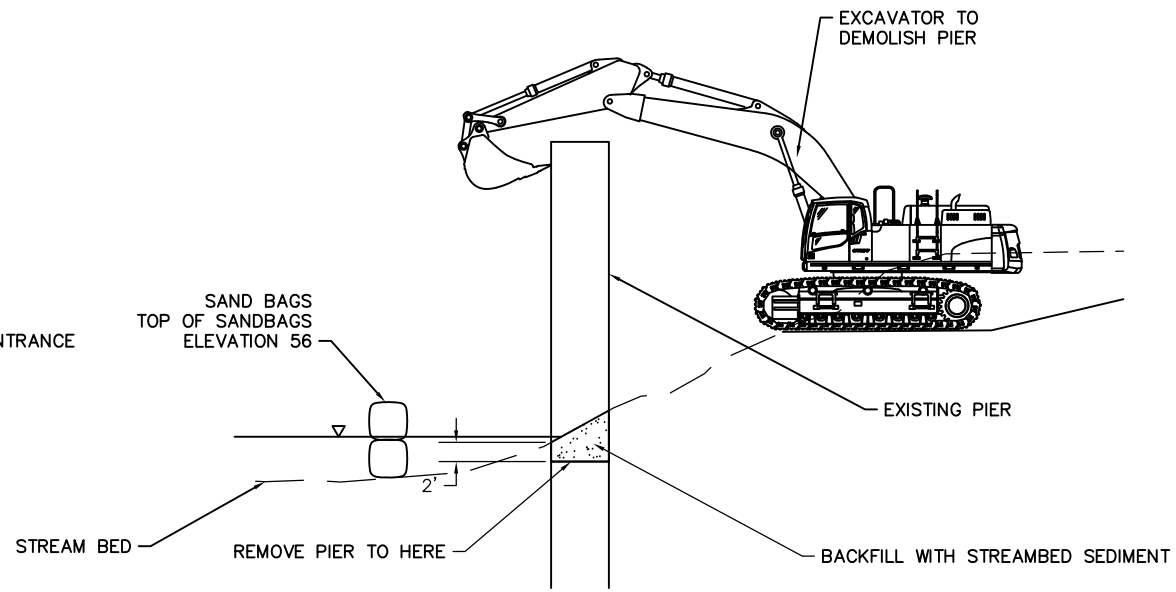
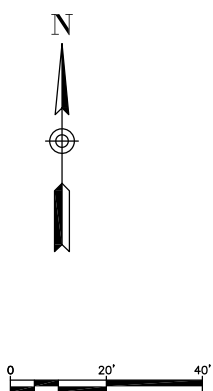

PLAN

EXHIBIT B

ICN: 1-31-16939

LEASE #: AA-01-14398

Snohomish County Department of Conservation and Natural Resources/ Parks Division

Page 18 of 19

Last Saved By: montes Jun 02, 2021 -- 12:07pm			
REGION NO.	STATE	FED. AID PROJ. NO.	SURVEY NO.
10	WASH.	.	.
DESIGNED BY: MJS		DRAWN BY: MJS	
FIELD BOOK(S):		UPI#	
BY			

SARGENT

Sargent Engineers, Inc.

320 Ronlee Lane NW • Olympia, WA 98502

Tel. 360 867-9284 • Fax 360 867-9318

SNOHOMISH COUNTY
DEPARTMENT OF
CONSERVATION AND
NATURAL RESOURCES
PARKS DIVISION

HALLER BRIDGE
PIER REPAIR
TEMPORARY EROSION AND
SEDIMENT CONTROL 7

REFERENCE SHEET NO.
.
SHEET 18 OF SHEETS

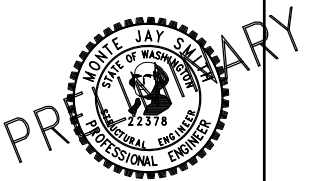

SECTION 2, T. 31 N., R. 5 E. W.M.

NOTES

SEEDING AND MULCHING SHALL COMPLY WITH SECTION 8-02 OF THE STANDARD SPECIFICATIONS.

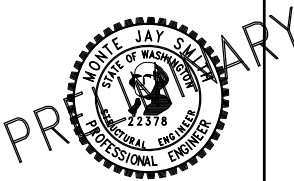
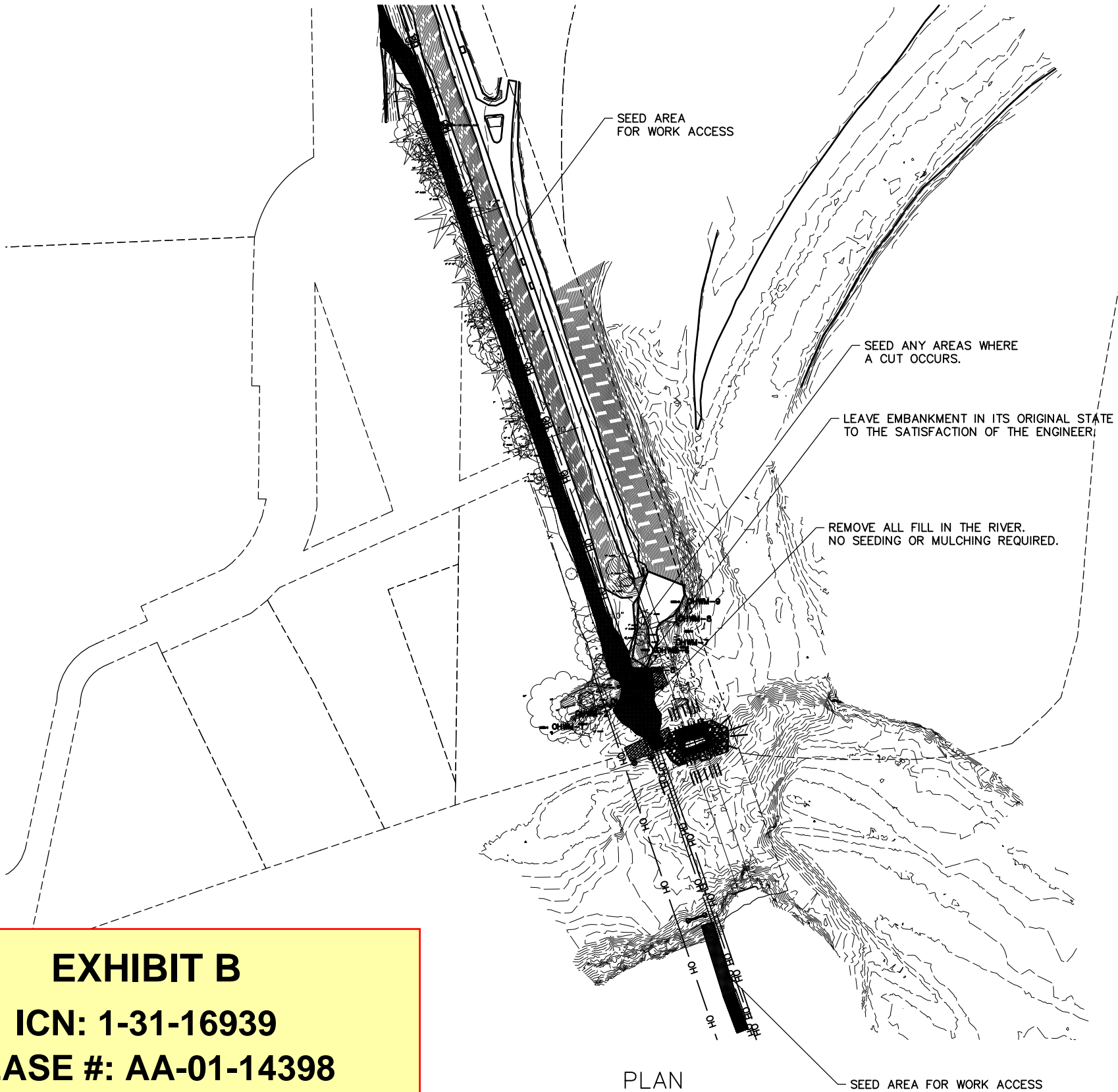
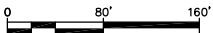

EXHIBIT B

ICN: 1-31-16939

LEASE #: AA-01-14398

Snohomish County Department of Conservation and Natural Resources/ Parks Division

Page 19 of 19

Last Saved By: montes Jun 02, 2021 - 12:07pm			
REGION NO.	STATE	FED. AID PROJ. NO.	SURVEY NO.
10	WASH.	.	.
DESIGNED BY: MJS		DRAWN BY: MJS	
FIELD BOOK(S):		UPI#	
BY			

SARGENT

Sargent Engineers, Inc.

320 Ronlee Lane NW • Olympia, WA 98502

Tel. 360 867-9284 • Fax 360 867-9318

SNOHOMISH COUNTY
DEPARTMENT OF
CONSERVATION AND
NATURAL RESOURCES
PARKS DIVISION

HALLER BRIDGE
PIER REPAIR

REVEGETATION PLAN

REFERENCE SHEET NO.
.
SHEET 19 OF SHEETS