

**Return Address:**  
**Public Works MS 607**  
3000 Rockefeller Ave MS 607  
Everett, WA 98201

## CRITICAL AREA SITE PLAN

Applicant/Project Proponent: **Snohomish County Public Works** PAGE 1 OF 2  
Project Name and #: **Swanson Road Bridge #80 Replacement (RC1105)**  
Site Address: **MP 1.78, 208<sup>th</sup> St NE, Arlington**  
Tax Acct #: **31060900302500**

This Critical Area Site Plan is recorded to provide permanent protection for critical areas to comply with mitigation measures identified in the March 2007 *Swanson Road Bridge #80 Replacement Critical Area Study* prepared by Public Works. This completes compliance with Chapter 30.62A SCC for the Snohomish County Road Improvement Plans for Swanson Road Realignment/Bridge #80 Replacement Project RC 1105, as shown on the project right-of-way plans, filed with Snohomish County Public Works under Survey # 3741

REFERENCE NUMBER(S) OF RELATED DOCUMENTS:

GRANTOR(S): **Snohomish County**

GRANTEE(S): **The Public**

### Legal Description:

Section 09 Township 31 Range 06 Quarter SW - TH PTN OF PAR "A" DAF BEG AT NW COR OF SD PAR "A" AT A PT OPP CO ENG STA (HEREINAFTER REFERRED TO AS CES) 10+63.61 & 20FT R THRFR PER SNO CO RDIMPROV PLANS FOR SWANSON RD REALIGNMENT/BRIDGE #80 REPLACEMENT PROJ SURV NO 3471 TH S00 58 57 W ALG W BDY LN OF SD PAR A DIST OF 100FT TO A PT OPP CES 11+13.00 & 102.73FT R THRFR TH S89 01 03E A DIST OF 300FT TO A PT OPP CES 13+56.17 & 61.19FT R THRFR TH S00 58 57W A DIS5T OF 162.68FT TO A PT OPP CES 13+25.22 & 220.33FT R THRFR TH S89 01 03E A DIST OF 521.81FT TO A LN BEING 60FT WLY OF & PLW WLN OF LOT 2 SP NO SP174 (7-75) REC AFN 2402020 BEING OPP CES 18+32.52 & 329.22FT R THRFR TH N01 41 09E ALG SD LN A DIST OF 296.42FT TO A PT OPP CES 18+98.74 & 40FT R THRFR TH ELY ALG A 560FT RAD CRVWTH A C/A OF 6 12 34& ARC DIST OF 60.69FT TO A PT OPP CES 19+63.76 & 40FT R THRFR TH N01 41 09E A DIST OF 13.38FT TO A PT OPP CES 19+65.09 & 26.68FT R THRFR TH N87 25 55W A DIST OF 184.71FT TH N84 2055W A DIST OF 6.24FT TH N87 55 01W A DIST OF 166.21FT TH S59 43 05W A DIST OF 215.54FT TH S83 43 05W A DIST OF 238.02FT TH N53 19 55W A DIST OF 133.37FT TO POB - PAR "A" SW1/4 SW1/4 LESS N 335FT OFE 340FT THOF & ALSO EXC N 15FT THOF & ALSO EXC BEG AT NW COR OF SW1/4 SW1/4 OF SD SEC 9 TH S ALG W LN OF SD SEC 9 TO N LN OF CO RD R/W AS IT NOW EXISTS TH SLY ELY & NLY ALG SD CO RD R/W AS DESC INDEED REC AFN 651002 VOL 287 PG 317 TO S LN OF TH CO RD R/W DESC IN DEED REC AFN 187327 VOL 149 PG 161 TH W & PLT N LN OF SW1/4 SW1/4 TO W LN OF SD SW1/4 SW1/4 TH S TO PLACE OF BEG & ALSO EXC TH PTNCONVYD TO SNO CO FOR RD AFN 651002 REC VOL 287 PG 317 - PER SCC NO 02-2-06346-1 FILED 3-2-05

### Notes:

1. Mitigation areas and associated maintenance activities to improve wetland, stream and buffer functions exist on this parcel. Future restoration or mitigation measures are permitted including unavoidable temporary disturbance to soils and vegetation to achieve improvement of ecological functions.
2. The restrictions imposed by this Critical Area Site Plan do not supersede or otherwise diminish previously established easements, conveyances, or other legally established uses.
3. The following activities are restricted: (a) construction of new structures; (b) removal of existing native vegetation; and (c) other development activities that would adversely affect the functions and values of the critical areas and buffers. Habitat enhancement in wetland(s), fish and wildlife habitat conservation area(s) and buffers are allowed. Representations on this site plan may be approximations only and should not be used for purposes other than for determining general locations of critical areas and buffers. Development activities beyond the scope of this plan may require additional studies and regulatory approvals, including compensatory mitigation.

Site Plan

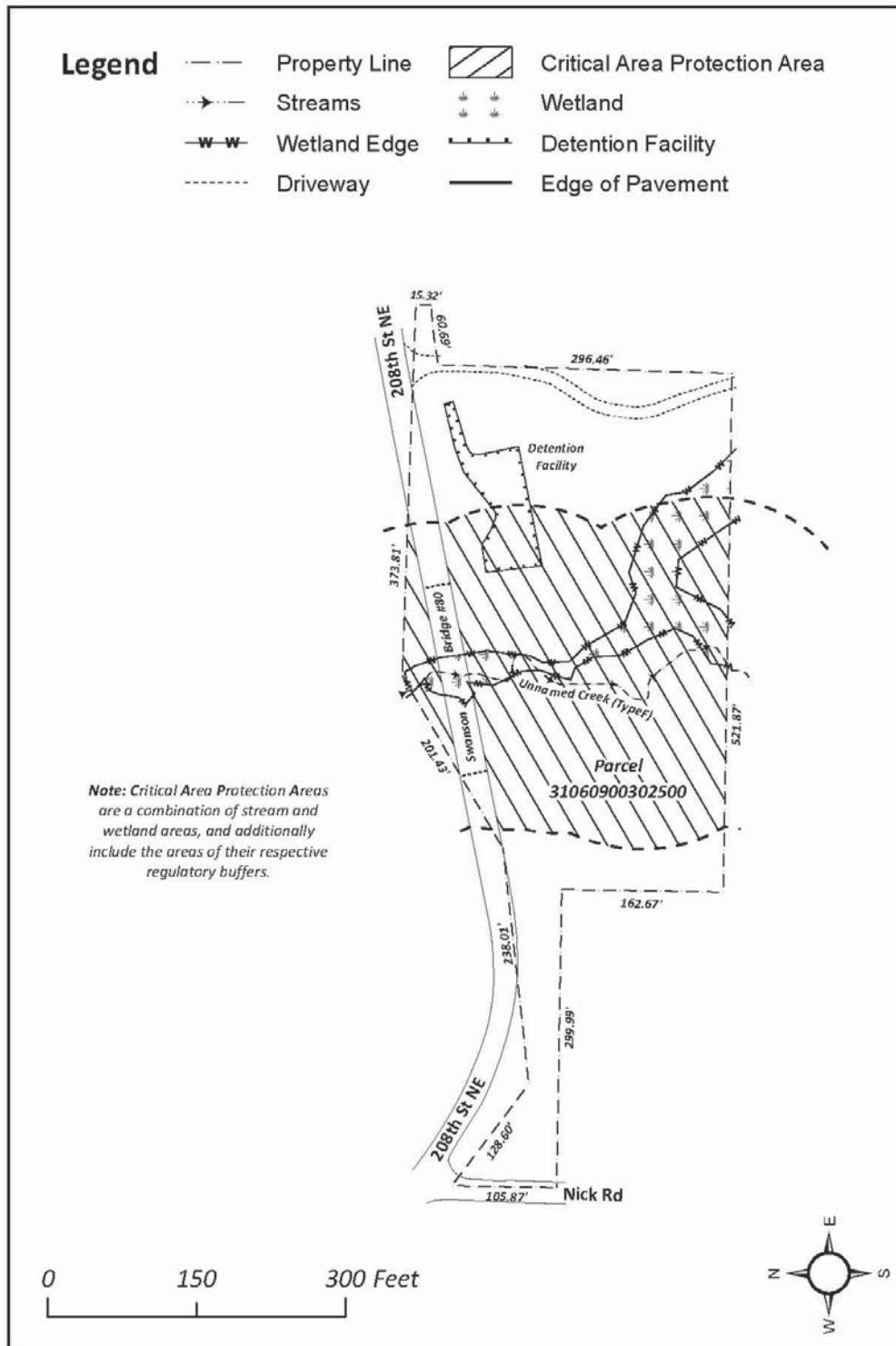

Douglas W McCormick Digitally signed by Douglas W McCormick  
Date: 2022.09.28 10:26:13 -07'00'

**APPROVED** as compliant with Chapter  
 30.62A SCC  
 Snohomish County Public Works  
 Douglas W. McCormick, County Engineer  
 Date: 9/28/2022

Klein, Kenneth

Klein, Kenneth  
2022.12.16 12:56:26 -08'00'

**APPROVED**  
 Snohomish County Executive Ken Klein  
Executive Director

Date: 12/16/2022